



# Westwood Public Schools

## Hanlon-Deerfield Elementary School Building Project

Site + Outdoor Design  
Subcommittee

27 July 2021



# Agenda / Review Items

1. Play Fields
2. Fencing
3. Playground
4. Signage
5. Parking
6. Snow Plowing areas
7. Sidewalks
8. Entry Plaza
9. Trees, shrubs, plantings
10. Irrigation



# Overall Site Plan Review

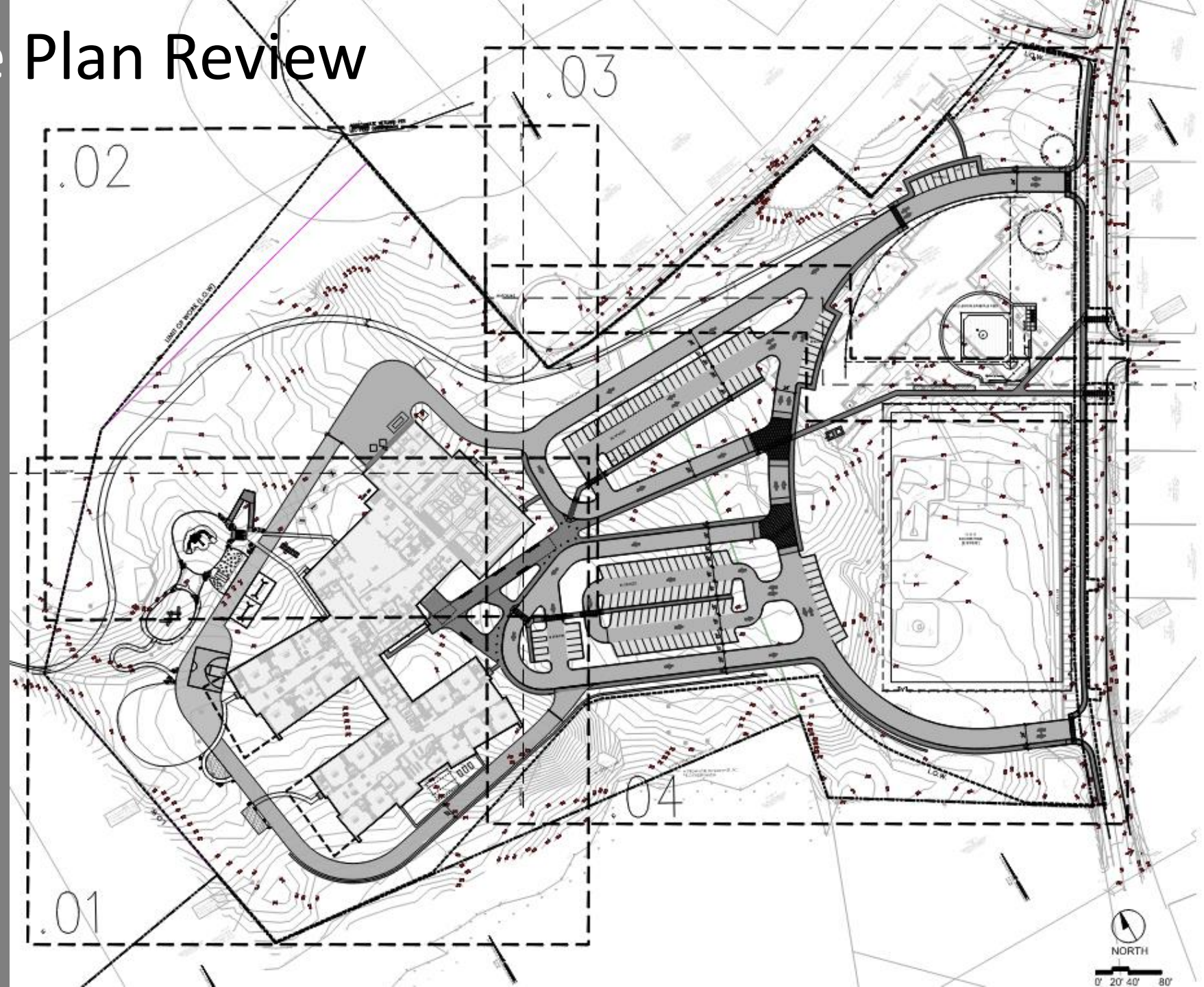

# North Entry and LL Baseball Field

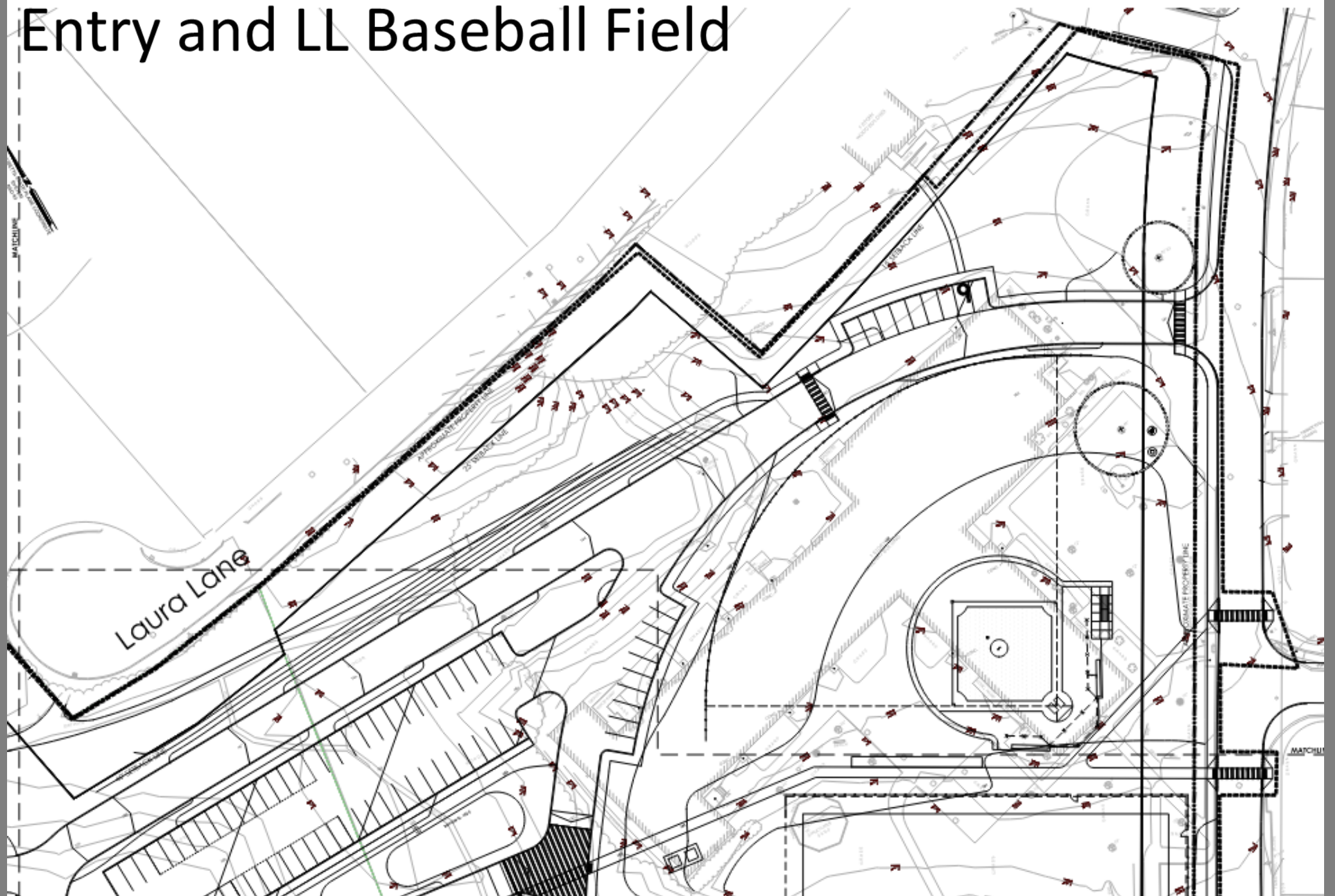



# North Entry and LL Baseball Field

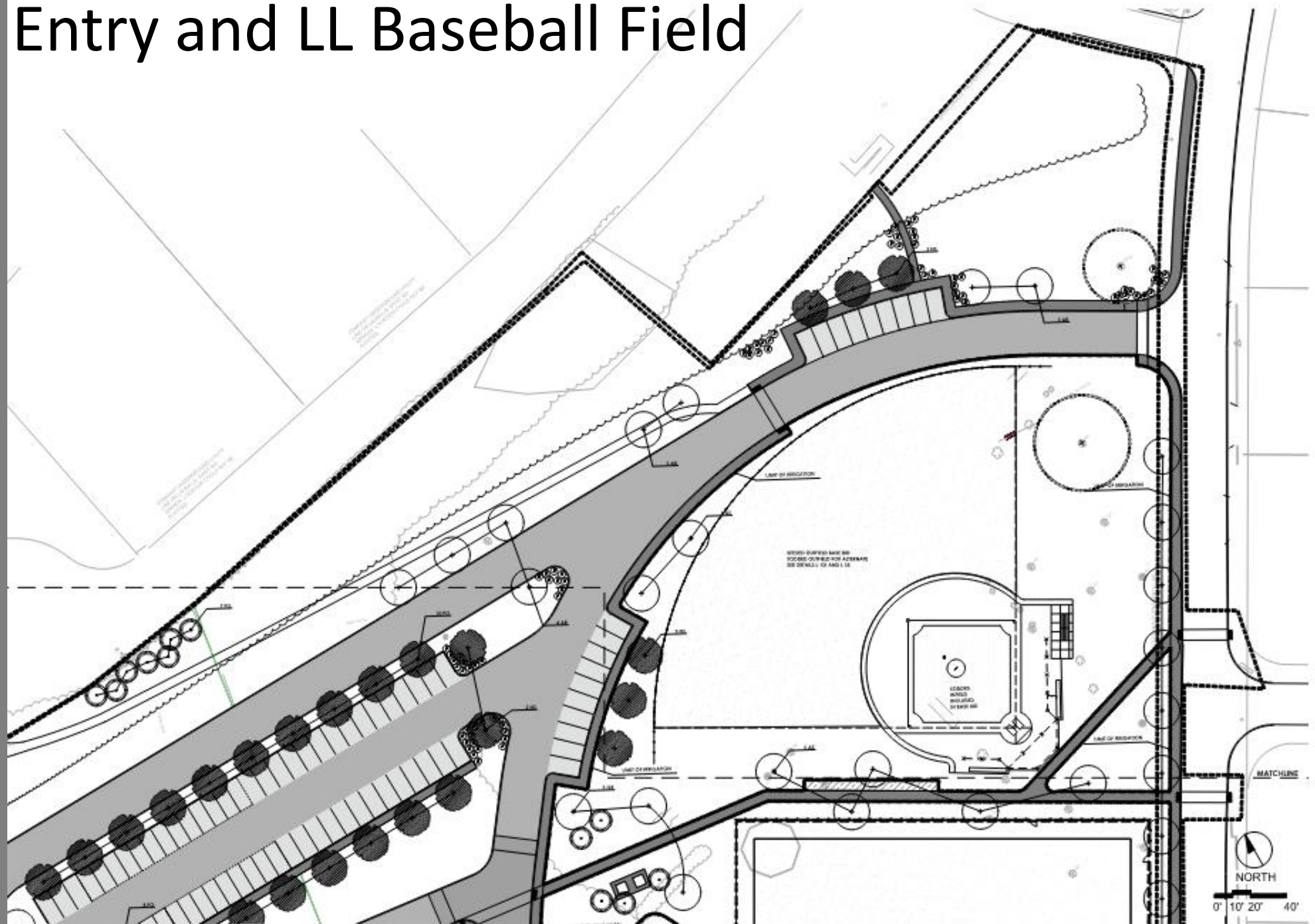

[illegible]



# South Entry and Soccer Field

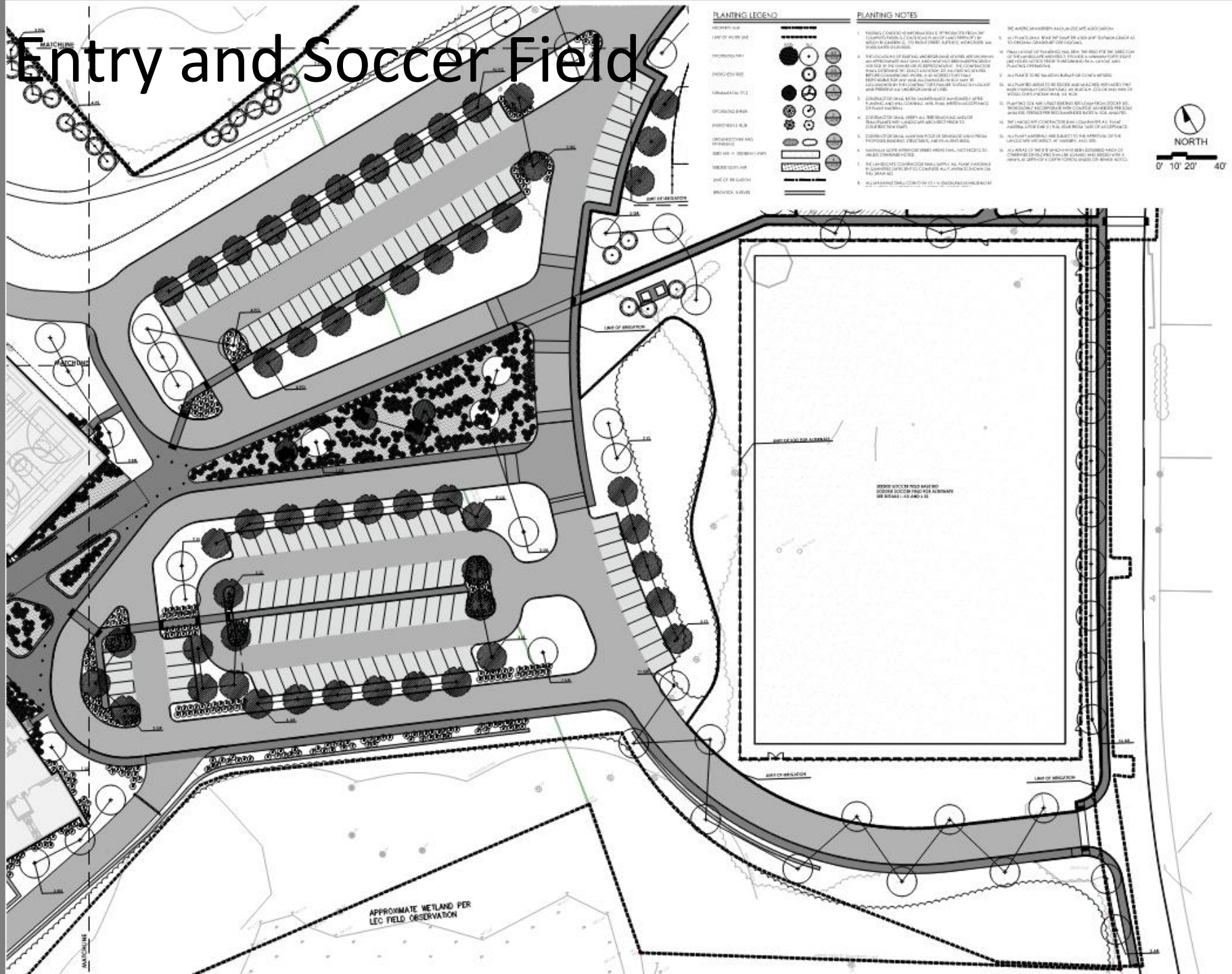



# Playground Concept Review

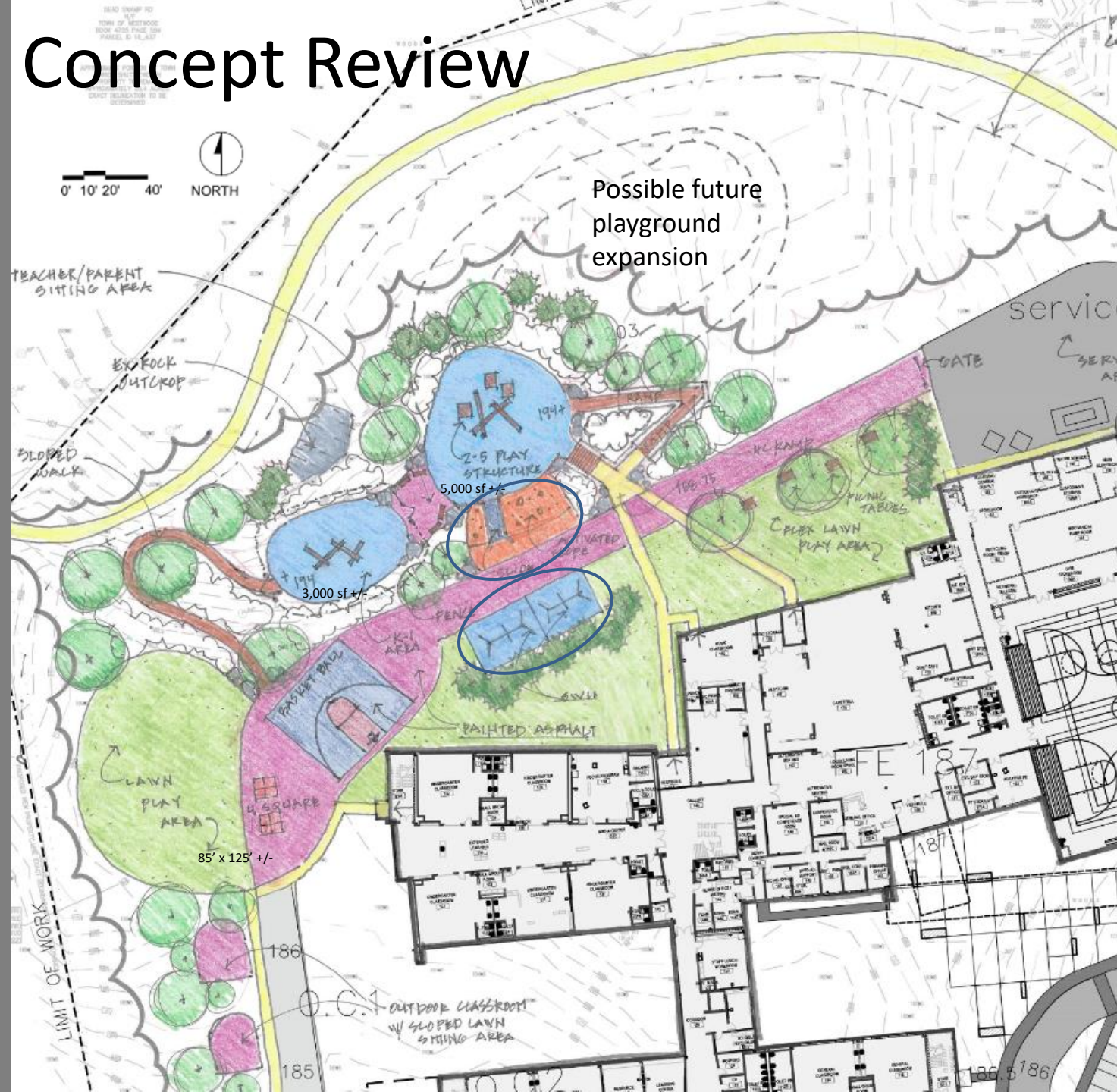

Slide, climbing wall and swings will be priced separately



# West and South of Building

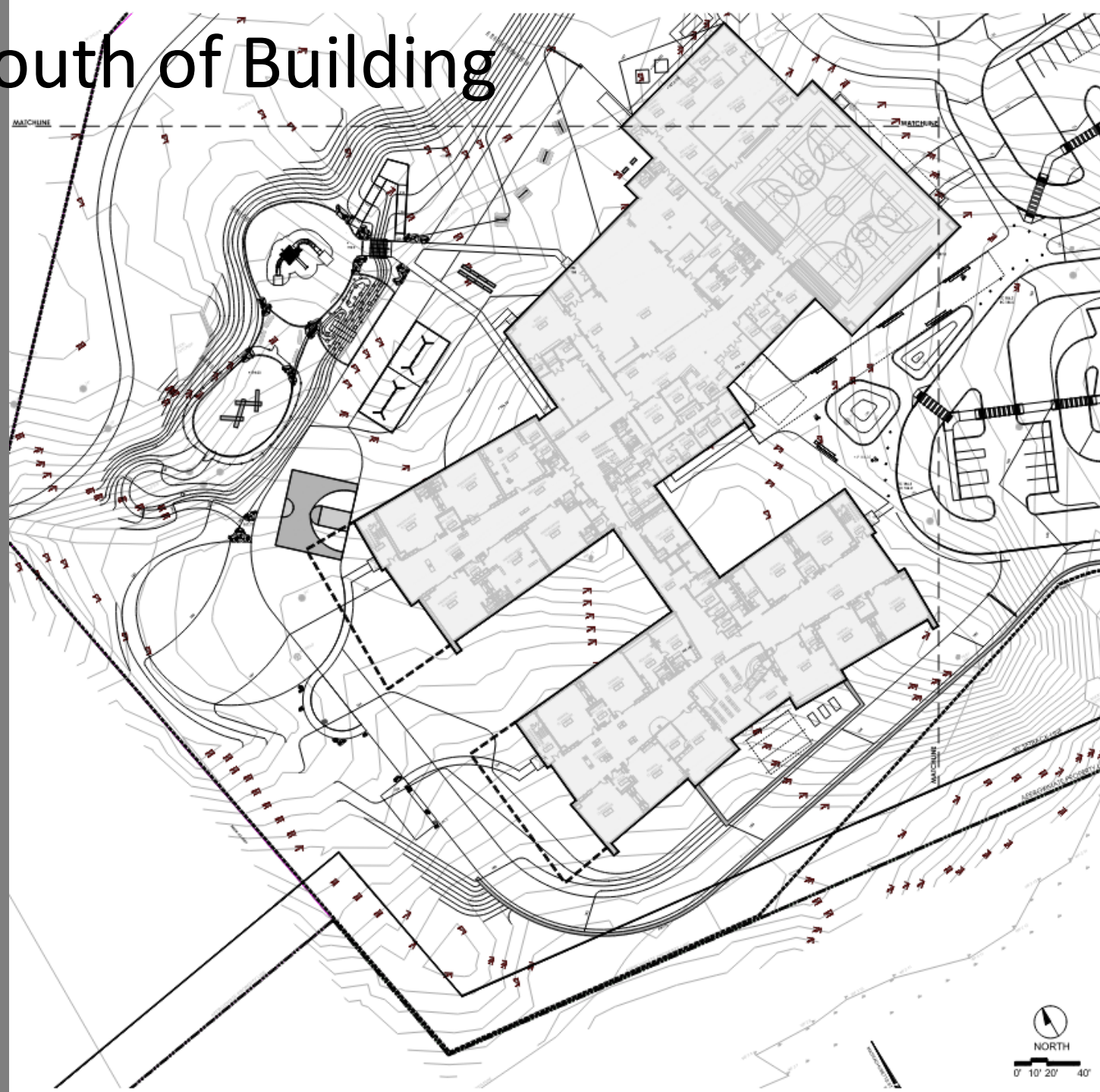

# South of Building

[illegible]

A scale bar showing distances of 0', 10', 20', and 40'. To the right of the scale bar is a north arrow pointing towards the top right, with the word "NORTH" written below it.



# Entry Plaza





# North of Building





# North of Building

