

# Westwood Public Schools

Public Forum

December 9, 2019

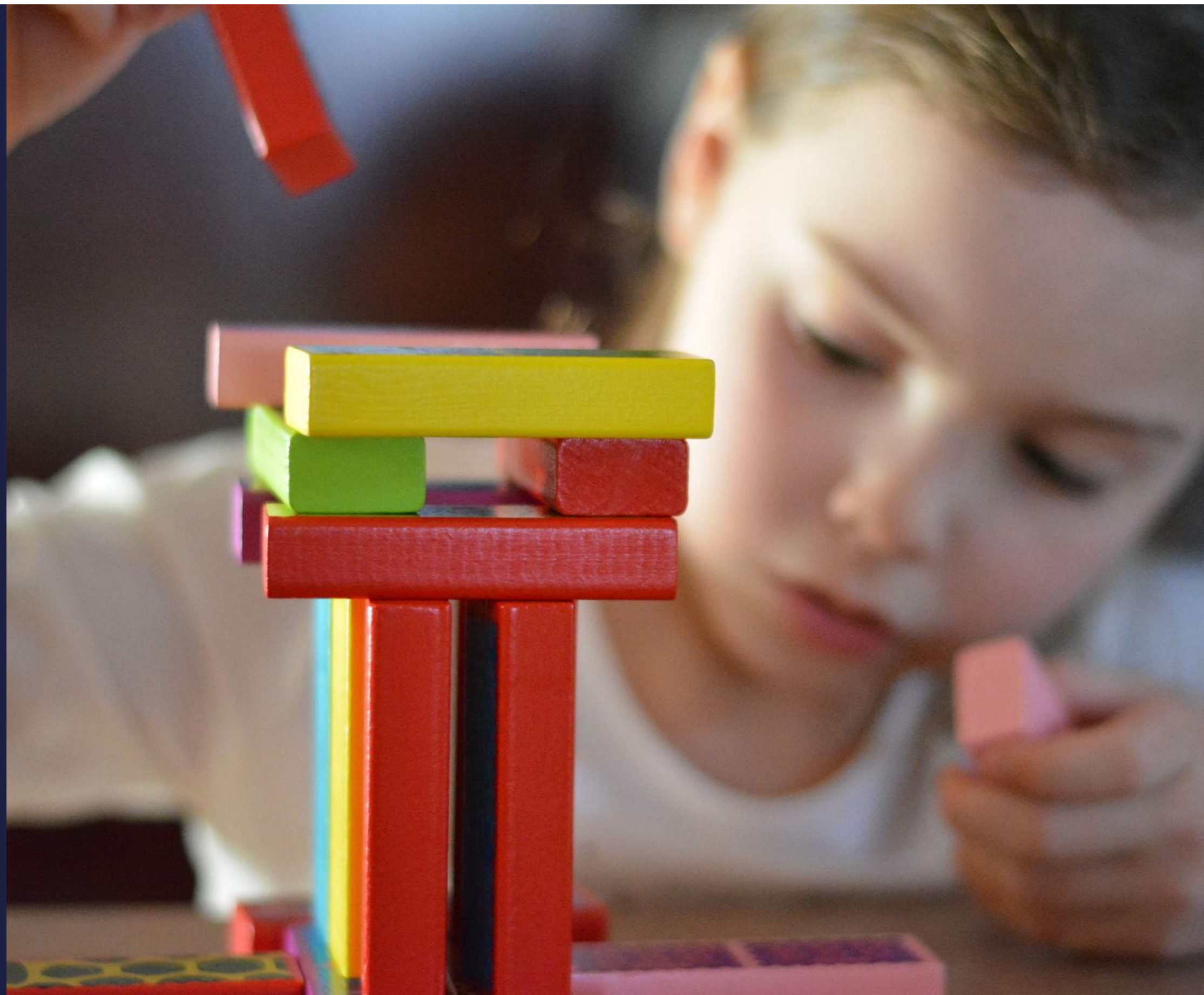

# Objectives

**Report out educational and facilities progress to date**

**Explore how education and facilities have changed**

# Agenda

**Introductions**

**Overview & Process**

**Early Programming Efforts**

- Principal Interviews
- Visioning Workshop
- Principals' Workshop

**Next Generation Educational Practices & Facilities**

**Educational Facilities Activity**

**Next Steps**

# School Building Project

## Where We're Going

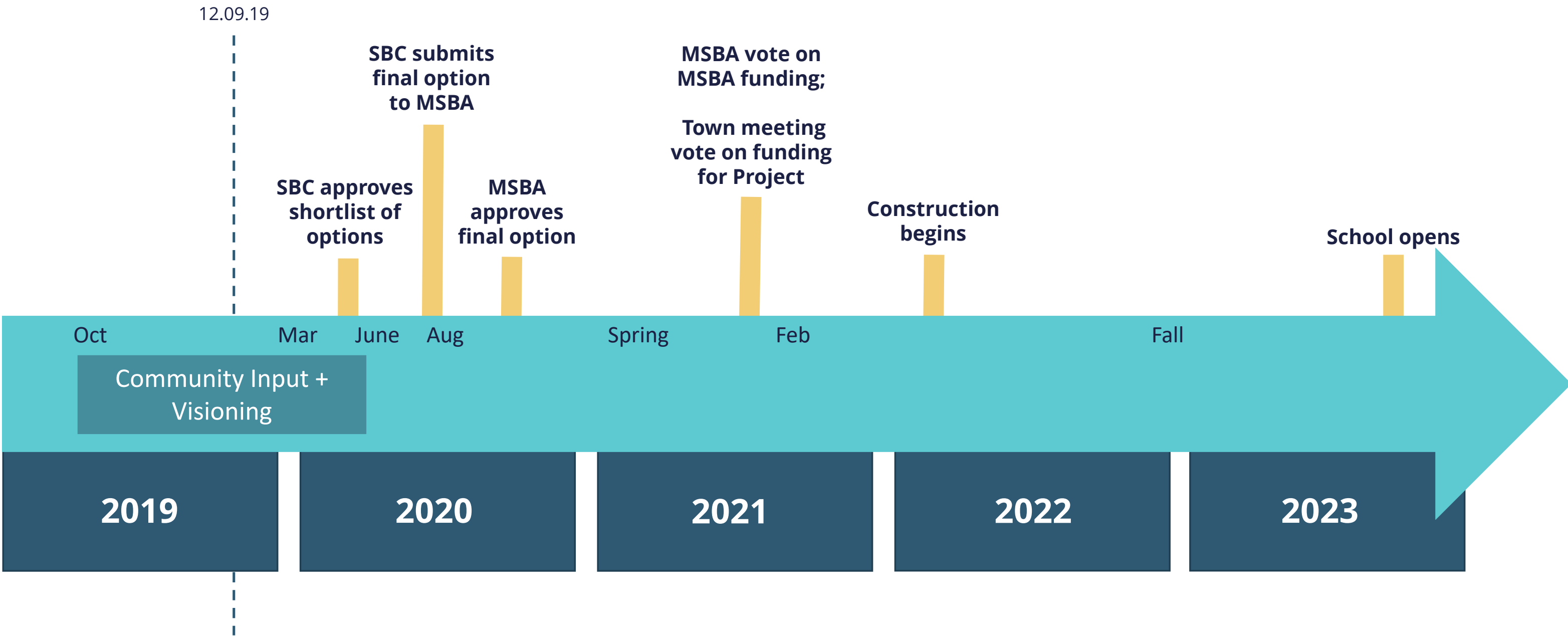



# Scenarios

## To Be Studied

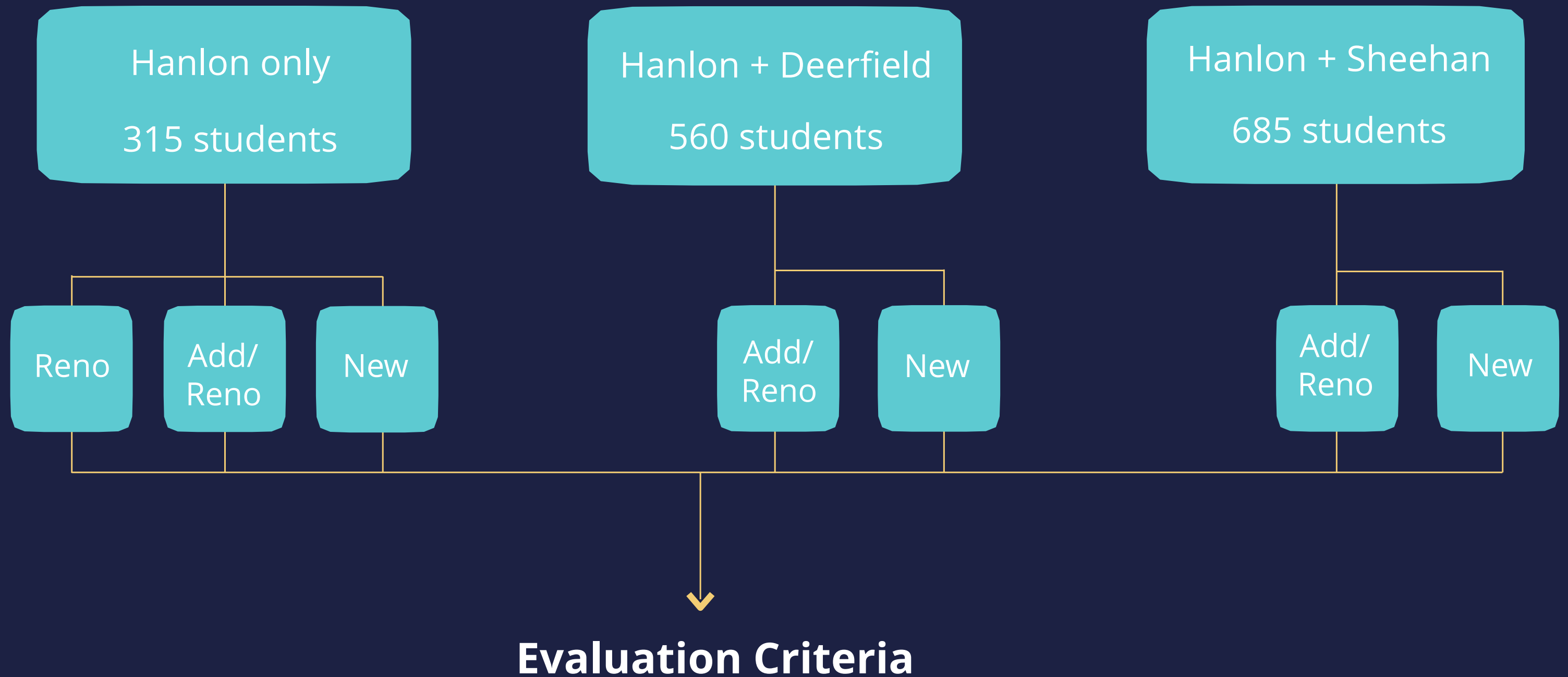

# MSBA Process

## Where We're Going

Nov 2019 – Mar 2020

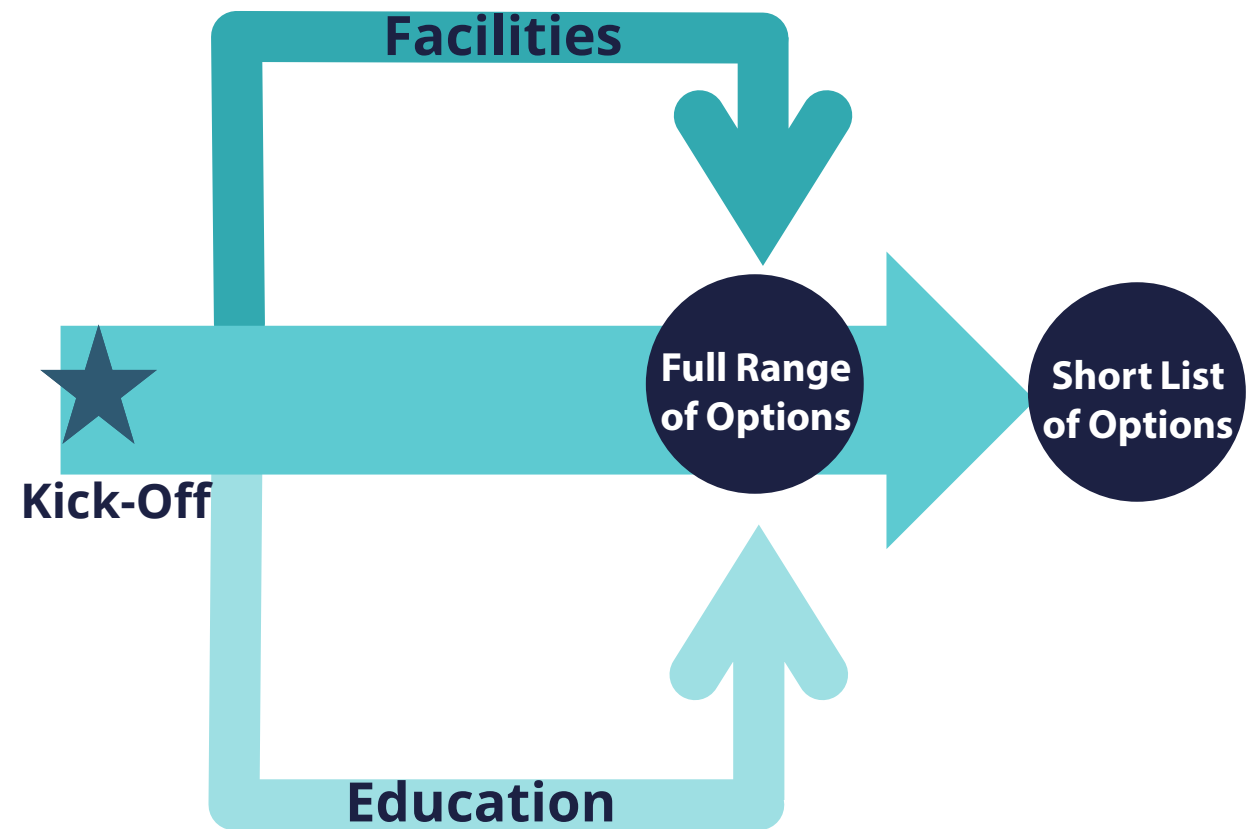

# MSBA Process

## Where We're Going

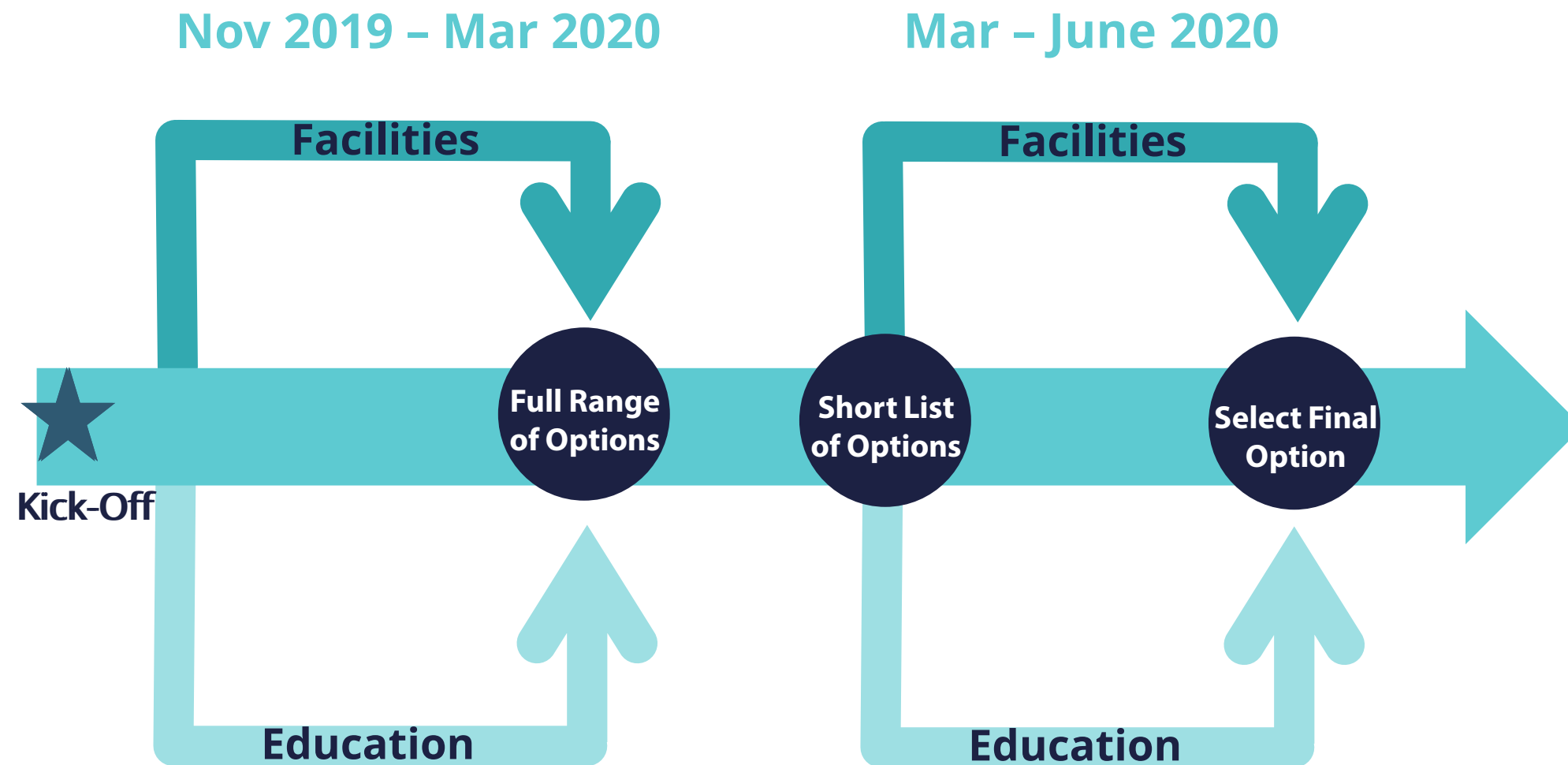

# Where We're Going

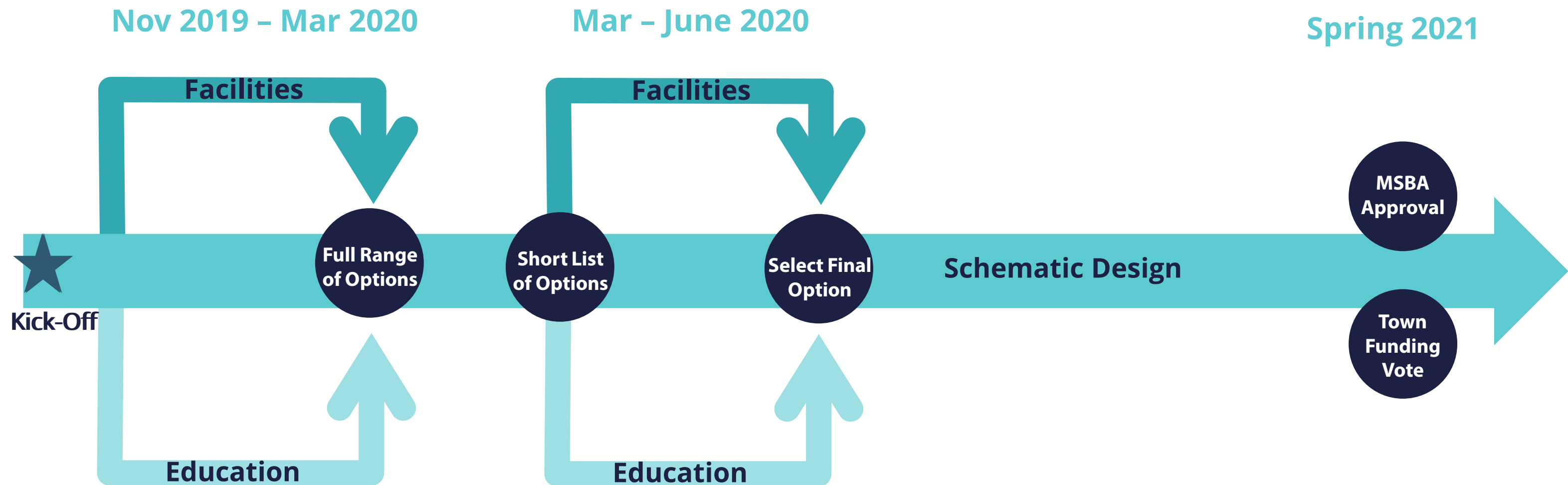

# Questions



# Programming

update

- **Principal Interviews & Educational Walk-thrus**
- **Faculty & Staff Visioning Workshop**
- **Principals' Workshop**

- **Principal Interviews & Educational Walk-thrus**
  - Intentional space for special education, student support services, and specials
  - Classrooms designed to allow multiple activities
  - Library expressed as learning stations at heart of school

- **Principal Interviews & Educational Walk-thrus**
  - Opportunities for sensory seeking and sensory avoidance more and more important
  - Maintaining relationships is important...students known well by adults...small school feel

- **Principal Interviews & Educational Walk-thrus**
  - Flexibility expressed as key feature:
    - Group size, activities, tools and resources, acoustical and visual experience
  - Wide variety of spaces...not a one size fits all model
    - Small group space, movement space, extended learning areas, etc.



- **Principal Interviews & Educational Walk-thrus**
  - Student play / exploration as key theme
  - Careful consideration of safety & security
  - Reimagine the student dining experience
  - Embrace the idea of student choice...of learning place, furniture, manipulatives, recess



- # Faculty & Staff Visioning

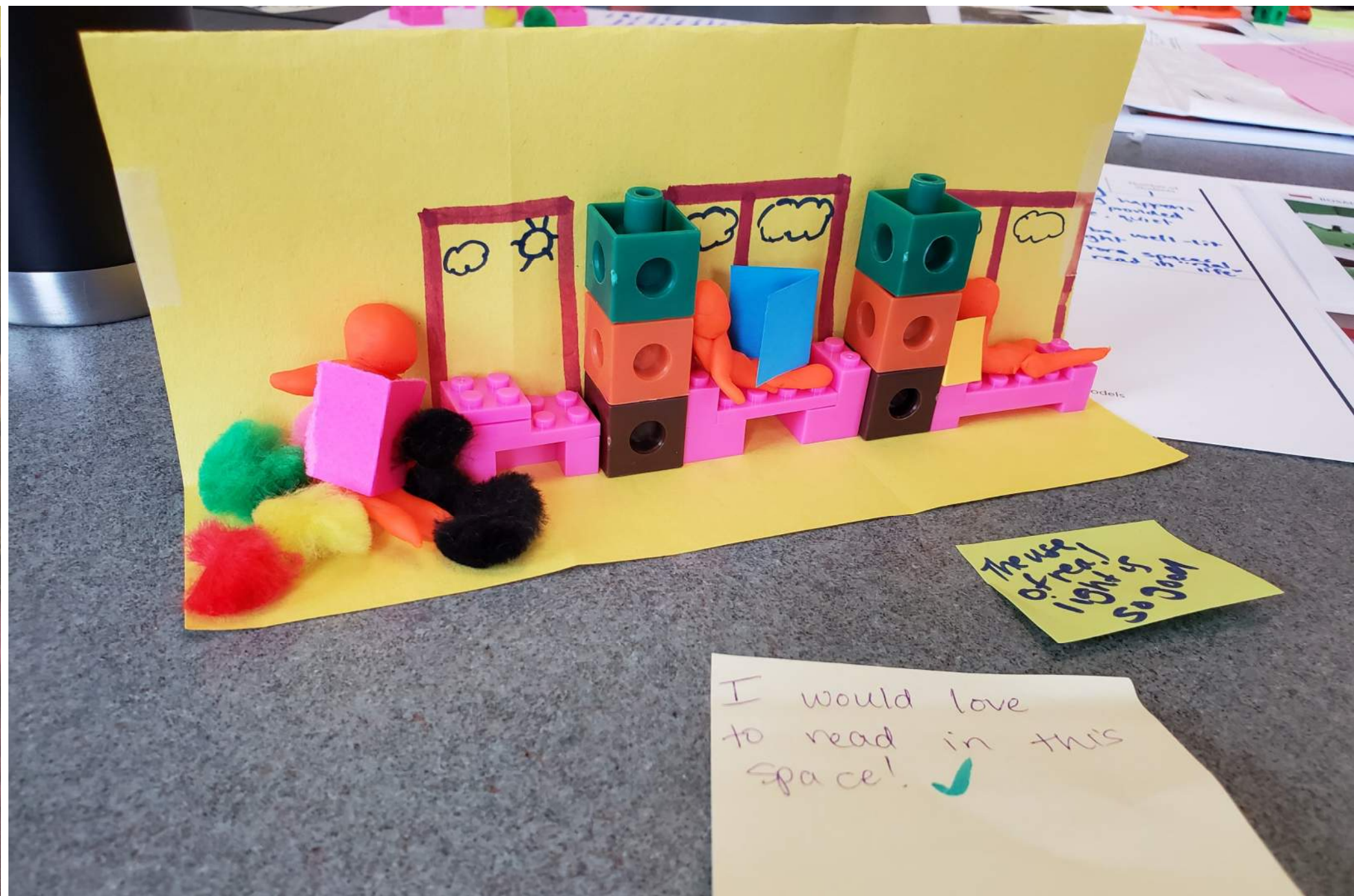



# • Faculty & Staff Visioning





- **Faculty & Staff Visioning**

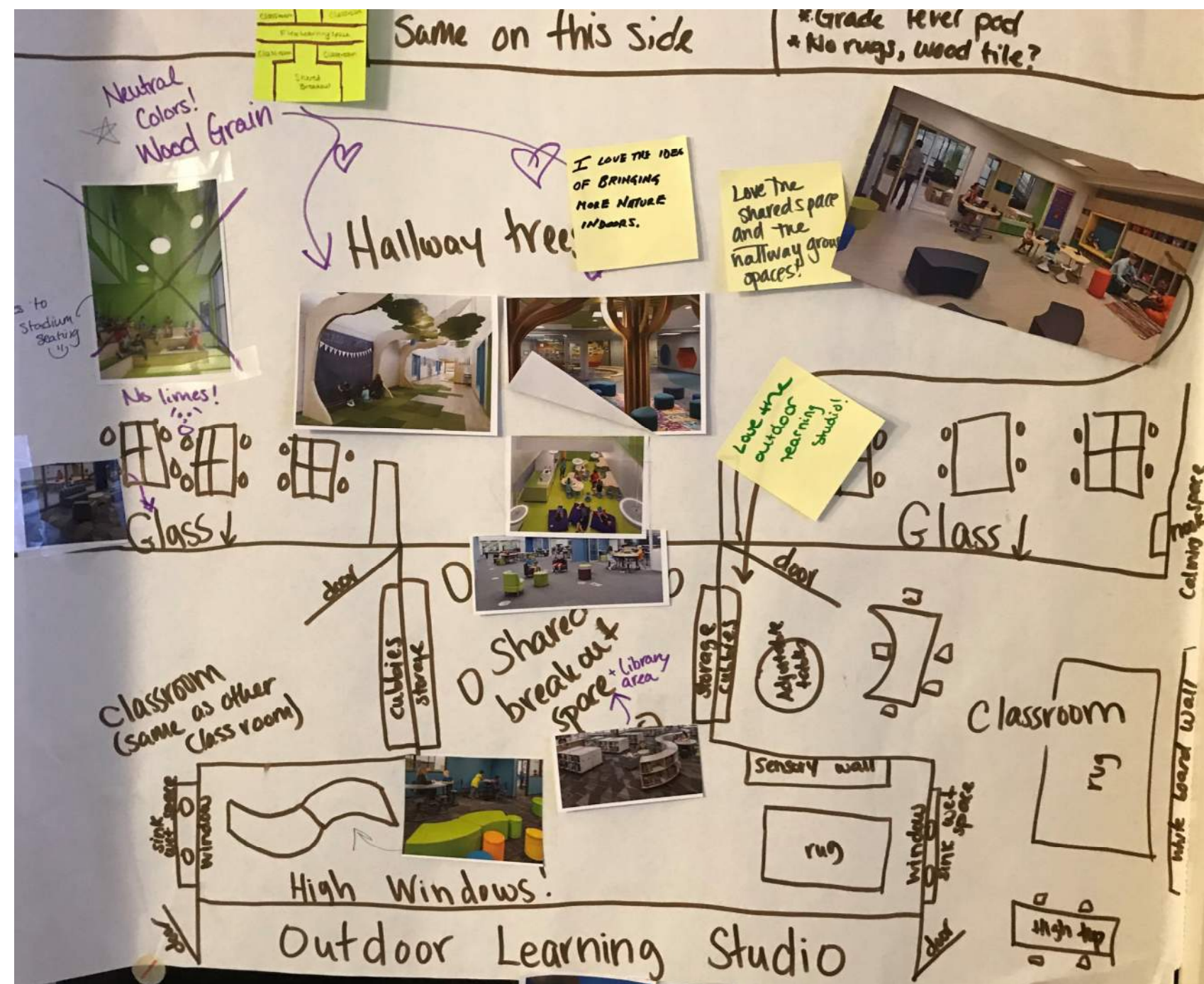
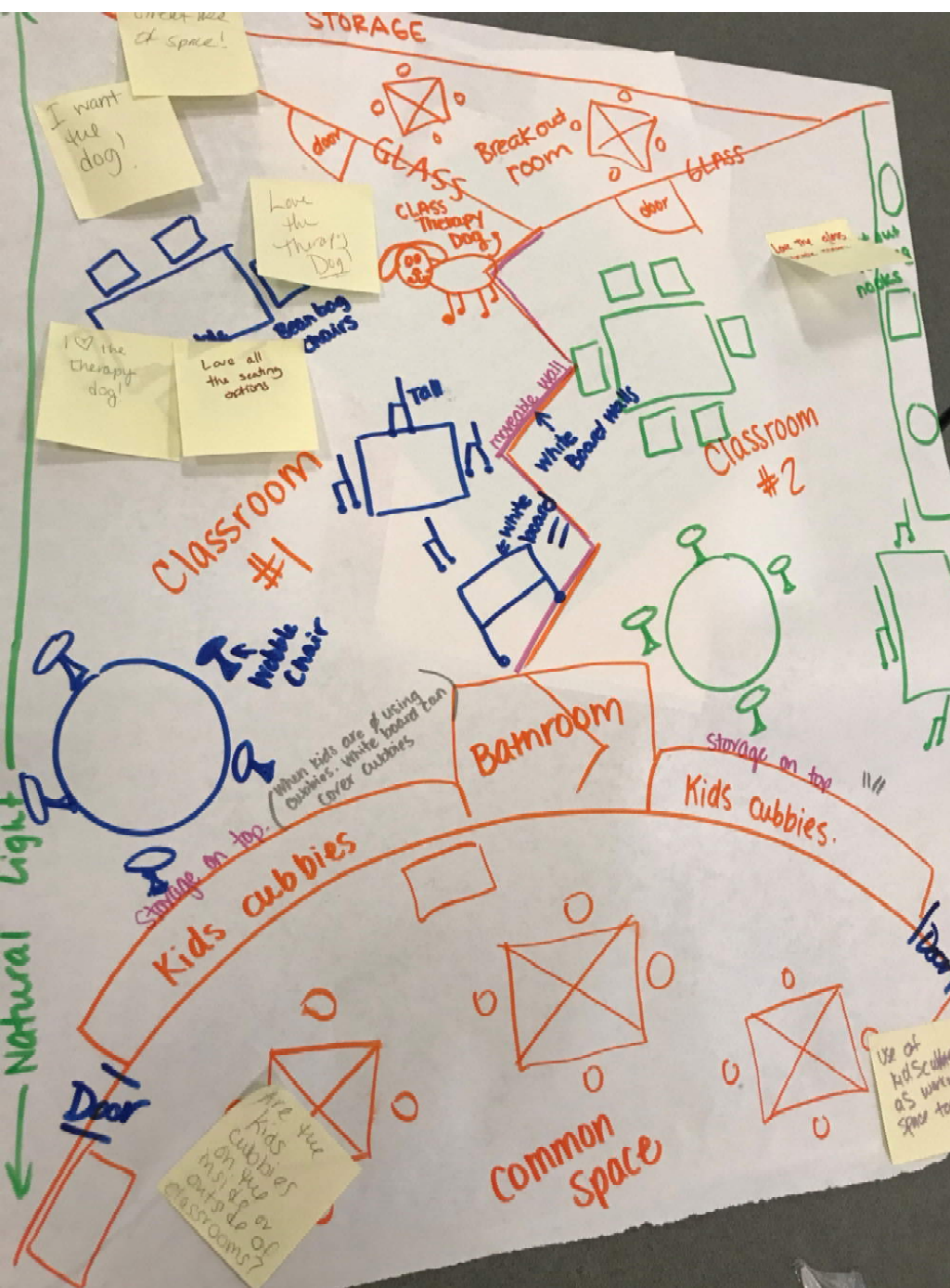

- **Faculty & Staff Visioning**
  - Classroom pairs with small group rooms between
  - Classrooms that support multiple activities
  - Flexibility at multiple levels (group size, access to technology, mobile furniture, etc)
  - Variety of space including breakout space
  - Opportunities to move & interact with learning environment (exploration & play ... a children's museum experience)
  - Intentionally designed special education space
  - Leverage the outdoors for learning



# Early Project Planning

- Hanlon Only (315 Students) = 3 Sections / Grade
- Hanlon / Deerfield (560 Students) = 5 Sections / Grade
- Hanlon / Sheehan (685 Students) = 6 Sections / Grade
- Special Education Programs
  - All current programs will continue
  - Some programs may be relocated and incorporated into project depending on the scenario
- Grade Level Clusters with breakout space
- Project zoned into public and private

# Questions

Next Generation

Educational

Experience of Students

# warm-up exercise

What has changed?

What's your definition of learning?

EN L'AN 2000

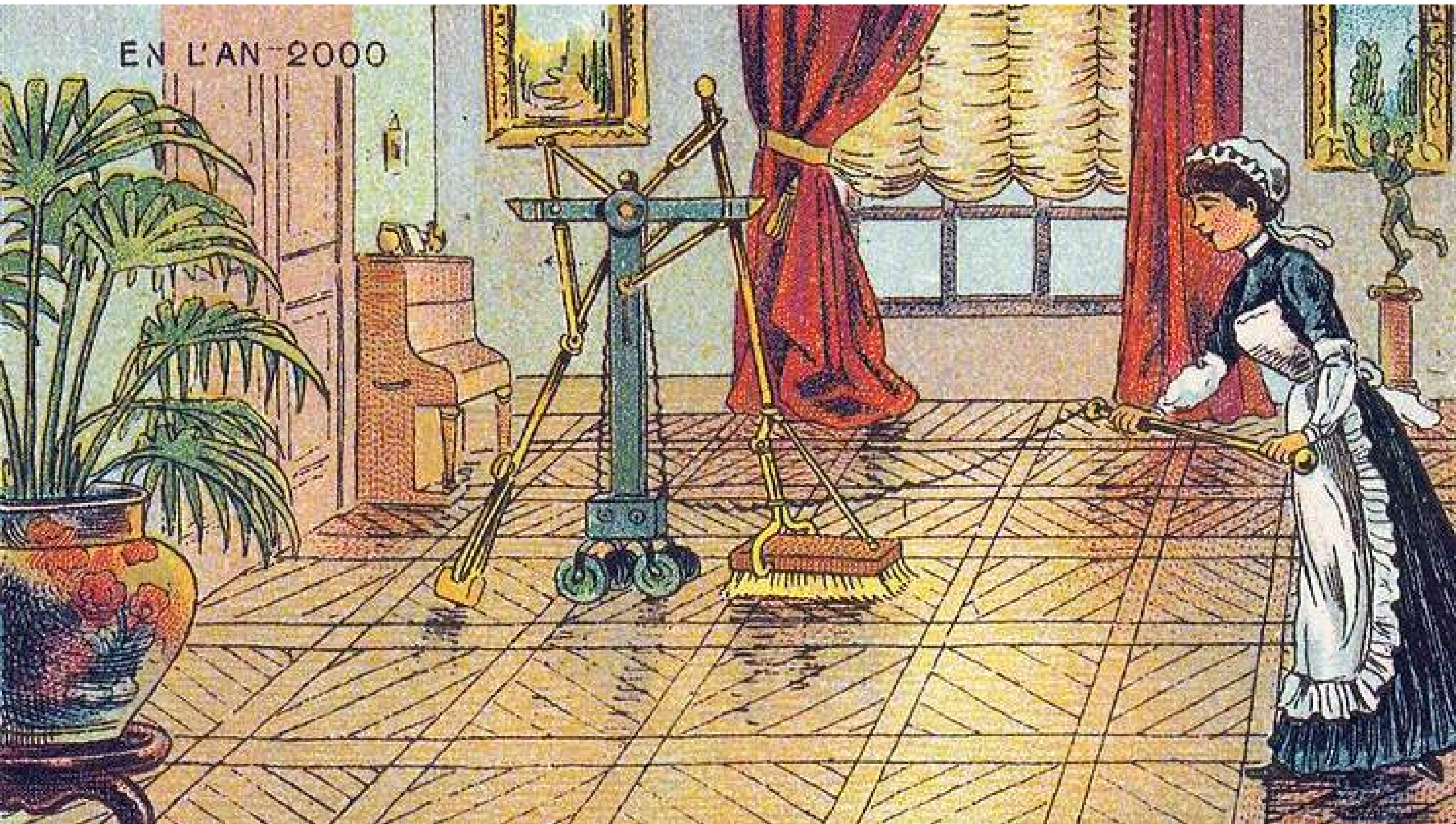



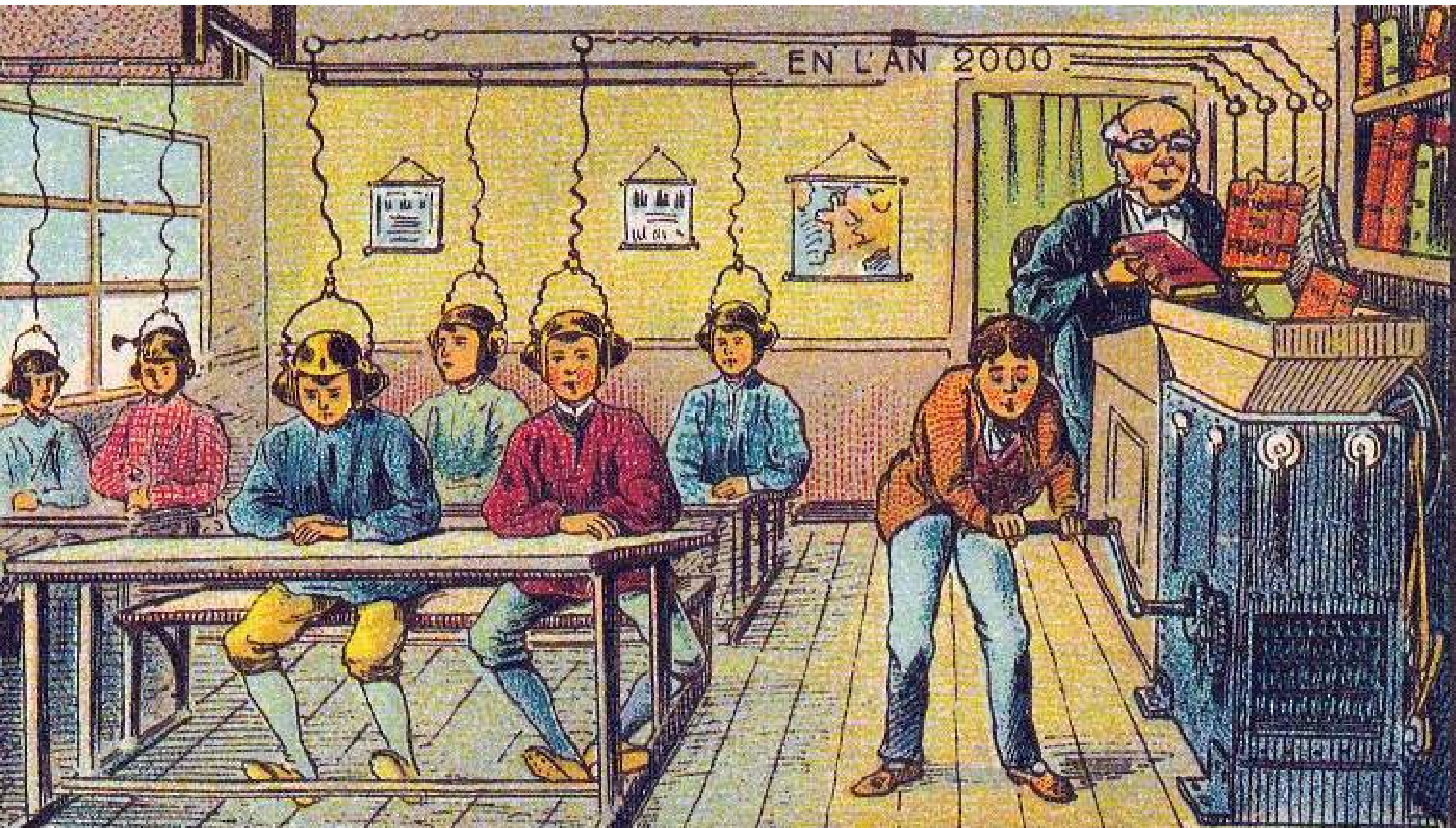

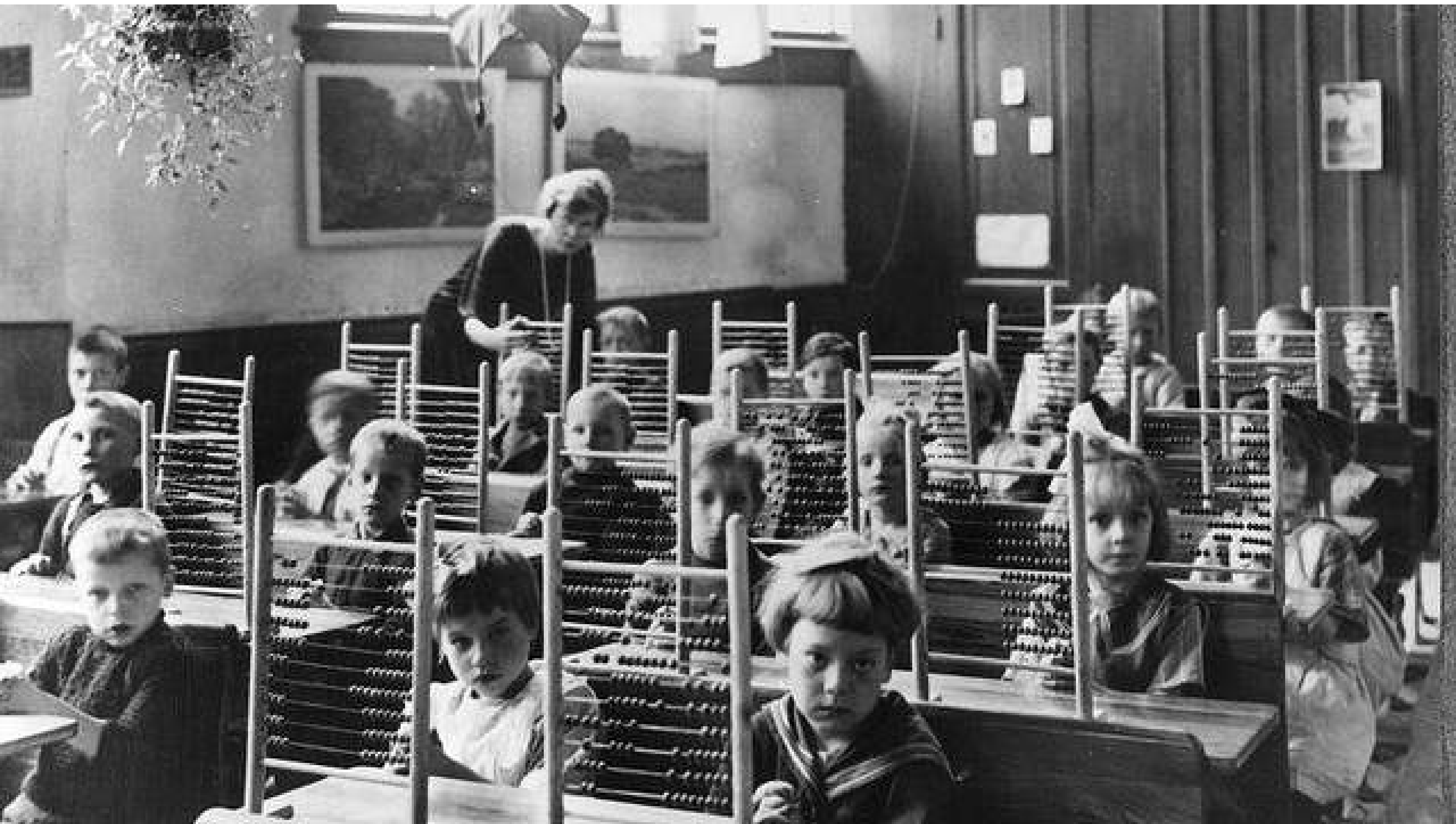



boats  
yellow can  
red cars.

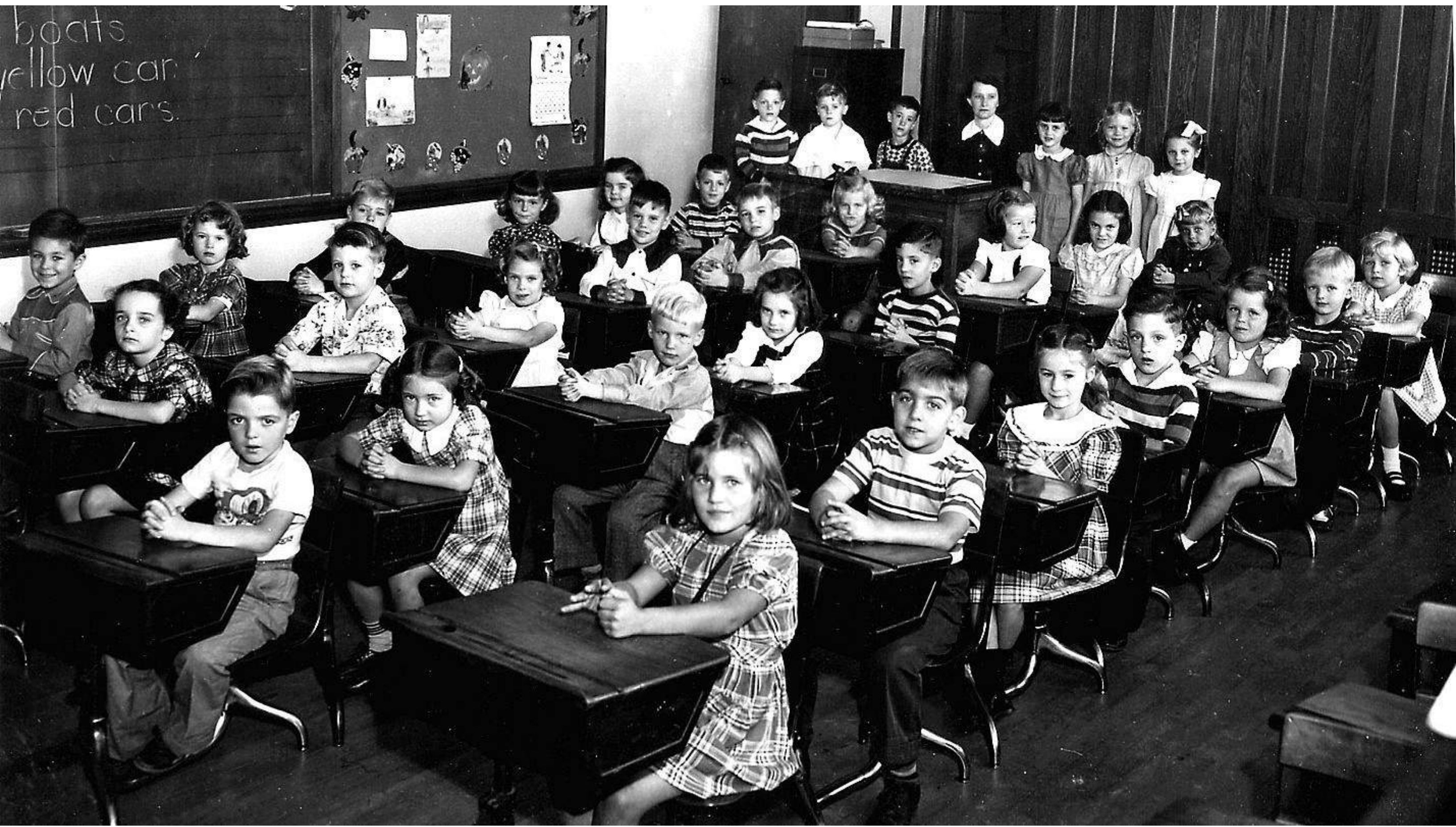









“We are currently preparing students for jobs that don’t yet exist, using technologies that haven’t yet been invented, in order to solve problems that we don’t even know are problems yet.”

- Karl Fisch, Educator



FOR A FAIR SELECTION  
EVERYBODY HAS TO TAKE  
THE SAME EXAM: PLEASE  
CLIMB THAT TREE

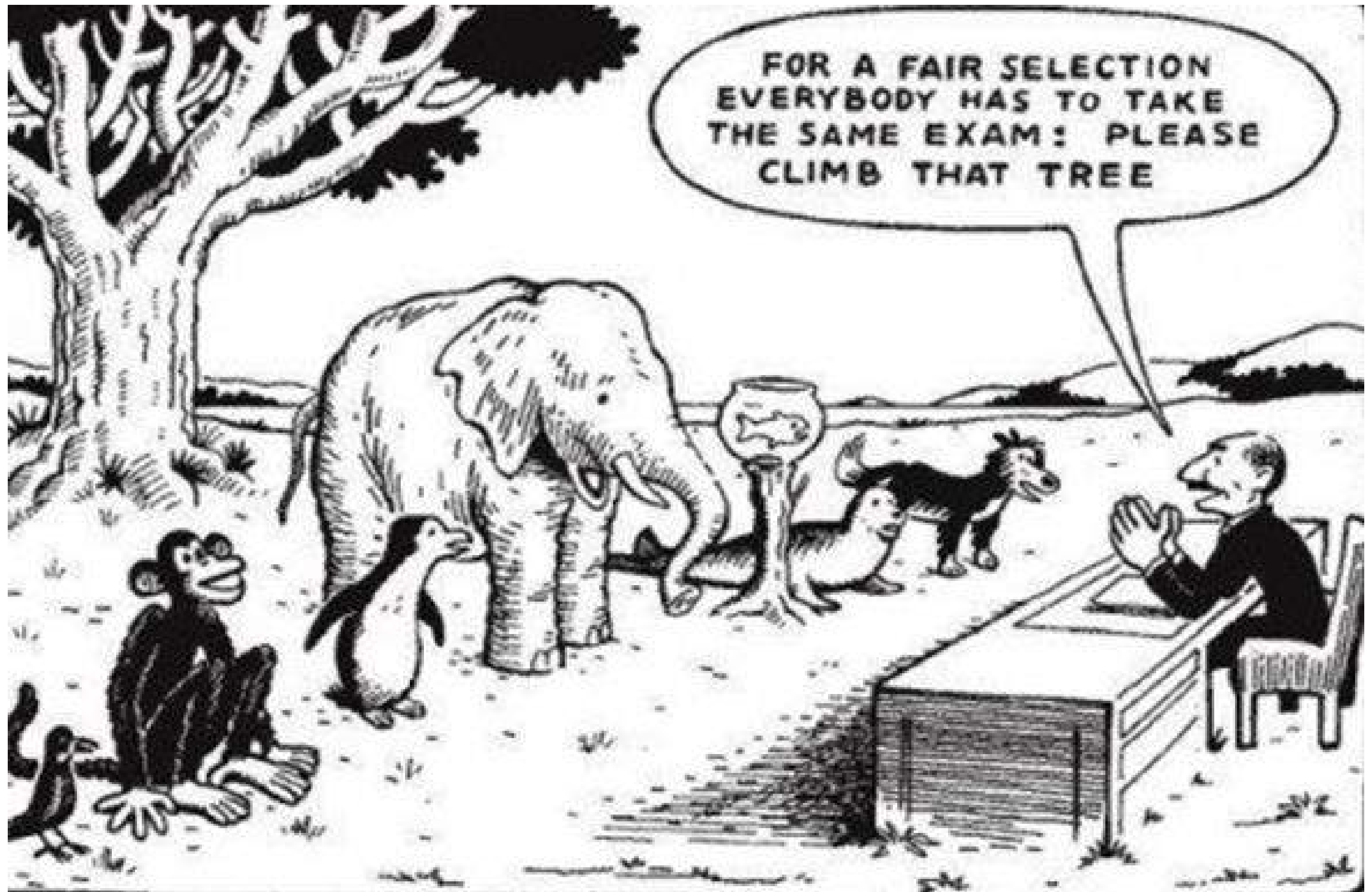





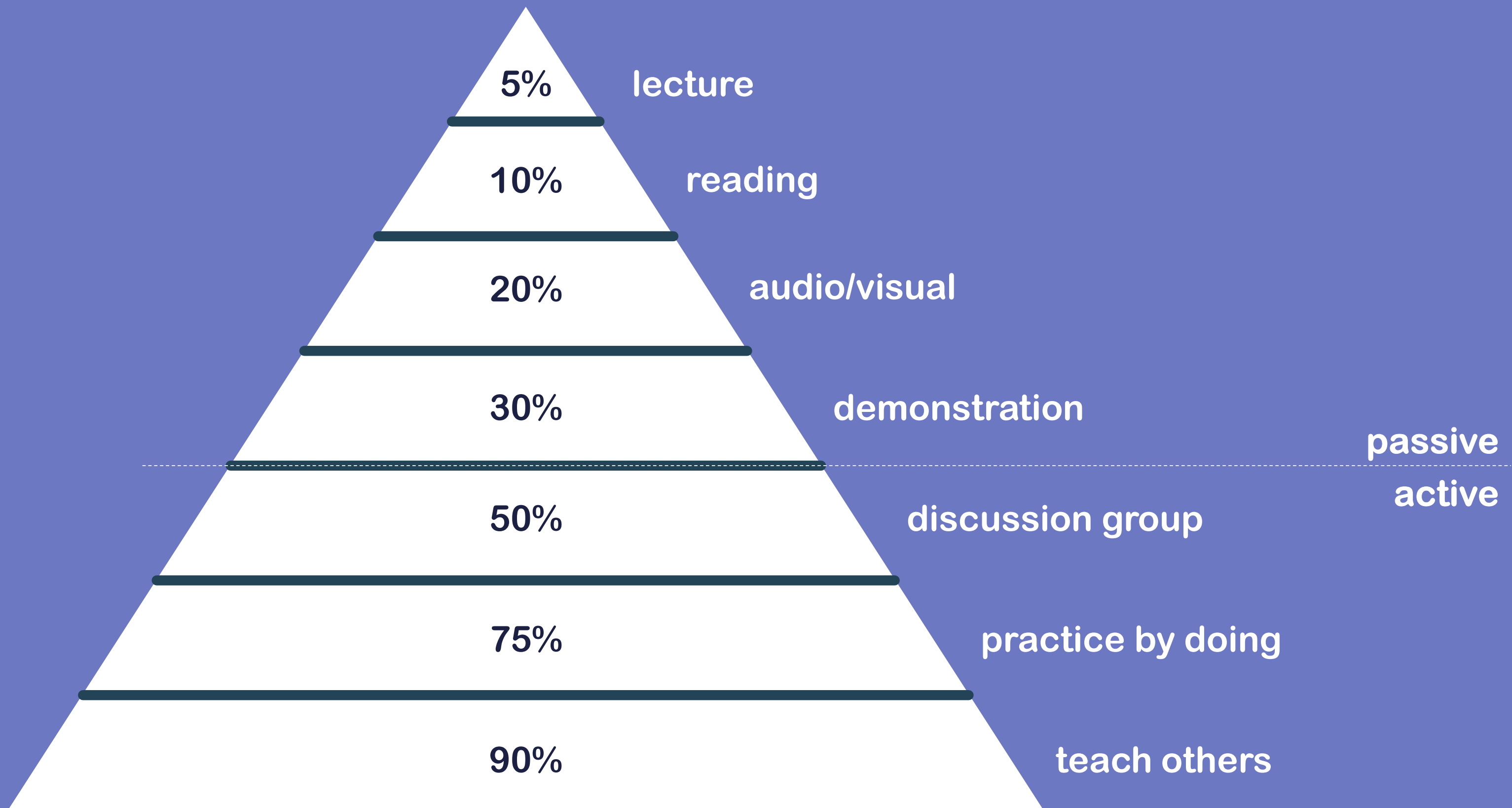

“Watching a child makes it obvious that the development of his mind comes through his movements.”



- Maria Montessori, Educator

AND...  
social  
emotional

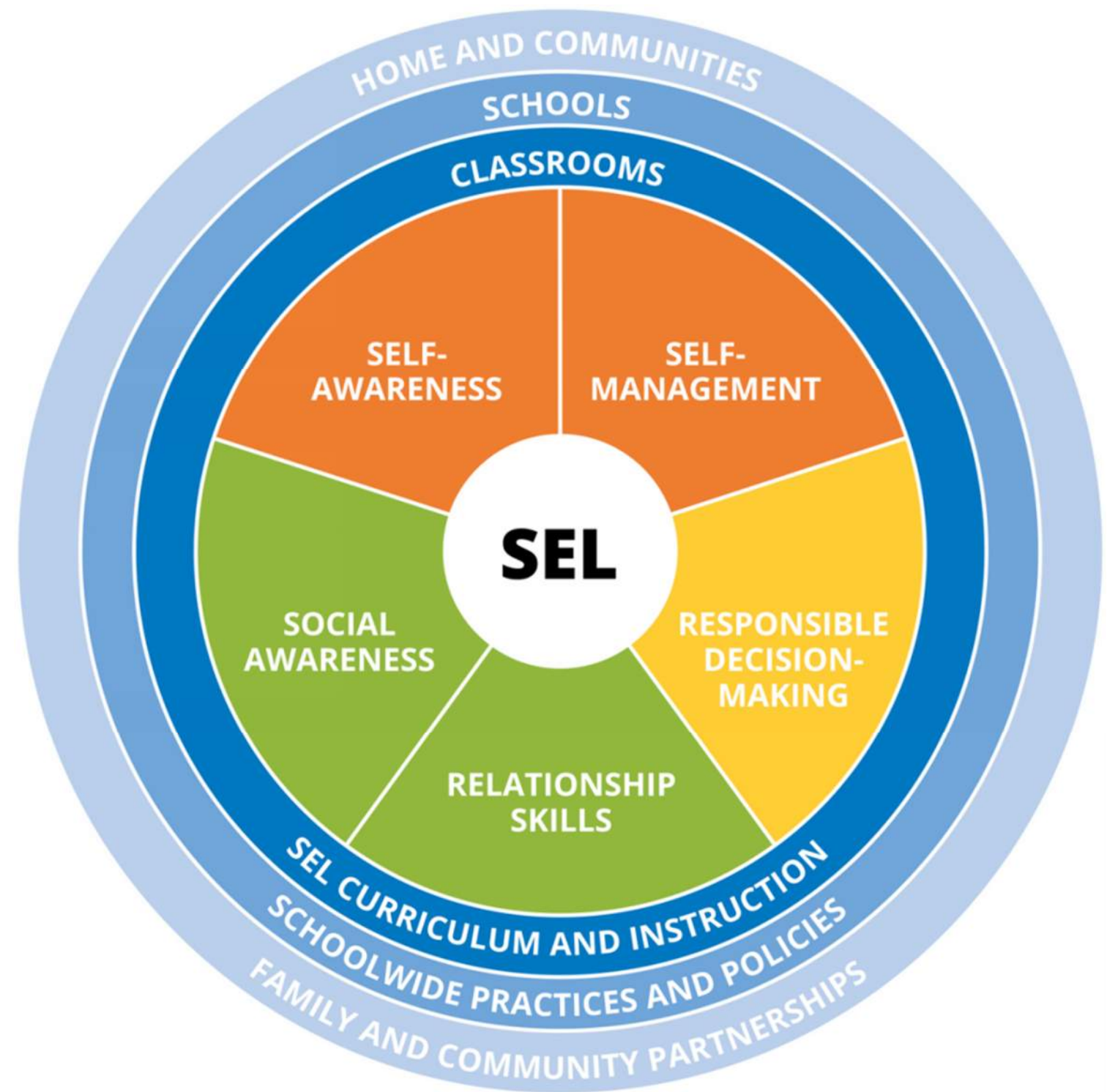



20<sup>th</sup> century



21<sup>st</sup> century



20<sup>th</sup> century



*The Differentiated Classroom*



21<sup>st</sup> century

20<sup>th</sup> century

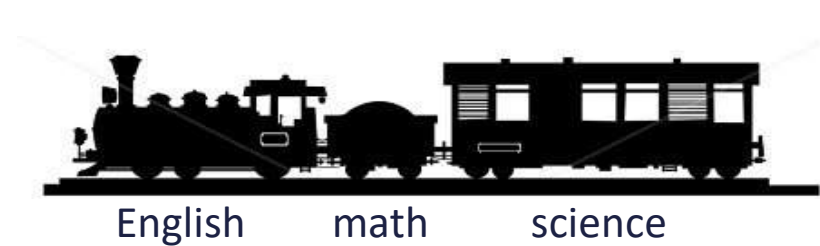

21<sup>st</sup> century



- Learning How to Learn
- Individual Student Learning Choices
- Highlighting Connectedness between disciplines
- Offer Authentic Learning Experiences







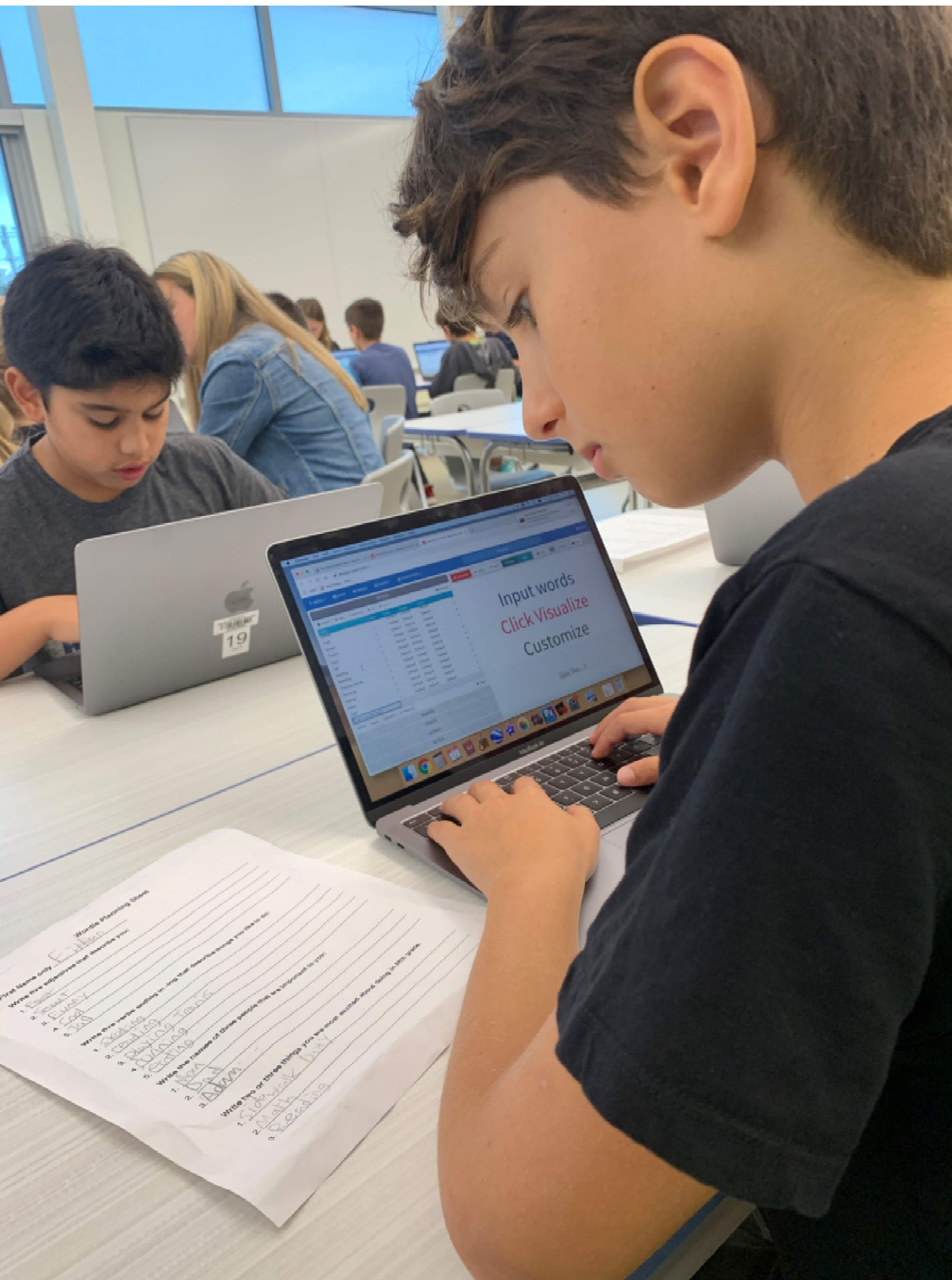







# Questions

# Facilities

that support the experience of students

# Example

## Learning Environments

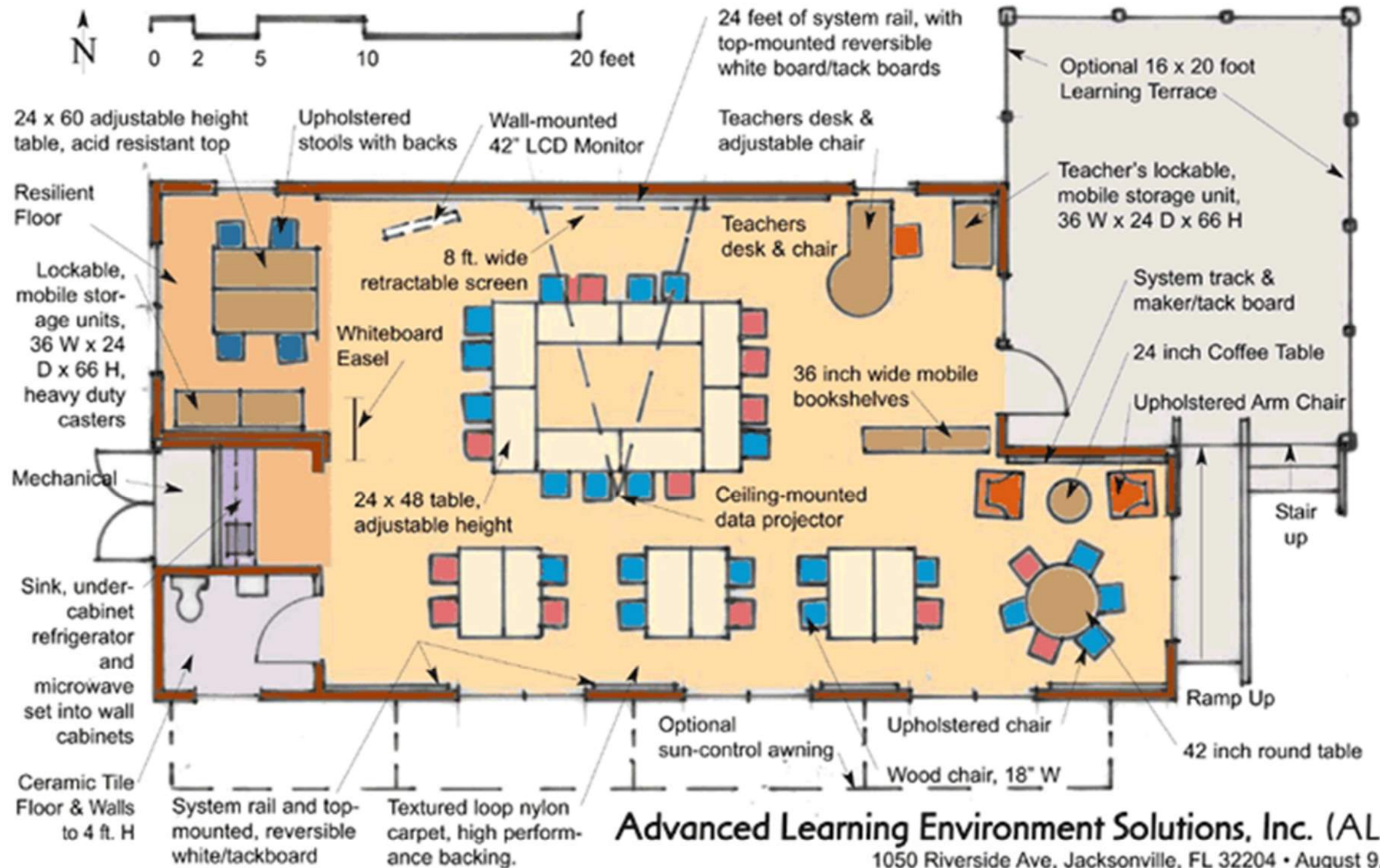

**Advanced Learning Environment Solutions, Inc. (ALESI)**

1050 Riverside Ave, Jacksonville, FL 32204 • August 9, 2004

**Middle & High School Floor Plan**

**(Adaptable for Elementary School Students)**

Copyright 2004 Fielding Nair International and Deployables, LLC. All Rights Reserved



**Fielding Nair International, LLC**

*Innovative Learning Communities*

New York • Minneapolis • FieldingNair.com



# **Bluestone E.S. | Harrisonburg, VA**

VMDO Architects, 2018



**Bluestone E.S. | Harrisonburg, VA**  
VMDO Architects, 2018





**Bluestone E.S. | Harrisonburg, VA**  
VMDO Architects, 2018





**Bluestone E.S. | Harrisonburg, VA**  
VMDO Architects, 2018



# **Elon W. Rhodes | Harrisonburg, VA**

VMDO Architects, 2017

Learning in a Neighborhood Setting

- A STUDIO
- B ENTOURAGE
- C SUPPORT

- 1 INTERACTIVE TECHNOLOGY
- 2 STUDENT STORAGE
- 3 READING NOOK
- 4 TEACHER WASHING / RESOURCE
- 5 ENTOURAGE / GROUP DINING + ARTS
- 6 ENTOURAGE STORAGE
- 7 HANDS-ON ACTIVE LEARNING
- 8 FOCUSED GROUP LEARNING
- 9 PERFORMANCE PLATFORM
- 10 STUDENT WASHING
- 11 SHARED STUDENT TOILETS

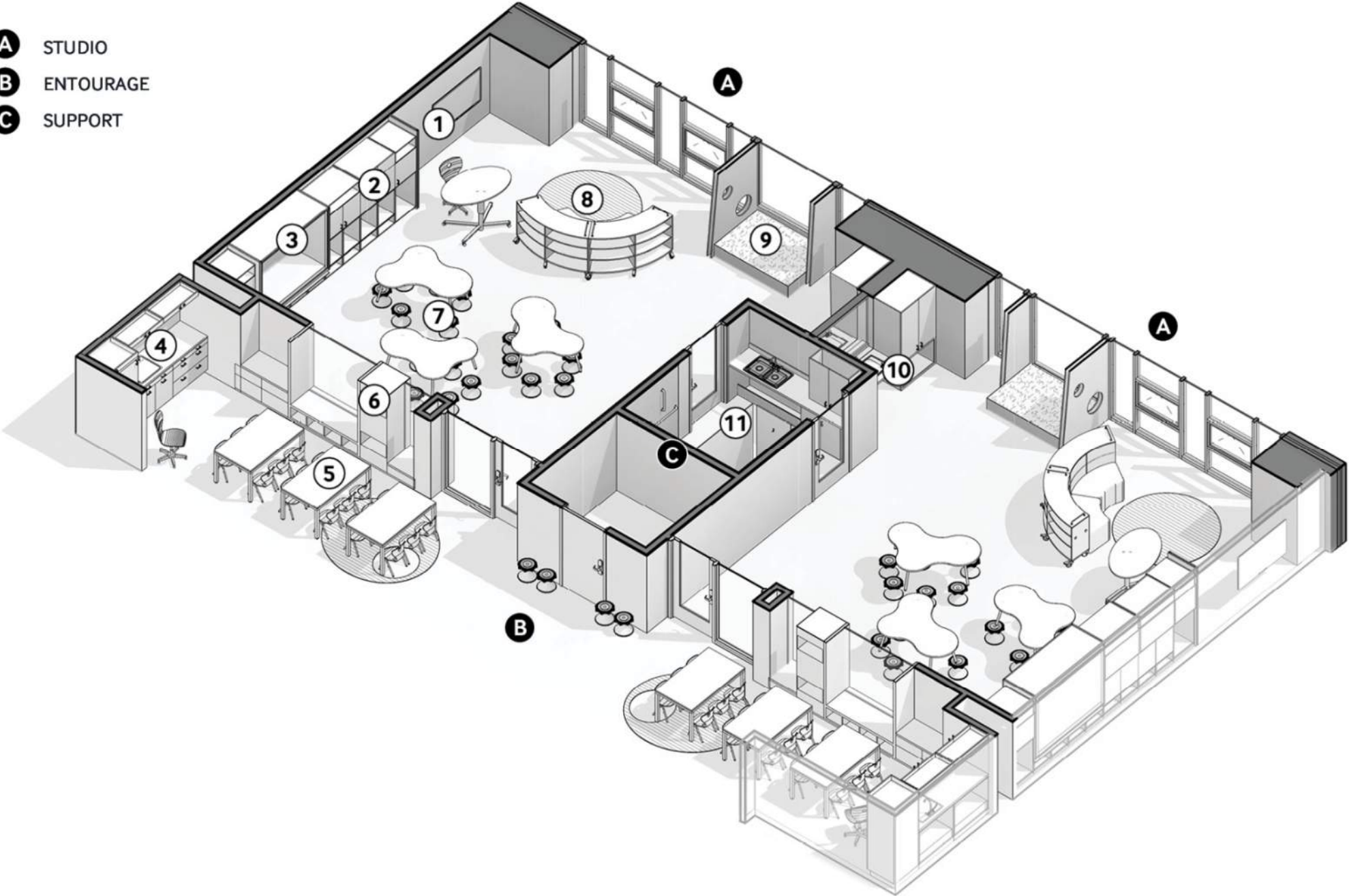



**Elon W. Rhodes | Harrisonburg, VA**  
VMDO, 2017





**Elon W. Rhodes | Harrisonburg, VA**  
VMDO, 2017



# Meadowlark ES | Cheyenne, WY

RB + B Architects, 2017



**Meadowlark E.S. | Cheyenne, WY**  
RB+B Architects, 2017





**Meadowlark E.S. | Cheyenne, WY**  
RB+B Architects, 2017



# **Emerald E.S. | Broomfield, CO**

RB+B Architects & Fielding Nair International, 2017

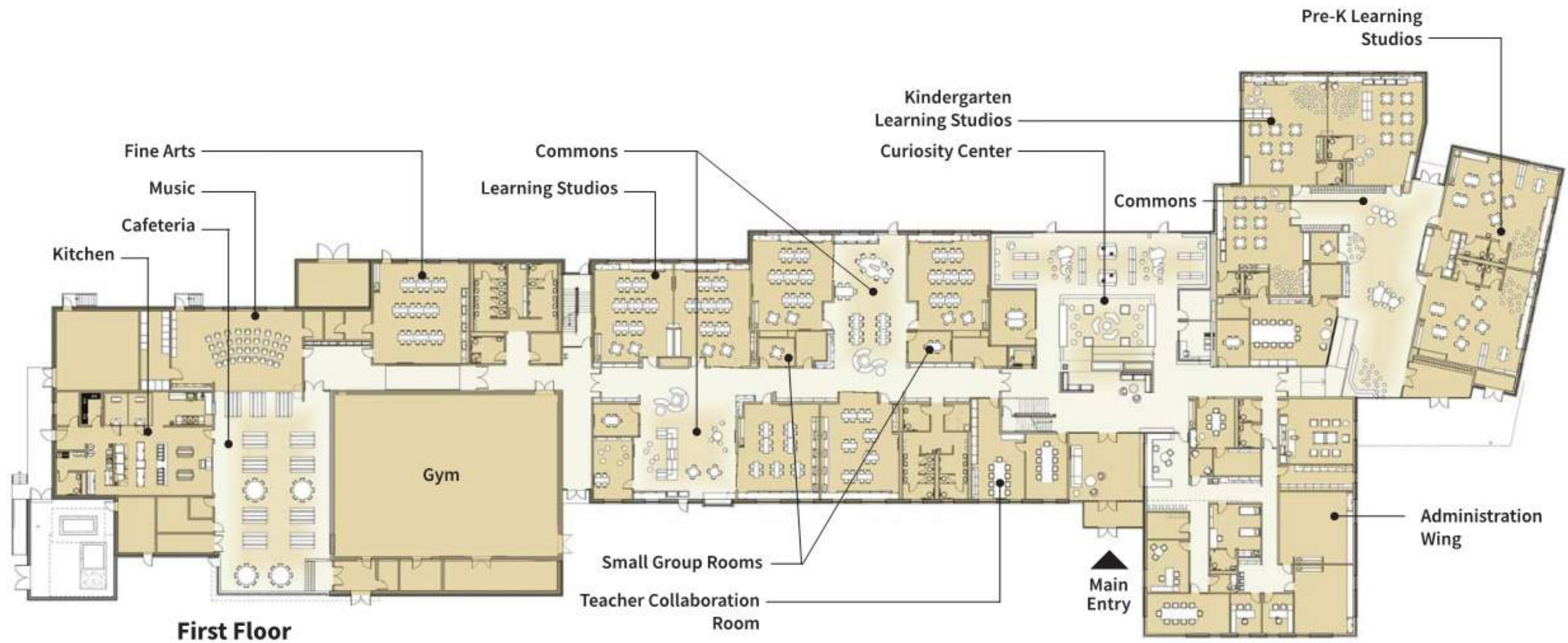

## Emerald E.S. | Broomfield, CO

RB+B Architects & Fielding Nair International, 2017



### Curiosity Center

At Emerald, the central gathering space—traditionally called a media center—is redefined as the Curiosity Center to better reflect its use as a place for gathering, research, discovery and project creation. A two-sided fireplace creates the comfortable feel of a living room on one side while serving as separation with the information side. The high volume space lets in abundant daylighting.



**Emerald E.S. | Broomfield, CO**  
RB+B Architects & Fielding Nair International, 2017



### Curiosity Center Furnishings

The furnishings are designed to create intimate layers of space throughout the Curiosity Center. Seating is varied in both height and style to create different experiences for students as they engage with the space. An English Language Development room overlooks the Curiosity Center from above.



**Emerald E.S. | Broomfield, CO**

RB+B Architects & Fielding Nair International, 2017



### Personalized Spaces

Throughout the school, personalized spaces were designed to be accessible to all students. The preschool and kindergarten wing has a common teaching/reading area (below). Various sizes of movable furnishings as well as built-in furnishings (at right) create opportunity for multi-purpose space.



**Sunita L. Williams E.S. | Needham, MA**

D+W Architects



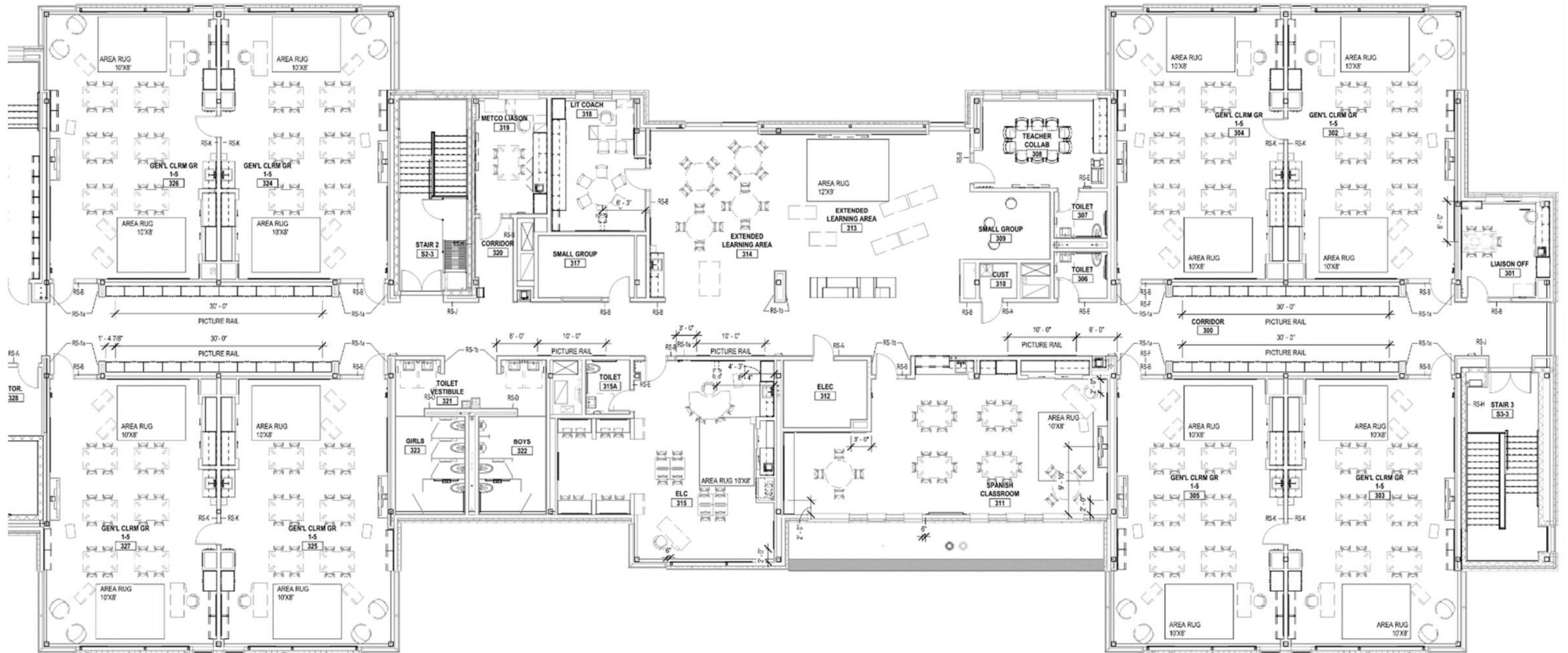

**Sunita L. Williams E.S. | Needham, MA**  
Dore + Whittier Architects

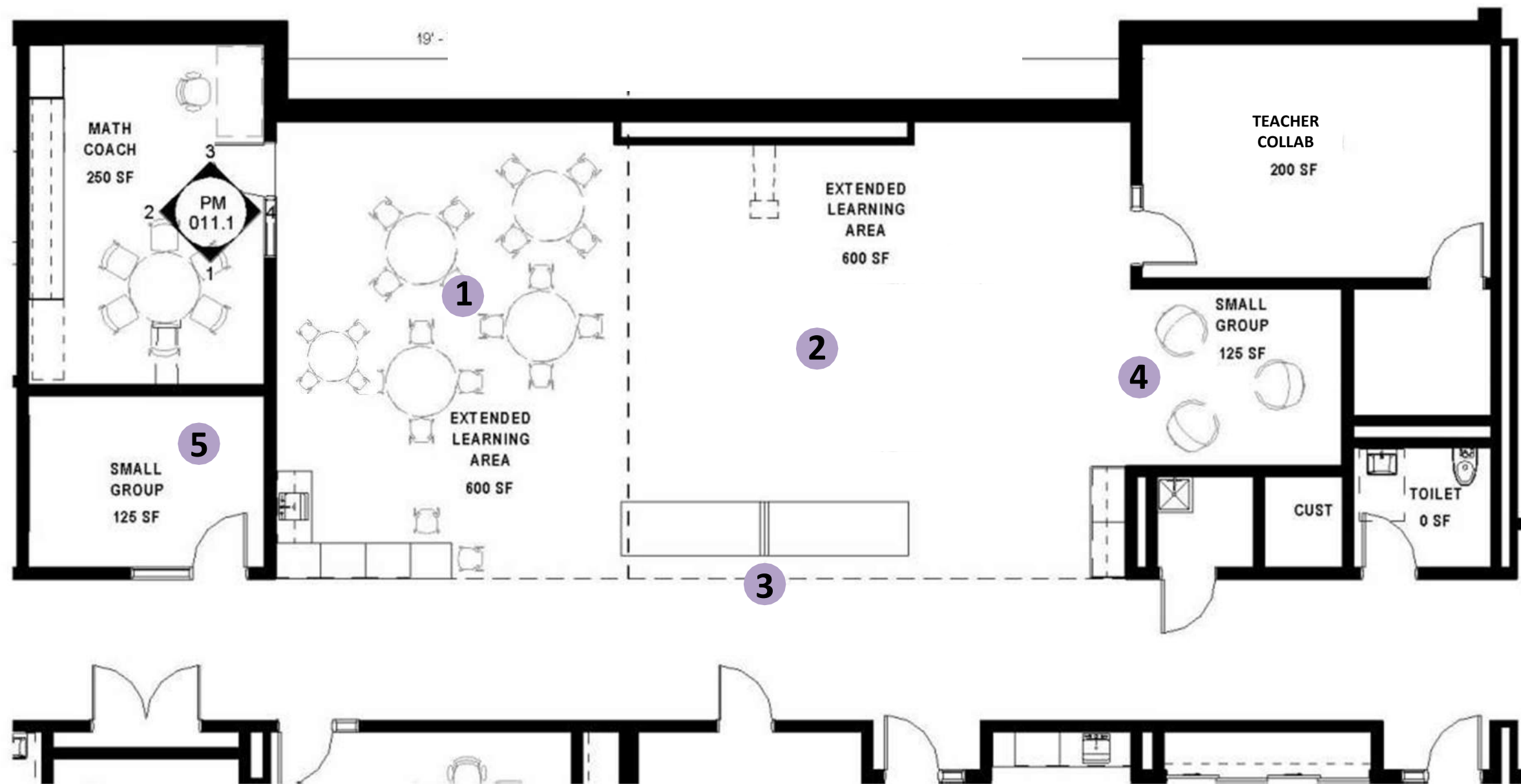

- 1 Messy, Science Activity Area w/ Sink & Storage
- 2 Open Floor Area for Grade Level Instruction
- 3 Cave Space for Sensory Break or Quiet Reading
- 4 Imagination Area w/ Magnetic Dry-erase
- 5 Acoustically Separate Small Group Break Out





**Sunita L. Williams E.S. | Needham, MA**  
Dore + Whittier Architects





**Sunita L. Williams E.S. | Needham, MA**  
Dore + Whittier Architects



# Questions

# Educational Facilities Activity

## Explore the images and respond...

*I like...*

*The wide variety of spaces students can choose from.*

A positive comment about something that the project should explore

*I wish...*

*We could have more public art incorporated into the project.*

A visionary comment about something the project should consider

*I wonder...*

*If MSBA will reimburse for a slightly larger gymnasium.*

A comment requesting additional information or exploration



# Next Steps

- 12.12.19 Public Forum
- December & January 2020 – Options Development
- February 2020 – Cost Estimates and Options Evaluations
- March 2020 – Identification of Short List and Submission of PDP to MSBA
- Summer 2020 – Identification of Preferred Solution & Submission of PSR to MSBA