

# SHEEHAN ELEMENTARY SCHOOL CONCEPTUAL STUDY

05.25.2021

Project Overview

Conceptual Options

# Overview

## 1. Confirmed program specific to Sheehan ES needs

- Reviewed student enrollment (McKibben and NESDEC) established a design capacity of 307 students:
  - 3 sections of Kindergarten
  - 2 sections of each for grades 1-5
  - 1 additional classroom as needed based on enrollment
- Building Size:
  - Existing Building: 52,550 GSF
  - Proposed Program: 67,152 GSF

## 2. Developed Conceptual Options

- Code Upgrade / Base Repair Only
- Renovation / Addition
- New Construction

# Conceptual Options

# Sheehan Reno – Code Upgrade / Base Repair only, No Educational or Site Improvements

## Existing Floor Plan

### KEY

- Below MSBA Guidelines
- Meets MSBA Guidelines
- Exceeds MSBA Guidelines

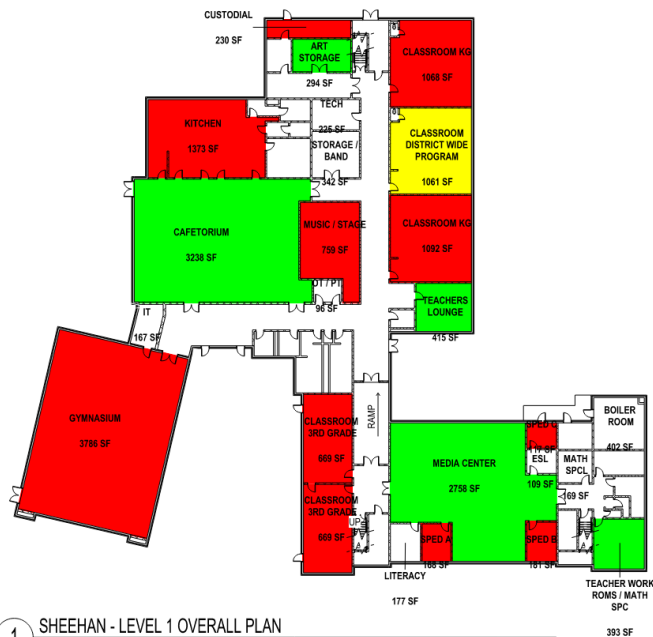

1 SHEEHAN - LEVEL 1 OVERALL PLAN  
1" = 30'-0"



2 SHEEHAN - LEVEL 2 OVERALL PLAN  
1" = 30'-0"

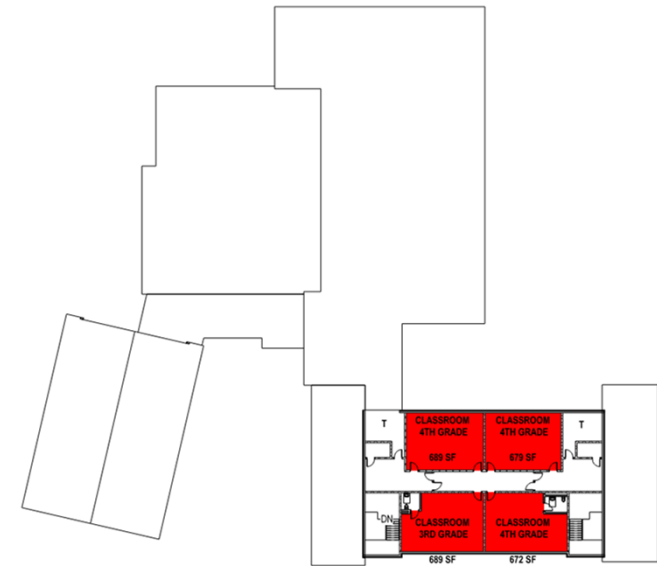

3 SHEEHAN - LEVEL 3 OVERALL PLAN  
1" = 30'-0"

Existing Total: 52,550 GSF  
Project Cost: \$27.1 M\*

\*Assumes students are temporarily relocated offsite between Deerfield and Hanlon schools during construction



# Sheehan Reno/Add

## Renovation and Additions Option



First Floor Plan

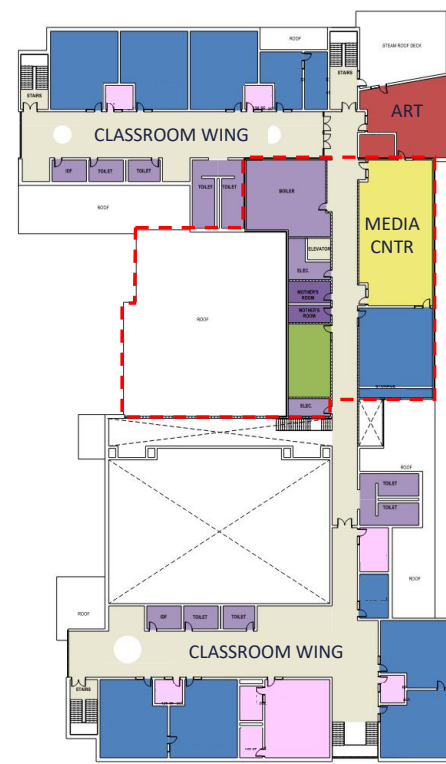

Second Floor Plan

Program: 74,000+/- GSF

\*Assumes students are temporarily relocated offsite between Deerfield and Hanlon schools during construction

### PROGRAMMING LEGEND

- CORE ACADEMIC
- SPECIAL EDUCATION
- ART & MUSIC
- VOCATIONS & TECHNOLOGY
- HEALTH & PHYSICAL EDUCATION
- MEDIA CENTER
- DINING & FOOD SERVICE
- MEDICAL
- ADMINISTRATION & GUIDANCE
- CUSTODIAL & MAINTENANCE
- RENOVATED AREAS

# Sheehan – Reno/Add

## Renovation and Additions Option

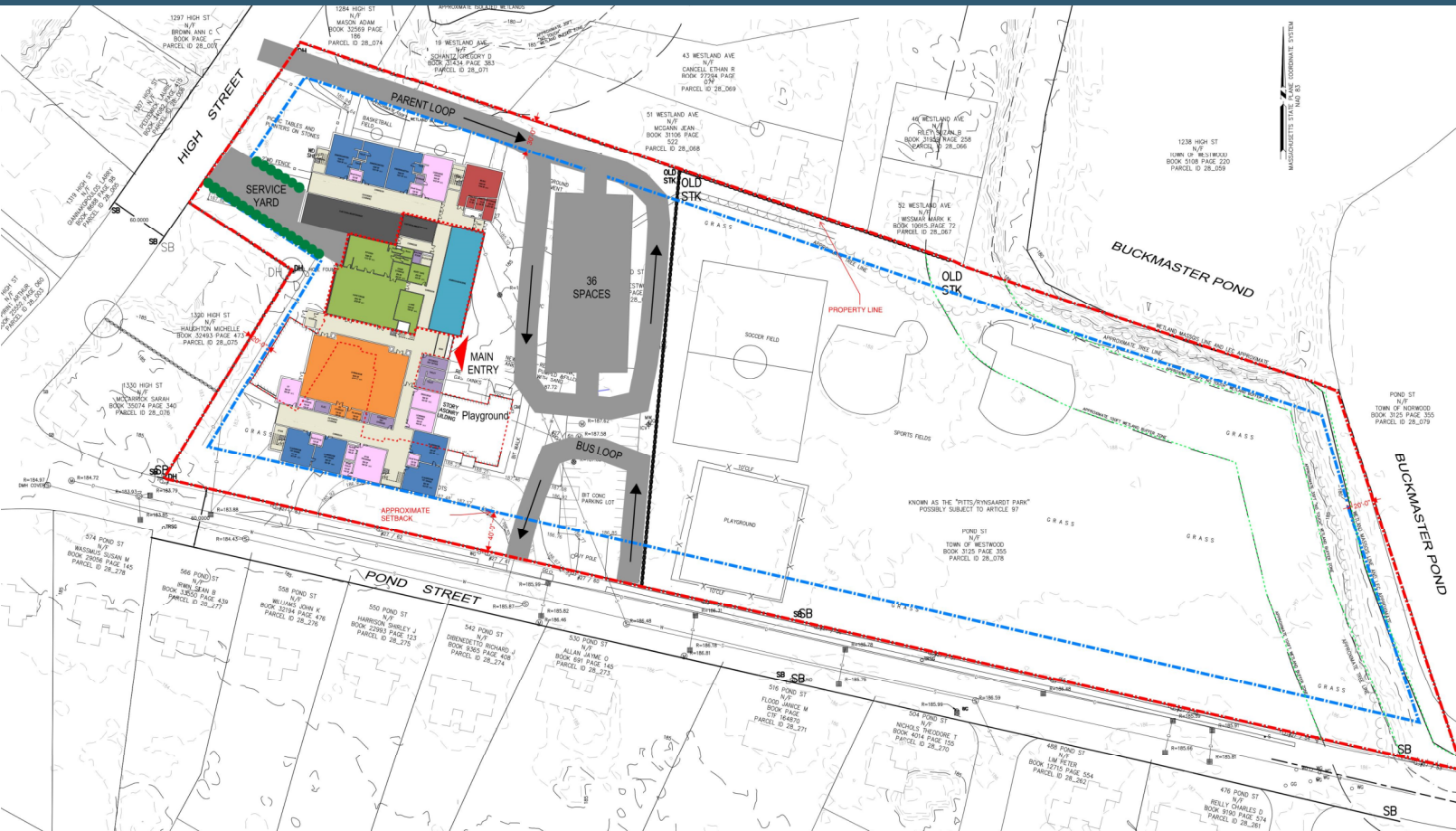

### Phasing:

1. Relocate students to Deerfield/Hanlon ES
2. Demo, Renovations and New construction
3. Complete sitework
4. Students move back in

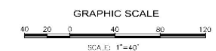
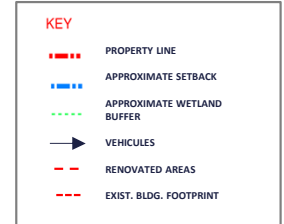

# Sheehan – New Construction

## New Building Option 1 – “T Plan”

Program: 67,152+/- GSF



First Floor Plan

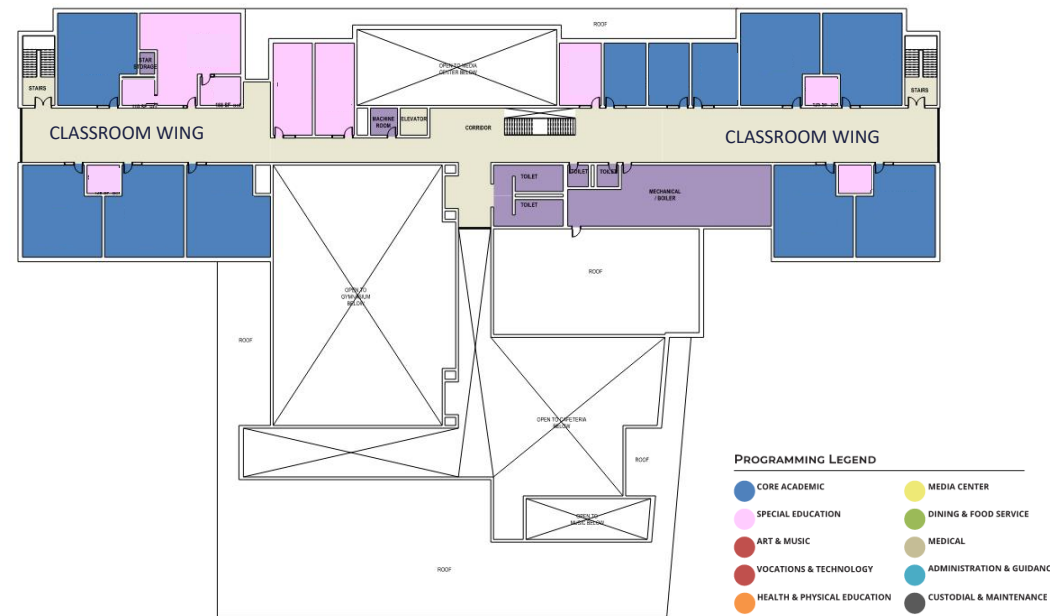

Second Floor Plan

# Sheehan – New Construction

## New Building Option 1 – “T Plan at Fields”

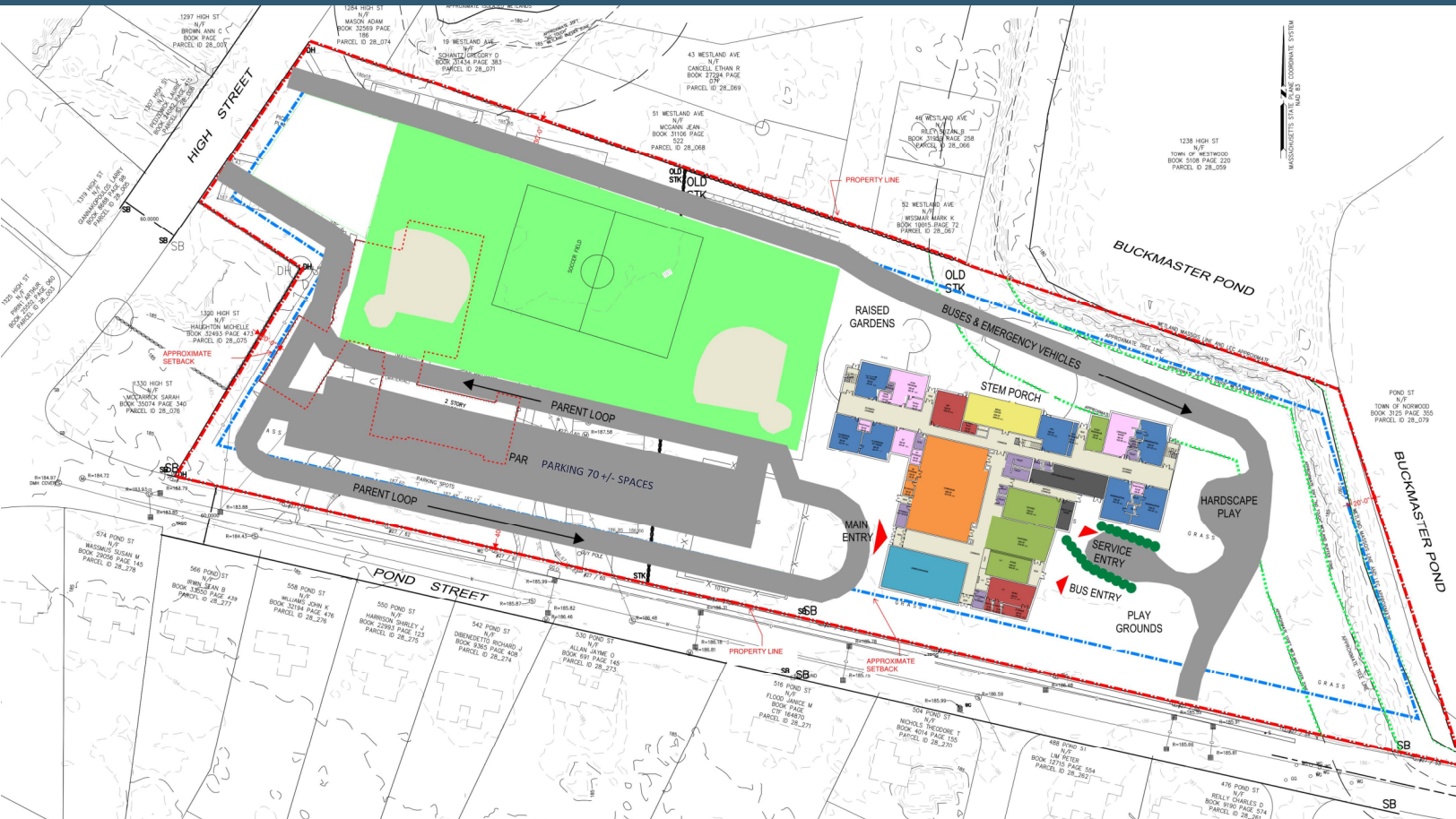

### Phasing:

1. Students to remain in existing building during construction
2. New Construction
3. Move students into new building
4. Demo Existing Building
5. Complete sitework

# Sheehan – New Construction

## New Building Option 2 – “Compact Plan”

Program: 67,152+/- GSF



First Floor Plan

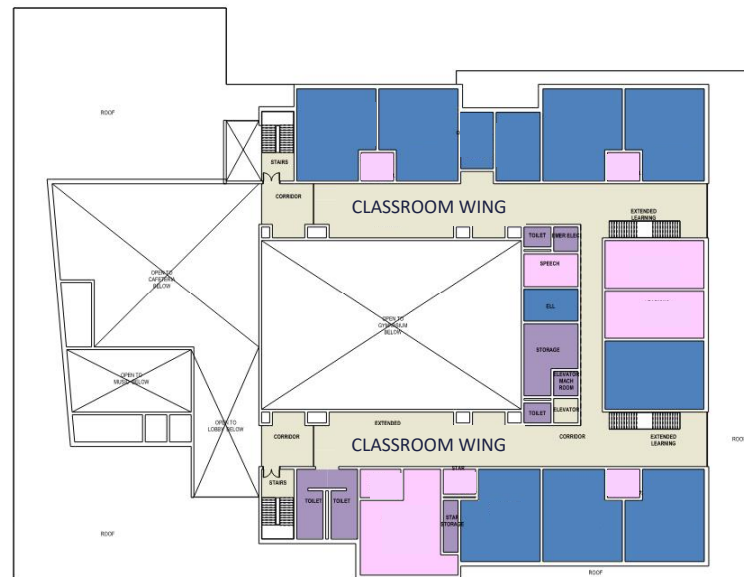

Second Floor Plan

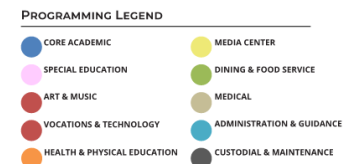



# Sheehan – New Construction

## New Building Option 2 – “Compact Plan at Fields”

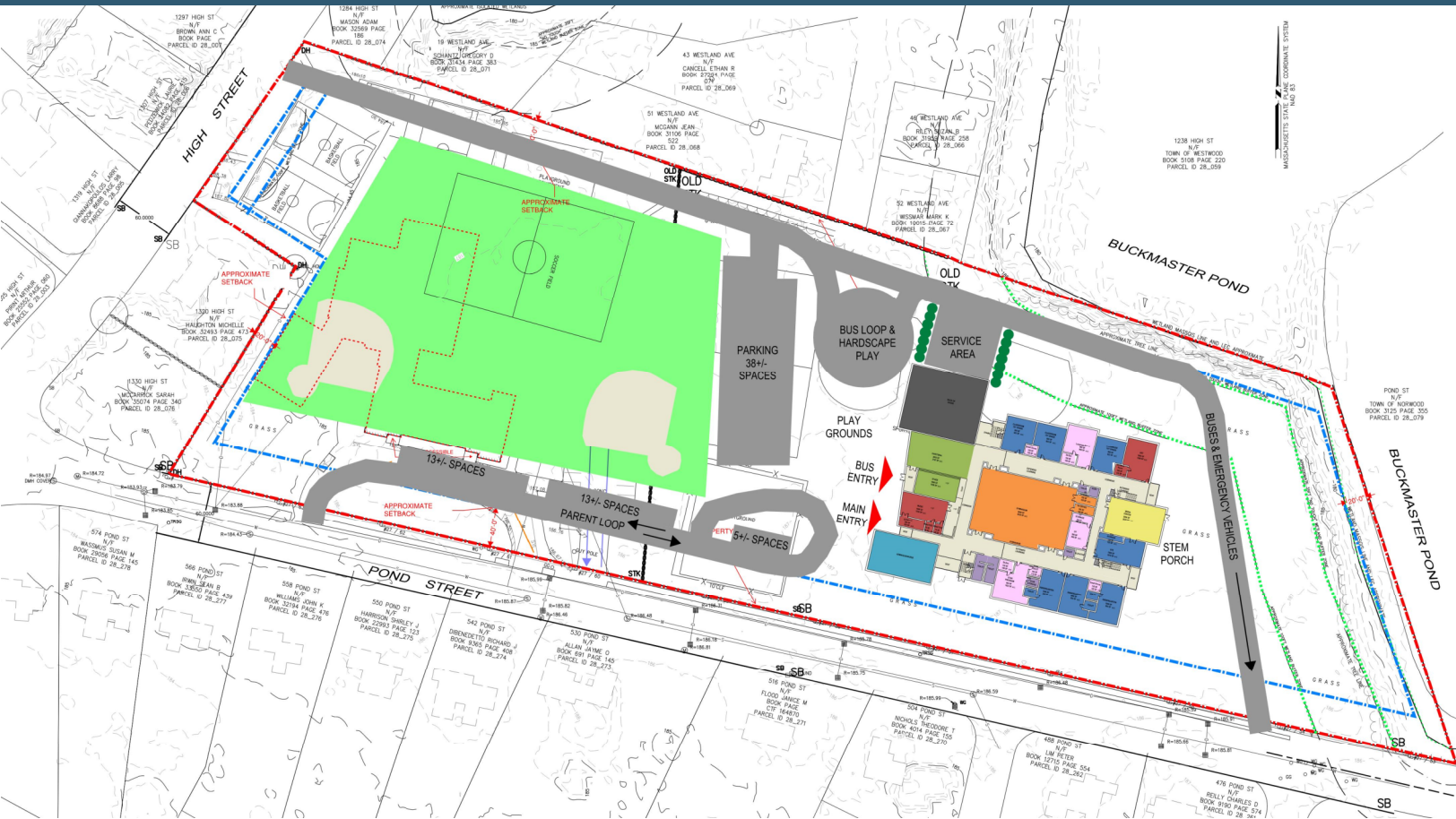

### Phasing:

1. Students to remain in existing building during construction
2. New Construction
3. Move students into new building
4. Demo Existing Building
5. Complete sitework

**Questions  
Comments  
Reactions**