

Westwood Public Schools

Capital Needs Study- Master Plan Options



Westwood MA Deerfield School ES Live Attend Analysis 2014-15

Deerfield School	
Total Enrollment (K-5th)	247
Matched	247
Unmatched	0
Out of District	5
Total Live-In	234
Live and Attend In	224
Live Out, Attend In	23
Live In, Attend Out	10

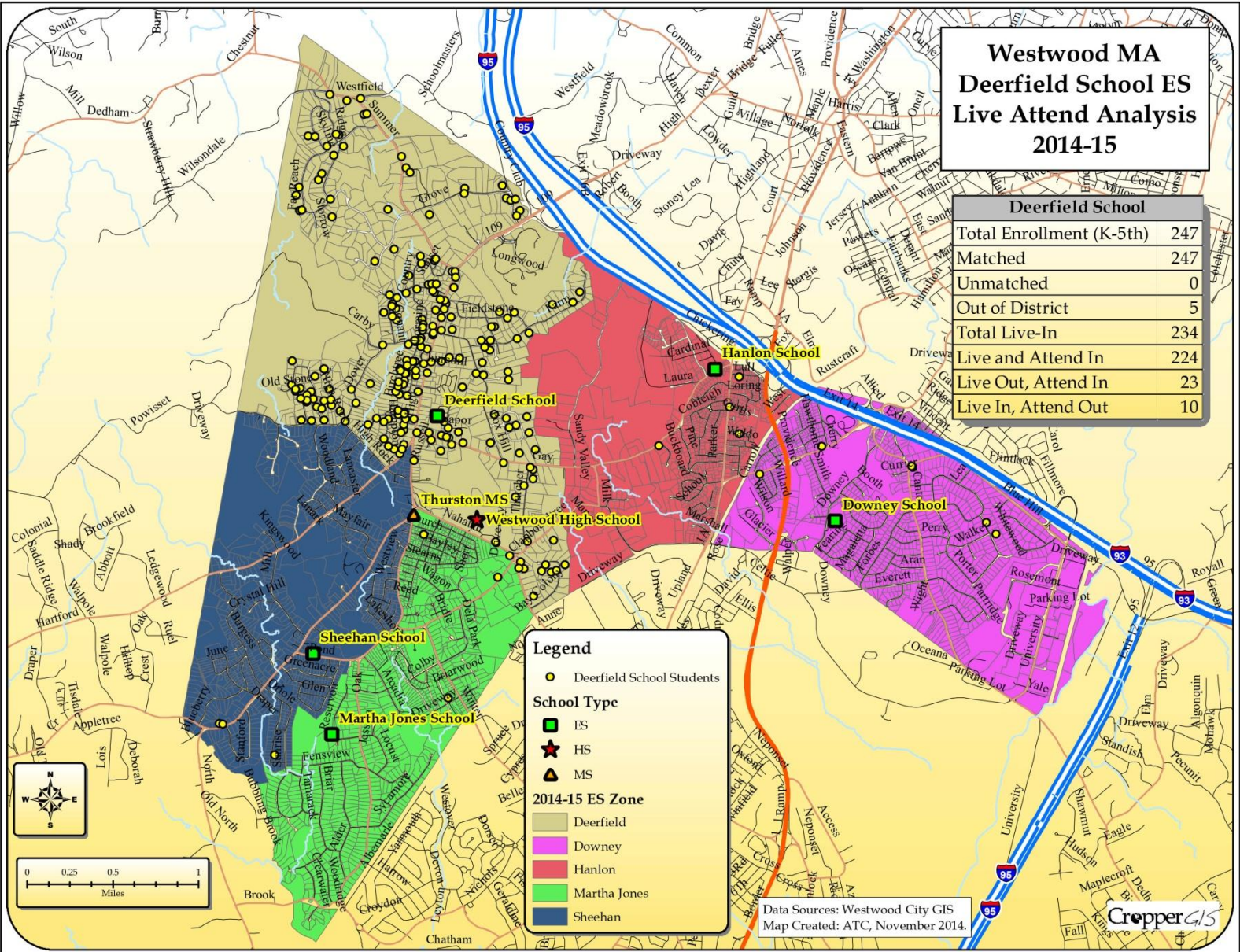

Legend

- Deerfield School Students

School Type

- ES
- ★ HS
- ▲ MS

2014-15 ES Zone

- Deerfield
- Downey
- Hanlon
- Martha Jones
- Sheehan

Data Sources: Westwood City GIS
Map Created: ATC, November 2014.

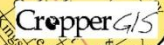

DEMOGRAPHIC ANALYSIS

	Current 2014-2015 Population <i>(% Building Usage)</i>	2024/2025 Forecasted Enrollment Cropper Report <i>(% Building Usage)</i>	Design Enrollment <i>(% Building Usage)</i>	Existing GSF (Including Modulars)	Existing Building Capacity <i>*Based on current MSBA standards 18 Students (K) 23 Students (1-5)</i>
Deerfield Elementary	247 <i>(113%)</i>	223 <i>(102%)</i>	229 <i>(105%)</i>	35,078 (2 Sections)	218
Sheehan Elementary	373 <i>(105%)</i>	292 <i>(82%)</i>	318 <i>(89%)</i>	49,586 (3 Sections)	356
Hanlon Elementary	226 <i>(104%)</i>	219 <i>(100%)</i>	224 <i>(103%)</i>	34,280 (2 Sections) Extended Day	218
Martha Jones Elementary	295 <i>(89%)</i>	249 <i>(75%)</i>	264 <i>(79%)</i>	50,796 (2+ Sections)	333
Downey Elementary	250 <i>(75%)</i>	215 <i>(65%)</i>	228 <i>(68%)</i>	50,692 (2+ Sections)	333
Total for District (K-5)	1,391 <i>(97%)</i>	1,198 <i>(85%)</i>	1,263 <i>(89%)</i>		1,458
Thurston Middle School	798 <i>(105%)</i>	698 <i>(92%)</i>	725 <i>(96%)</i>	92,278	759

EXISTING SITES

Deerfield Elementary



Sheehan Elementary



Hanlon Elementary



EXISTING SITES

Martha Jones Elementary



Downey Elementary



Thurston Middle School



Status Quo

Option A-1

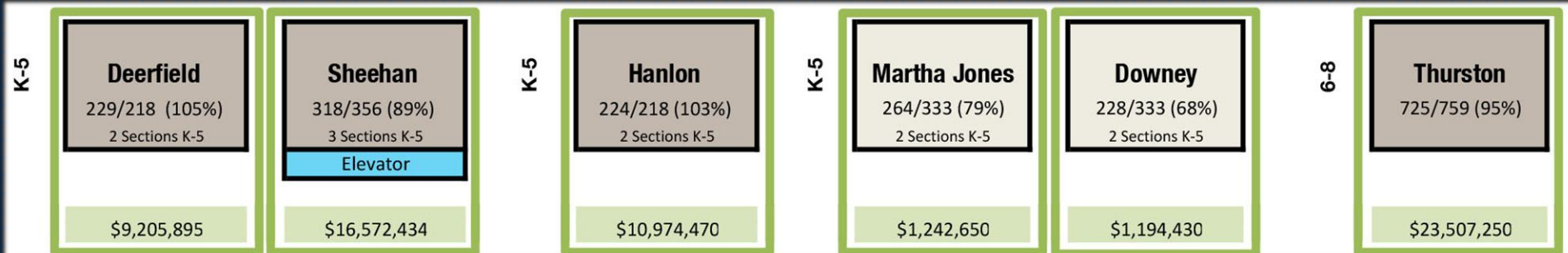

ELEMENTARY SCHOOLS

- Major Renovations of existing building systems and infrastructure required at Deerfield, Sheehan and Hanlon
- Infrastructure upgrades will trigger full compliance with MAAB- Accessibility codes
- Potential for extensive hazardous materials abatement

Deerfield
Grades K-5
2 Sections

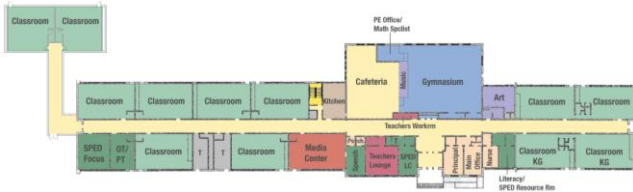

Sheehan
Grades K-5
3 Sections



Hanlon
Grades K-5
2 Sections



ELEMENTARY SCHOOLS

- *Only Minor system upgrades required at Downey and Martha Jones*
- *Recent major renovations and additions*

Downey
Grades K-5
2 Sections



Martha Jones
Grades K-5
2 Sections

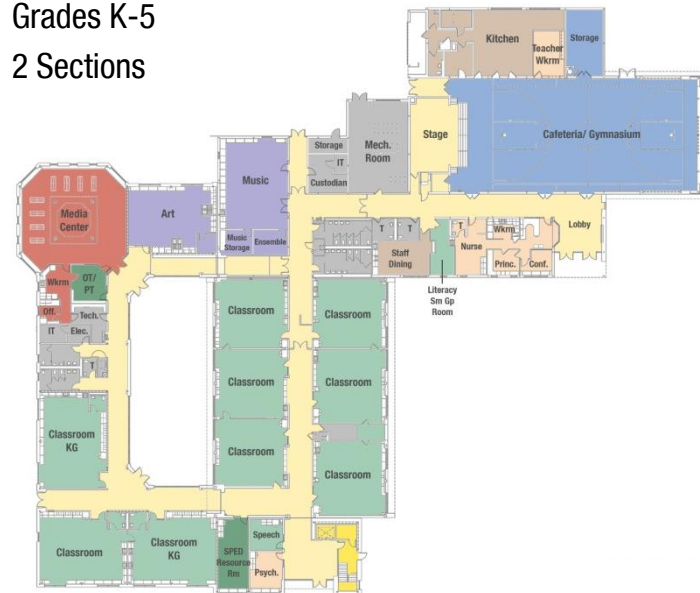

THURSTON MIDDLE SCHOOL

- *Major Renovations of existing building systems and infrastructure required at Thurston*
- *Infrastructure upgrades will trigger full compliance with MAAB- Accessibility codes*
- *Potential for extensive hazardous materials abatement*

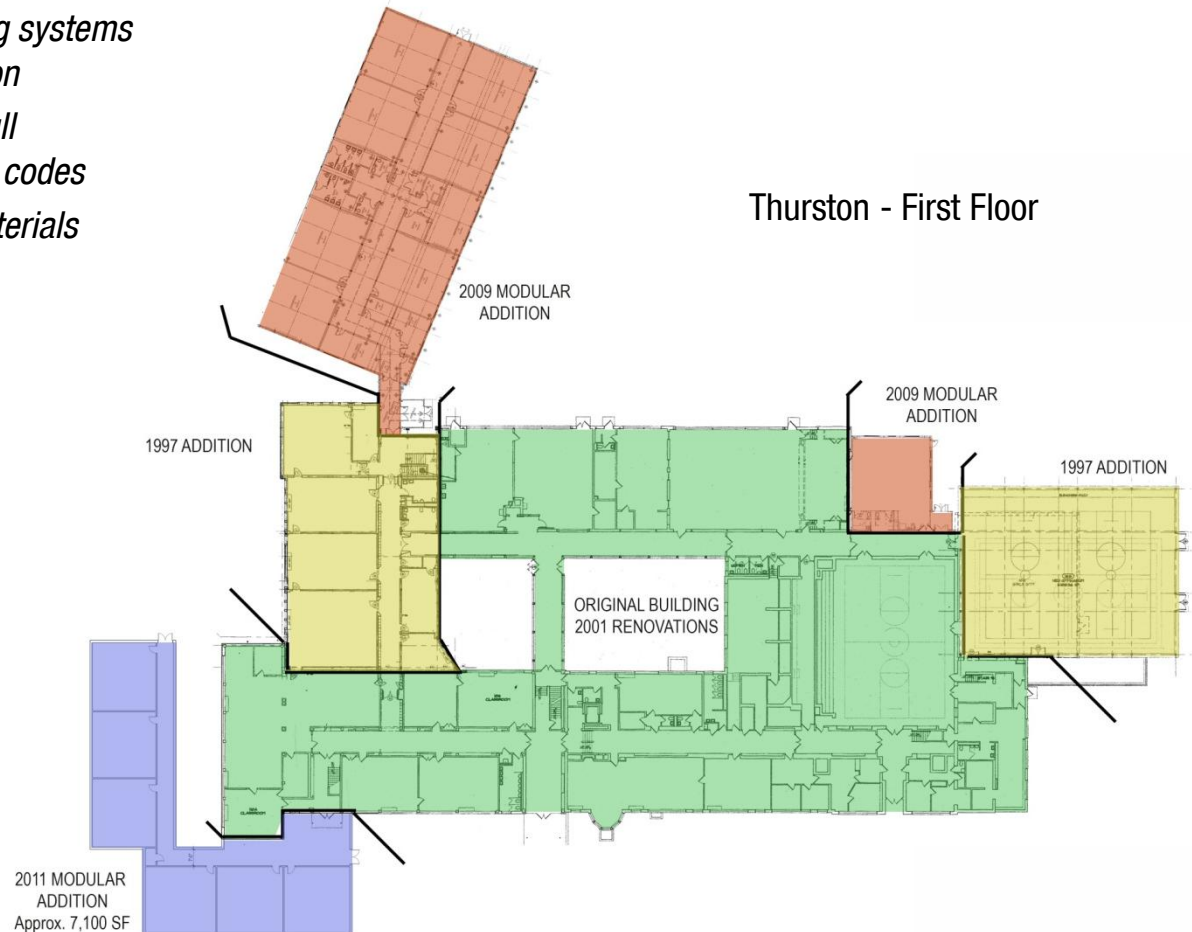

PROJECT COSTS- OPTION A-1

- **\$62,697,129** Total Project Costs- w/o MSBA Reimbursement

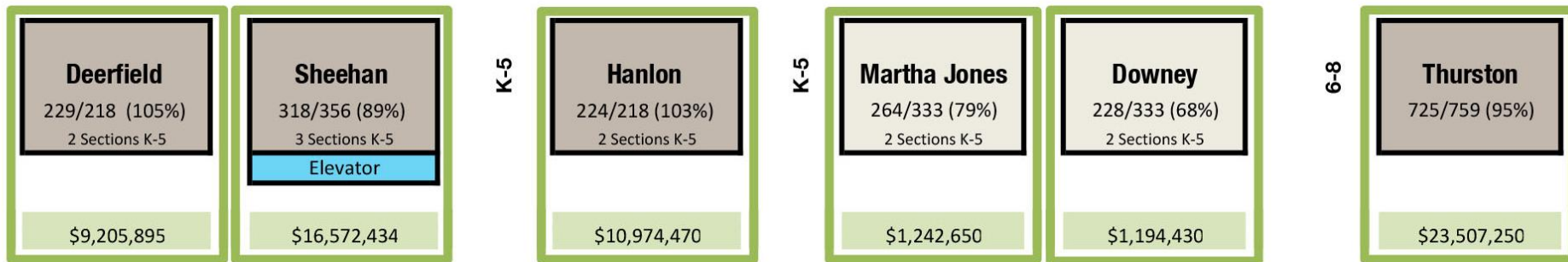

Satisfy Educational Program

Option B-1

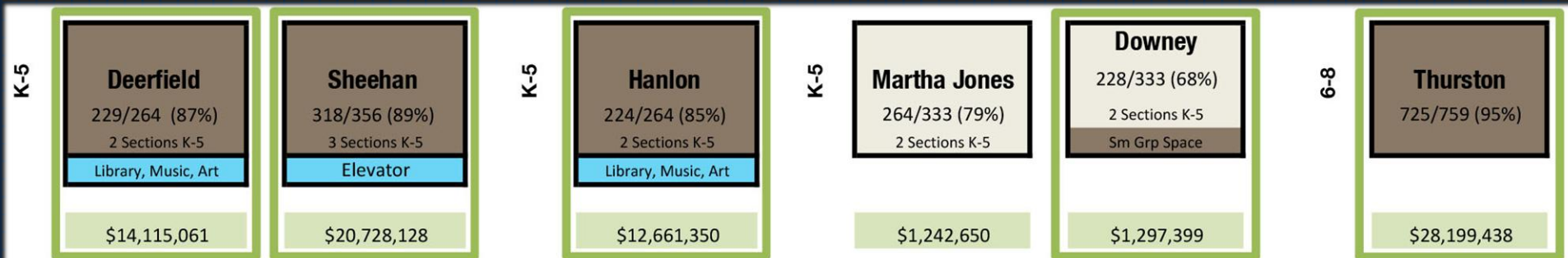

ELEMENTARY SCHOOLS



Existing Spaces Currently >25% Undersized- Based on Current MSBA Guidelines

Deerfield

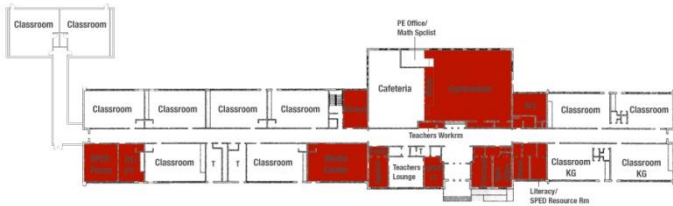

Sheehan

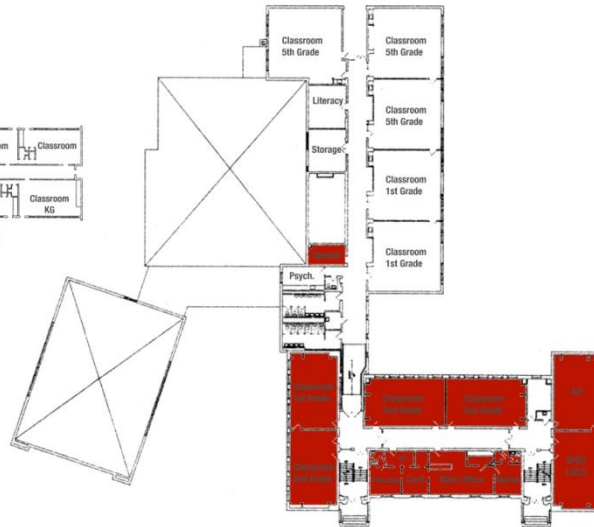

Hanlon

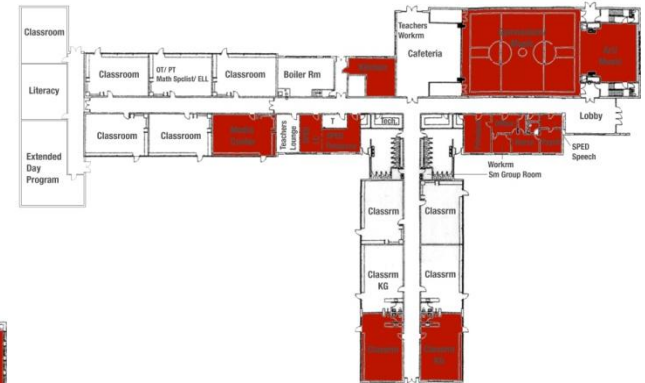

Satisfy Educational Program
Option B-1

ELEMENTARY SCHOOLS

- Major Renovations Including all scope From Option A-1
- Additions and interior renovations as required to support educational programming needs
 - Proper space for specialty and SPED programs
 - More small group and break-out spaces
 - Appropriate space for Media Center, Art and Music

Deerfield
Grades K-5
2 Sections

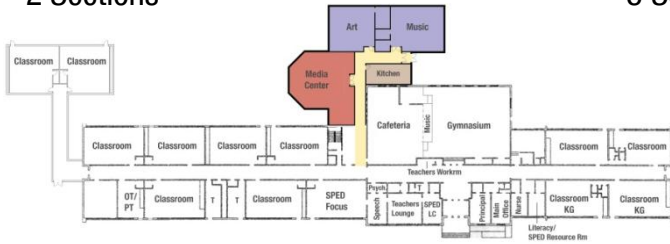

Sheehan
Grades K-5
3 Sections

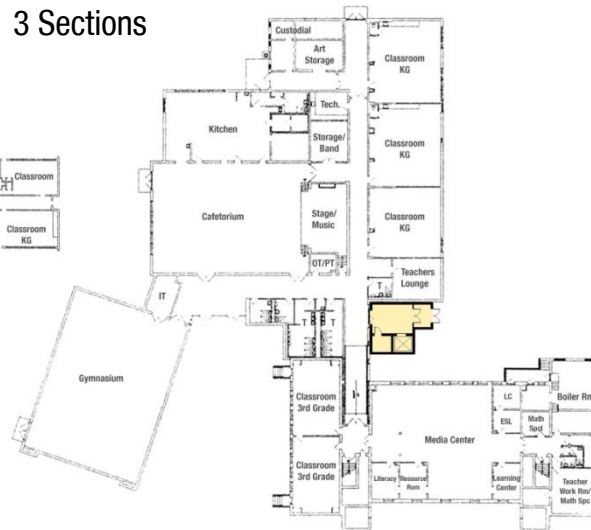

Hanlon
Grades K-5
2 Sections

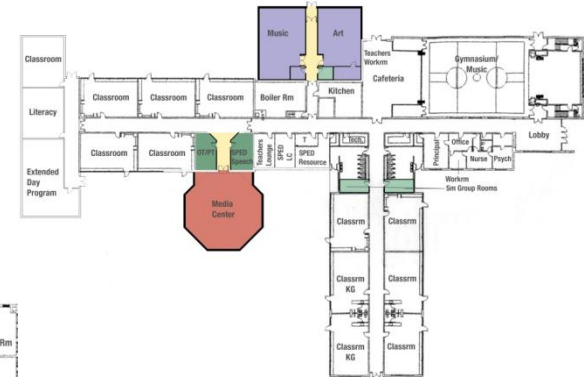

THURSTON MIDDLE SCHOOL

- *Major Renovations of existing building systems and infrastructure required*
- *Infrastructure upgrades will trigger full compliance with MAAB- Accessibility codes*
- *Interior fit-up renovations as required to accommodate educational programming needs*

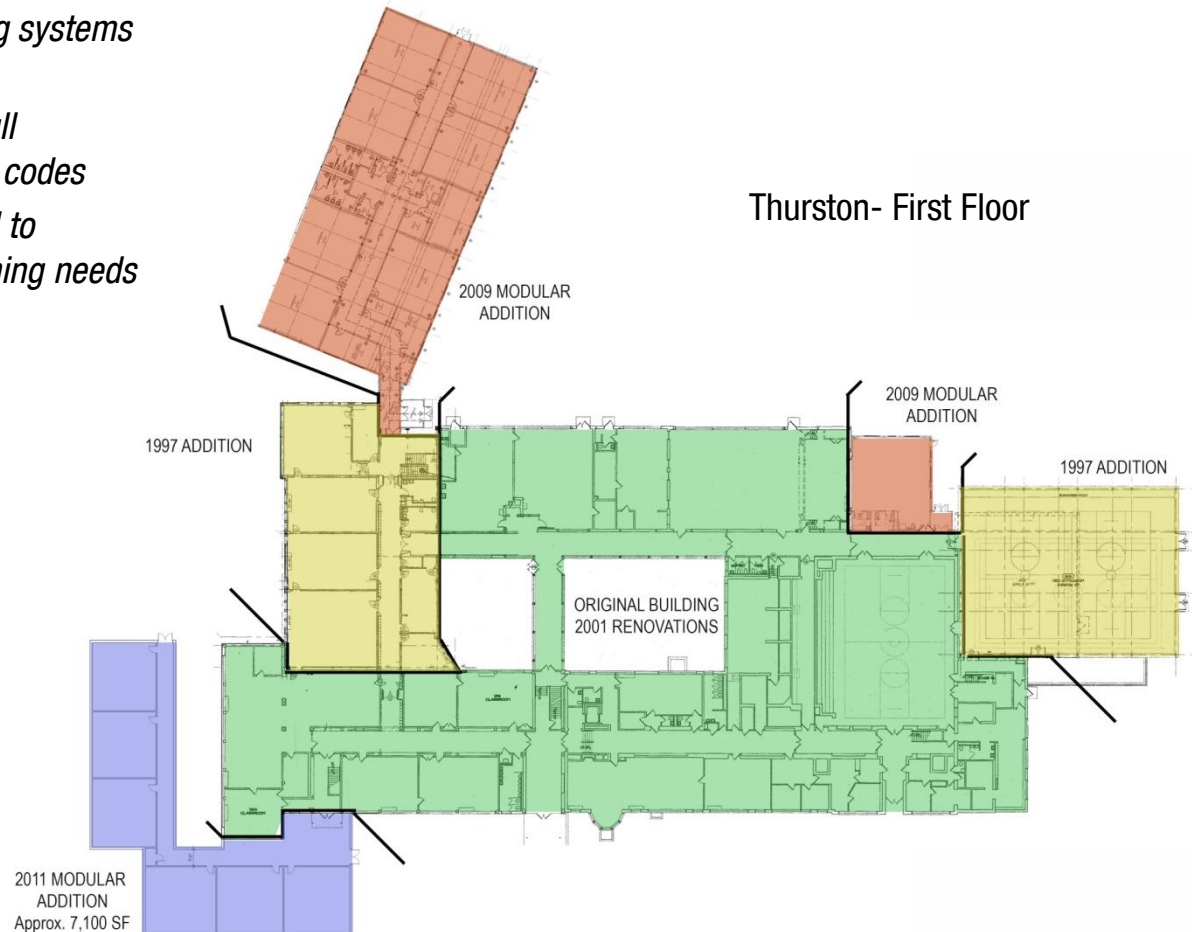

PROJECT COSTS- OPTION B-1

- **\$78,244,025** Total Project Costs- w/o MSBA Reimbursement

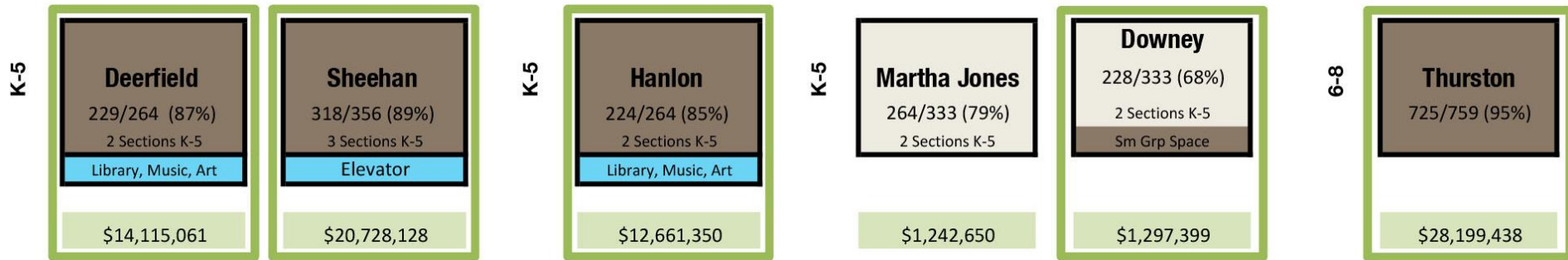

Satisfy Educational Program

Option B-3

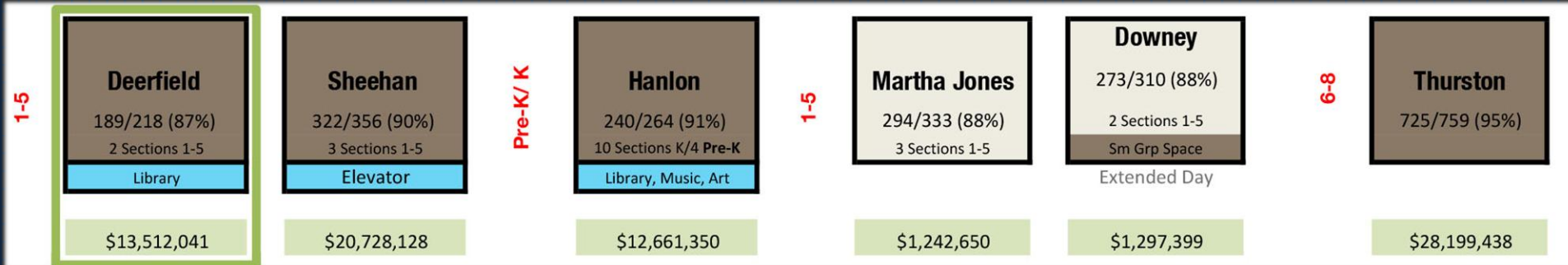

ELEMENTARY SCHOOLS

- *Redistricting Required*
- *Major Renovations Including all scope From Option A-1*
- *Additions and interior renovations as required to support educational programming needs*
 - *Proper space for specialty and SPED programs*
 - *More small group and break-out spaces*
 - *Appropriate space for Media Center, Art and Music*

Deerfield
Grades 1-5
2 Sections

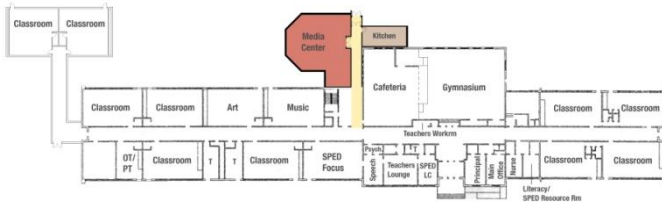

Sheehan
Grades 1-5
3 Sections

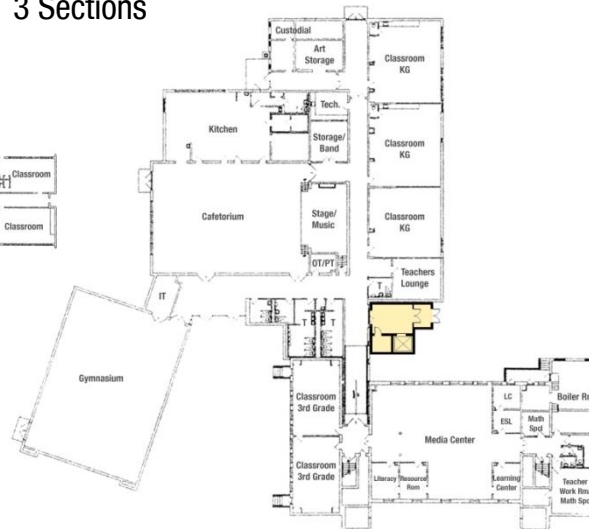

Hanlon
Grades Pre-K & K
10 Sections-K



PROJECT COSTS- OPTION B-3

- **\$77,641,005** Total Project Costs- w/o MSBA Reimbursement

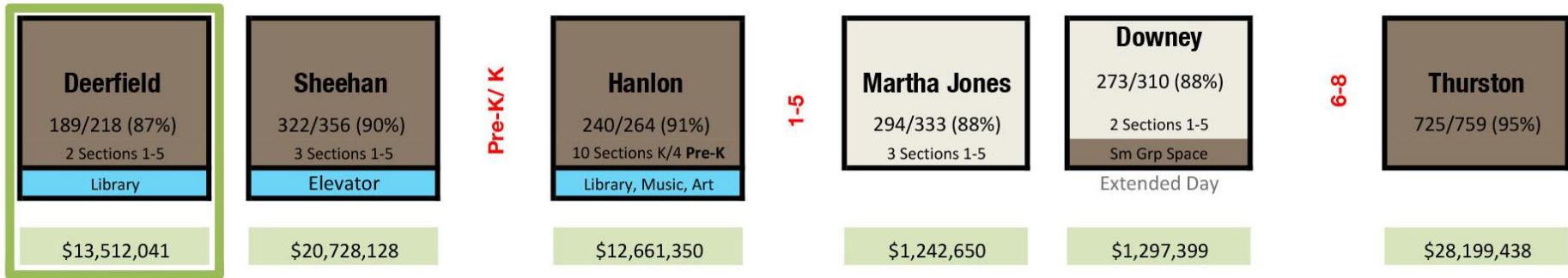

Consolidate Option C-1a

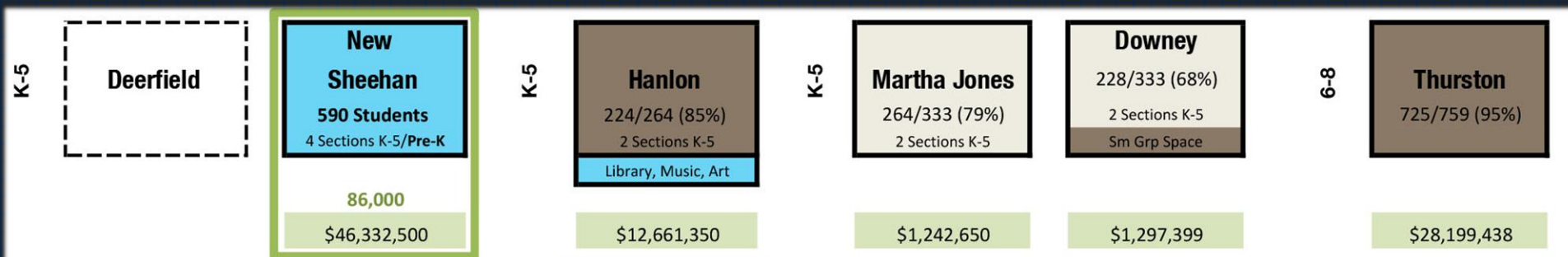

CONSOLIDATE

Deerfield Elementary
CLOSE

Sheehan Elementary
NEW BUILDING
540 Students + Pre-K

Hanlon Elementary
Major Renovation/ Additions



CONSOLIDATE

*Martha Jones Elementary
Minor System Upgrades*



*Downey Elementary
Minor System Upgrades
Minor Interior Fit-Up*



*Thurston Middle School
Major Renovation/ Additions*



PROJECT COSTS- OPTION C-1A

- **\$89,733,336** Total Project Cost- w/o MSBA Reimbursement

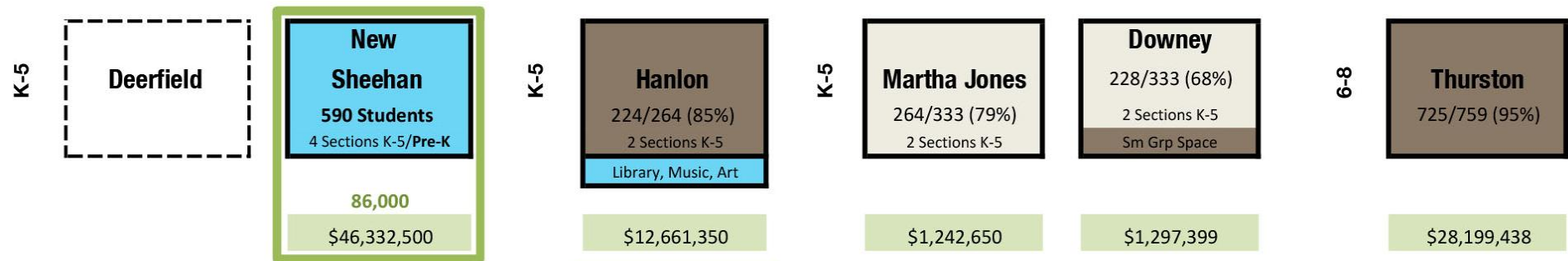

Consolidate Option C-1d

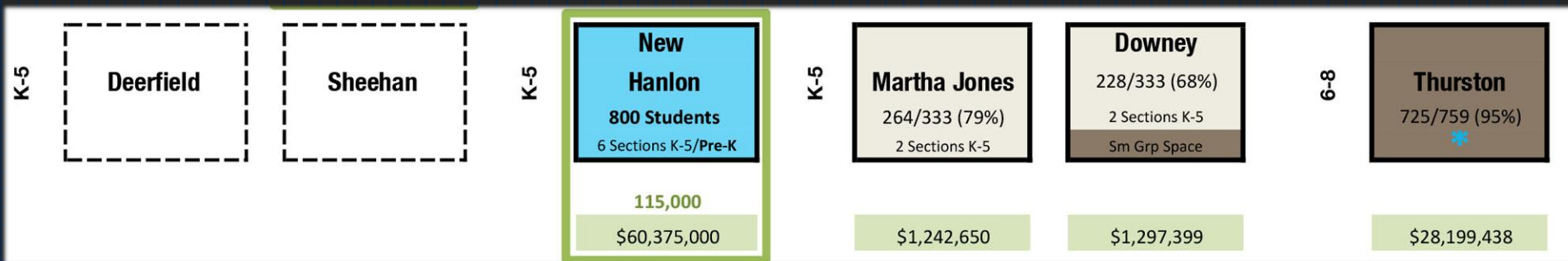

CONSOLIDATE

Deerfield Elementary
CLOSE

Sheehan Elementary
CLOSE

Hanlon Elementary
NEW BUILDING
800 Students + Pre-K



HANLON SITE

NEW BUILDING

800 Students + Pre-K

*Assumes Re-Districting of
Sheehan and Deerfield Sites
To New Hanlon School*

*Site Area with Greatest Potential
for Shallow Ledge*

*Demo Existing Building
New Parking*

New Hanlon School

Maintain Existing Fields



CONSOLIDATE

*Martha Jones Elementary
Minor System Upgrades*



*Downey Elementary
Minor System Upgrades
Minor Interior Fit-Up*



*Thurston Middle School
Major Renovation*



PROJECT COSTS- OPTION C-1D

- **\$91,114,486** Total Project Cost- w/o MSBA Reimbursement

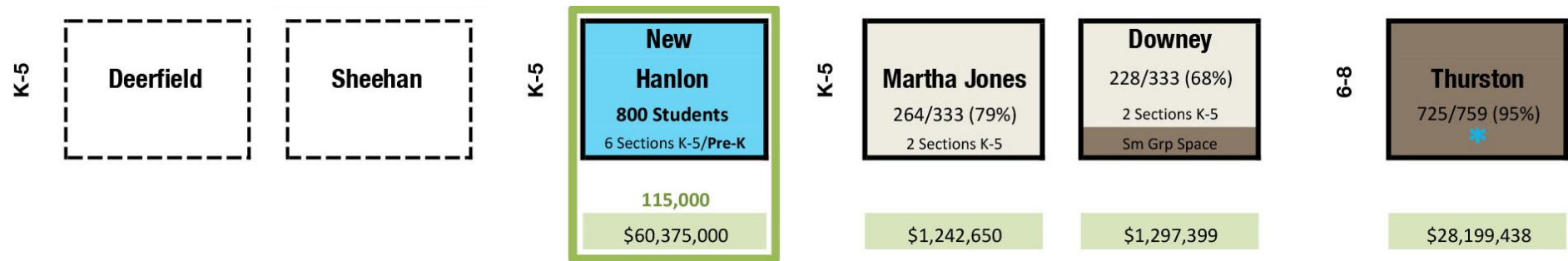

Consolidate Option C-1e

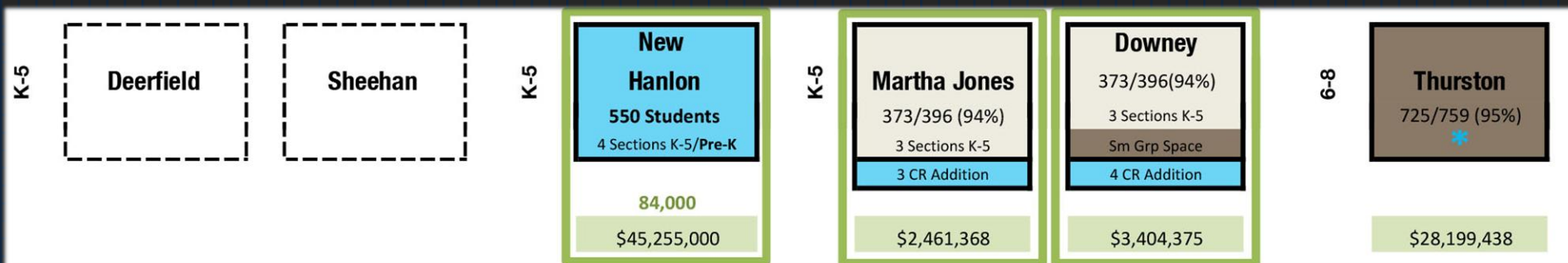

HANLON SITE

NEW BUILDING

540 Students + Pre-K

*Assumes Re-Districting of
All Districts*

*Site Area with Greatest Potential
for Shallow Ledge*

*Demo Existing Building
New Parking*

New Hanlon School

Maintain Existing Fields



CONSOLIDATE

Martha Jones Elementary
Minor System Upgrades
3 Classroom Addition

Downey Elementary
Minor System Upgrades
4 Classroom Addition

Thurston Middle School
Major Renovation



Consolidate
Option C-1e

SMMA

CONSOLIDATE

Martha Jones Elementary
Minor System Upgrades
3 Classroom Addition

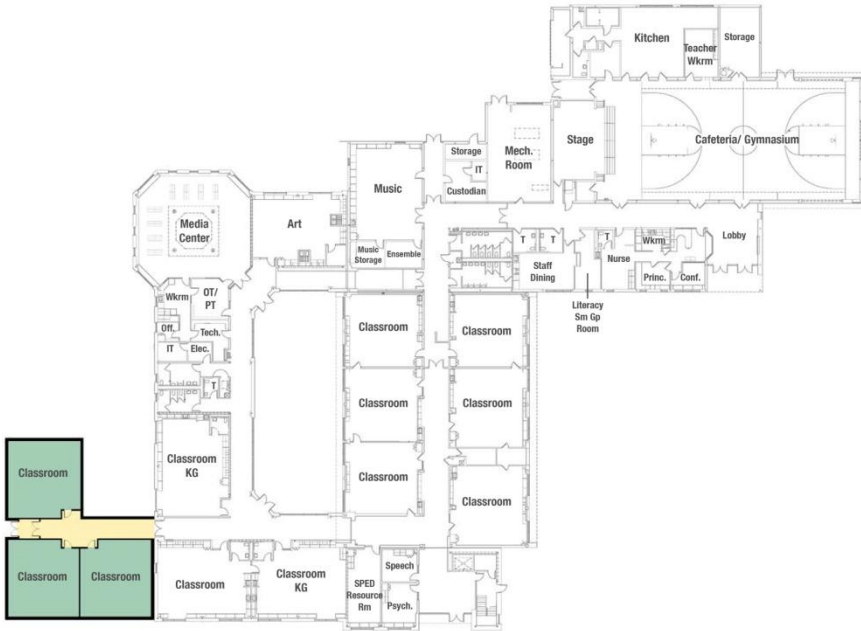

Downey Elementary
Minor System Upgrades
4 Classroom Addition

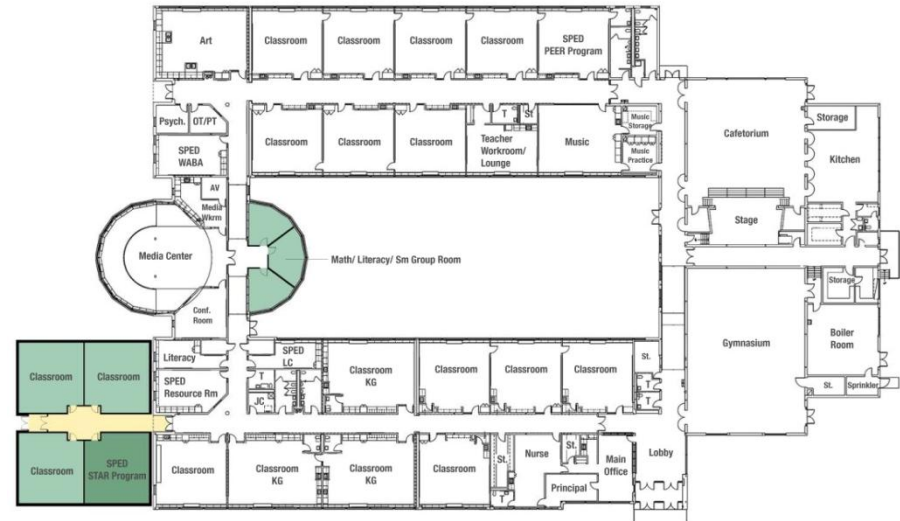

PROJECT COSTS- OPTION C-1E

- **\$79,320,180** Total Project Cost- w/o MSBA Reimbursement

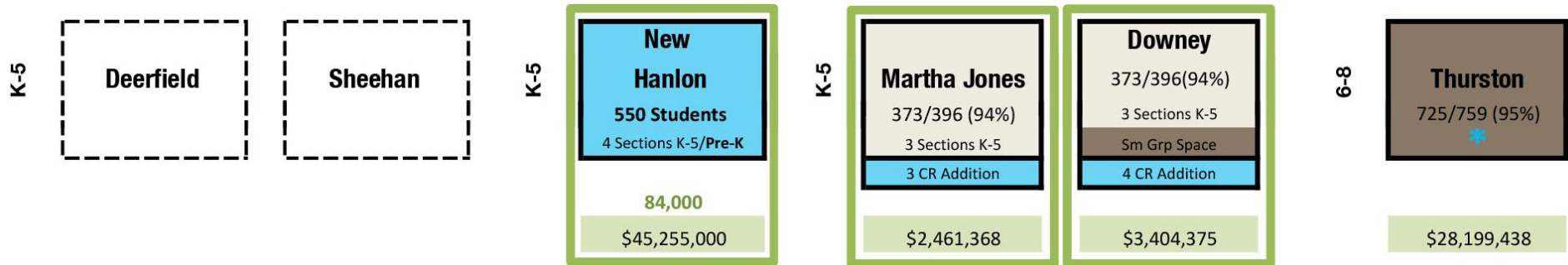

Chart of Master Plan Options

OPTIONS

Legend

Hanlon 224/264 (85%)
 Proposed Design Enrollment
 Proposed # of Sections
 Building Usage Percentage
 Total Building Capacity - Assume SPED/Art/Music per Current MSBA Guidelines
No Major Renovations or System Upgrades
Major Building Renovation and System Upgrades
Code and System Upgrades Only
Existing Building to be Closed and/or Demolished
New Additions/ Buildings
Varying Options for Pricing

Status Quo

Necessary Code and System Upgrades Only Including:
 Accessibility Upgrades
 Building Code Compliance
 MEP Systems Upgrades as Rqd
 Window Replacement as Rqd

Elementary Schools

Middle School

High School

Grand Totals per Options
 Project Costs

Option A-1

K-5	Deerfield 229/218 (105%) 2 Sections K-5 \$9,205,895	Sheehan 318/356 (89%) 3 Sections K-5 Elevator \$16,572,434	K-5	Hanlon 224/218 (103%) 2 Sections K-5 \$10,974,470	K-5	Martha Jones 264/333 (79%) 2 Sections K-5 \$1,242,650	Downey 228/333 (68%) 2 Sections K-5 \$1,194,430	6-8	Thurston 725/759 (95%) \$23,507,250	9-12	Westwood HS 970 \$0	Option A-1	\$62,697,129
-----	---	---	-----	---	-----	---	---	-----	--	------	----------------------------------	------------	--------------

Satisfy Educational Program

Necessary Code and System Upgrades, Renovations/Additions

Option B-1

K-5	Deerfield 229/264 (87%) 2 Sections K-5 Library, Music, Art \$14,115,061	Sheehan 318/356 (89%) 3 Sections K-5 Elevator \$20,728,128	K-5	Hanlon 224/264 (85%) 2 Sections K-5 Library, Music, Art \$12,661,350	K-5	Martha Jones 264/333 (79%) 2 Sections K-5 \$1,242,650	Downey 228/333 (68%) 2 Sections K-5 Sm Grp Space \$1,297,399	6-8	Thurston 725/759 (95%) \$28,199,438	9-12	Westwood HS 970 \$0	Option B-1	\$78,244,025
-----	--	---	-----	---	-----	---	---	-----	--	------	----------------------------------	------------	--------------

Option B-3

Redistricting
 Relocate Extended Day Program

1-5	Deerfield 189/218 (87%) 2 Sections 1-5 Library \$13,512,041	Sheehan 322/356 (90%) 3 Sections 1-5 Elevator \$20,728,128	Pre-K/K	Hanlon 240/264 (91%) 10 Sections K/4 Pre-K Library, Music, Art \$12,661,350	1-5	Martha Jones 294/333 (88%) 3 Sections 1-5 \$1,242,650	Downey 273/310 (88%) 2 Sections 1-5 Sm Grp Space Extended Day \$1,297,399	6-8	Thurston 725/759 (95%) \$28,199,438	9-12	Westwood HS 970 \$0	Option B-3	\$77,641,005
-----	--	---	---------	--	-----	---	---	-----	--	------	----------------------------------	------------	--------------

Consolidate

Necessary Code and System Upgrades, Renovations/Additions
 Redistricting, New Building(s)

Option C-1a

Four Elementary Schools
 Sheehan and Deerfield Districts Combined
 Hanlon, MJ, Downey Districts remain as is

K-5	Deerfield	New Sheehan 590 Students 4 Sections K-5/Pre-K 86,000 \$46,332,500	K-5	Hanlon 224/264 (85%) 2 Sections K-5 Library, Music, Art \$12,661,350	K-5	Martha Jones 264/333 (79%) 2 Sections K-5 \$1,242,650	Downey 228/333 (68%) 2 Sections K-5 Sm Grp Space \$1,297,399	6-8	Thurston 725/759 (95%) \$28,199,438	9-12	Westwood HS 970 \$0	Option C-1a	\$89,733,336
-----	--	--	-----	---	-----	---	---	-----	--	------	----------------------------------	-------------	--------------

Option C-1d

Three Elementary Schools
 Sheehan, Hanlon and Deerfield Districts Combined
 MJ, Downey Districts remain as is

K-5	Deerfield	Sheehan	K-5	New Hanlon 800 Students 6 Sections K-5/Pre-K 115,000 \$60,375,000	K-5	Martha Jones 264/333 (79%) 2 Sections K-5 \$1,242,650	Downey 228/333 (68%) 2 Sections K-5 Sm Grp Space \$1,297,399	6-8	Thurston 725/759 (95%) \$28,199,438	9-12	Westwood HS 970 \$0	Option C-1d	\$91,114,486
-----	--	--	-----	--	-----	---	---	-----	--	------	----------------------------------	-------------	--------------

Option C-1e

Three Elementary Schools
 Redistricting for Parity

K-5	Deerfield	Sheehan	K-5	New Hanlon 550 Students 4 Sections K-5/Pre-K 84,000 \$45,255,000	K-5	Martha Jones 373/396 (94%) 3 Sections K-5 3 CR Addition \$2,461,368	Downey 373/396 (94%) 3 Sections K-5 Sm Grp Space 4 CR Addition \$3,404,375	6-8	Thurston 725/759 (95%) \$28,199,438	9-12	Westwood HS 970 \$0	Option C-1e	\$79,320,180
-----	--	--	-----	---	-----	--	--	-----	--	------	----------------------------------	-------------	--------------

Questions?



Thank You

SMMA

SYMMES MAINI & McKEE ASSOCIATES