

**Westwood Public Schools**

**Hanlon Elementary  
School Building Project**

**Community Presentation**

**03.02.2020**



# Agenda

- **Overview & Process**
- **Summary of Work to Date**
- **Options Review**
- **Evaluation Process**
- **Questions + Comments**
- **Next Steps**
- **Exit Survey**

# School Building Project

## Process Update / Overview

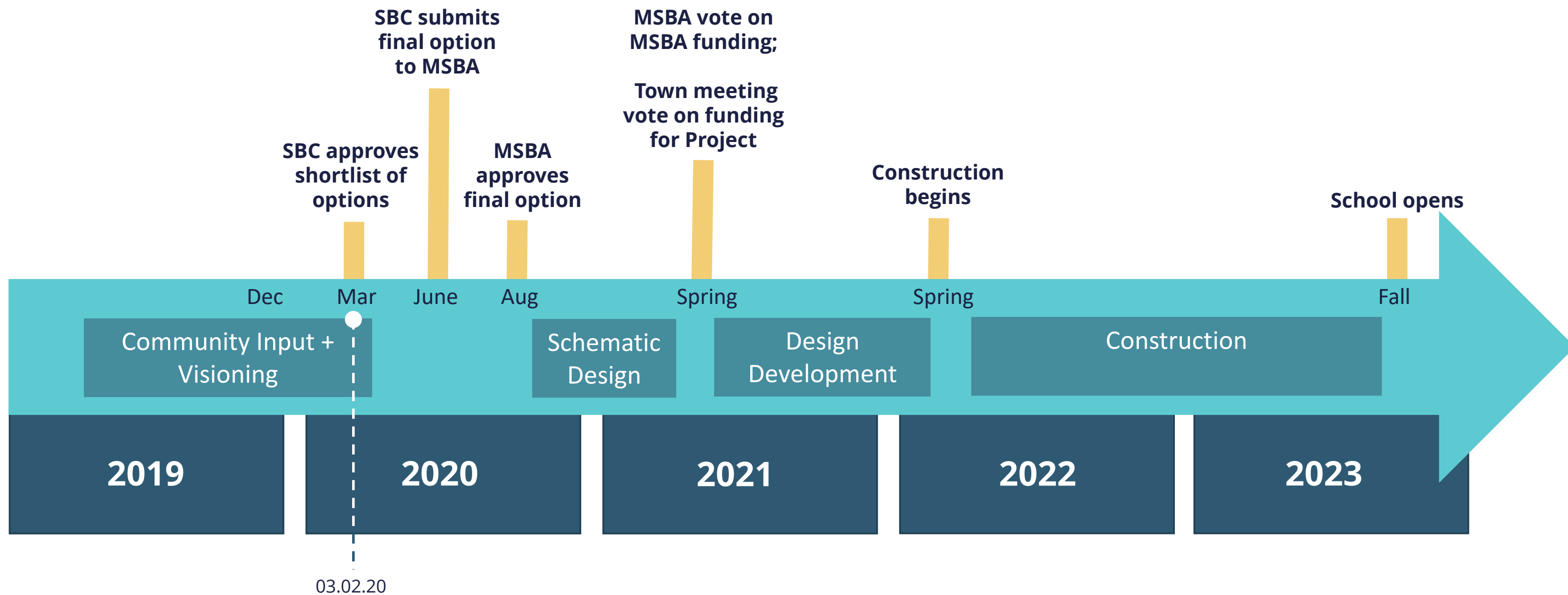

# Summary of Work to Date

- ❑ **Site + Building Assessments** (Hanlon, Deerfield, Sheehan)
- ❑ **Educational Planning**
  - **Principal Interviews & Educational Walk-thrus**
  - **Faculty & Staff Visioning Workshop**
  - **Principals' Workshops (3)**
  - **School Tours** (Needham, Millis, Milford)
- ❑ **Community Outreach**
  - **Community Meetings (9)**
  - **Board of Selectmen**
- ❑ **Options Development**



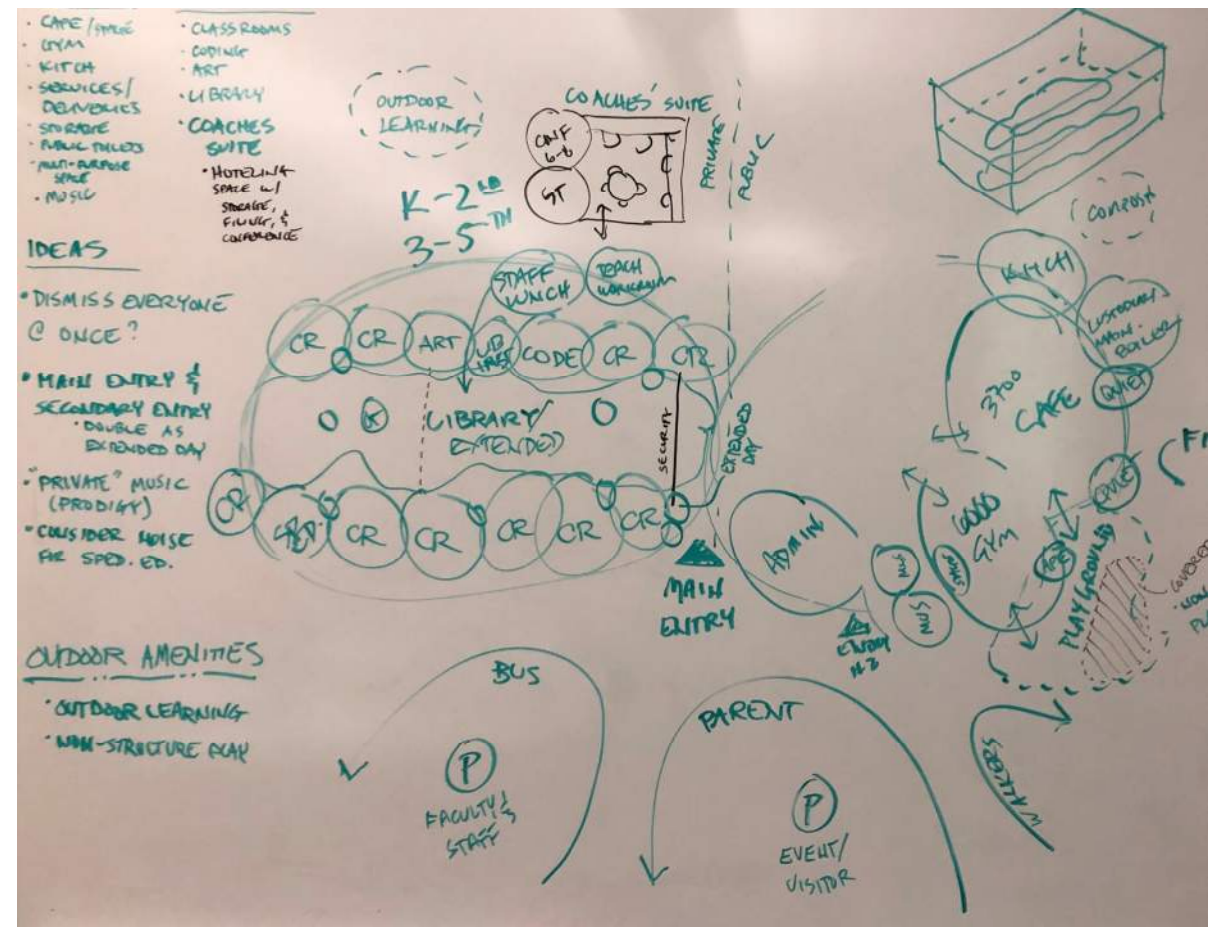



# Options Review

Hanlon only  
315 students

Hanlon + Deerfield  
560 students

Hanlon + Sheehan  
685 students

Reno

Add/  
Reno

New

Add/  
Reno

New

Add/  
Reno

New

1	RO-HO.1	2	AR-HO-H.1	6	NHO-H.1
---	---------	---	-----------	---	---------

3	AR-HD-H.2
---	-----------

7	NHD-H.1
---	---------

4	AR-HS-H.3
---	-----------

11	NHS-H.1
----	---------

8	NHD-H.2
---	---------

5	AR-HS-S.1
---	-----------

12	NHS-H.2
----	---------

9	NHD-H.3
---	---------

13	NHS-S.1
----	---------

10	NHD-H.3
----	---------

14	NHS-S.2
----	---------

15	NHS-S.3
----	---------

# Hanlon Only – 315 Students

**1** Base Repair @ Hanlon

**2** Add/Reno @ Hanlon

**6** All New @ Hanlon

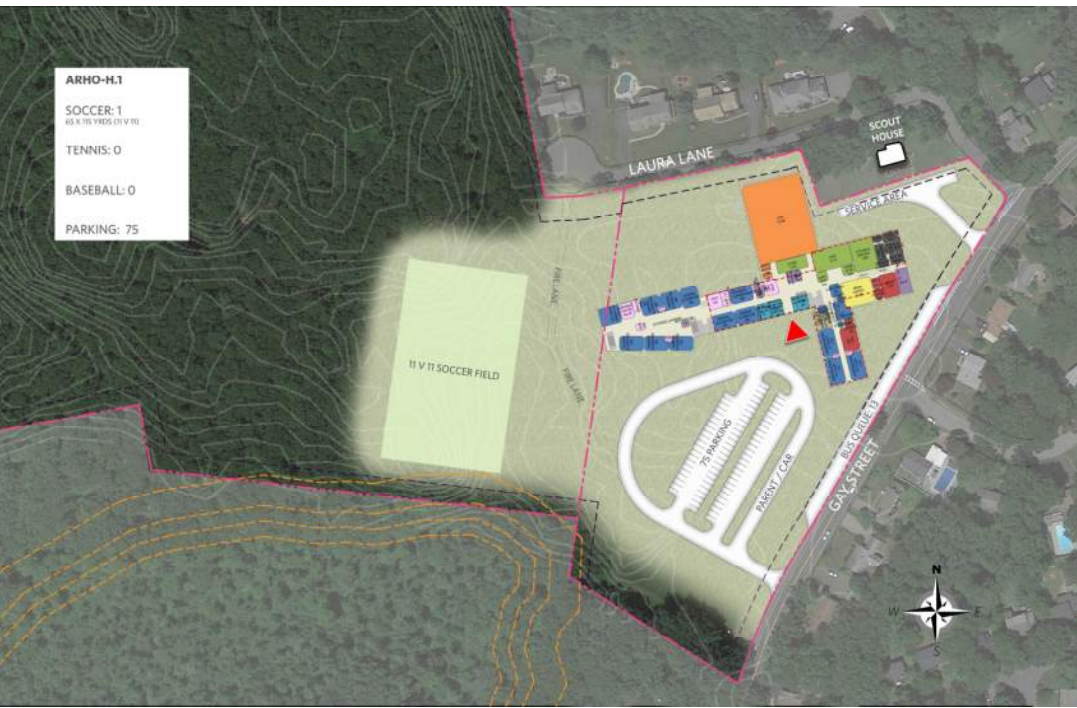
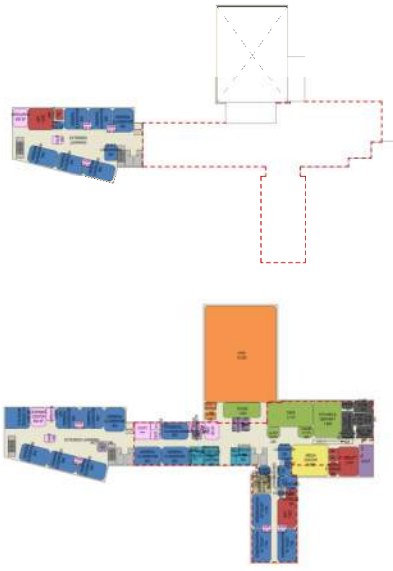



# Hanlon Deerfield – 560 Students

## 3 Add/Reno @ Hanlon

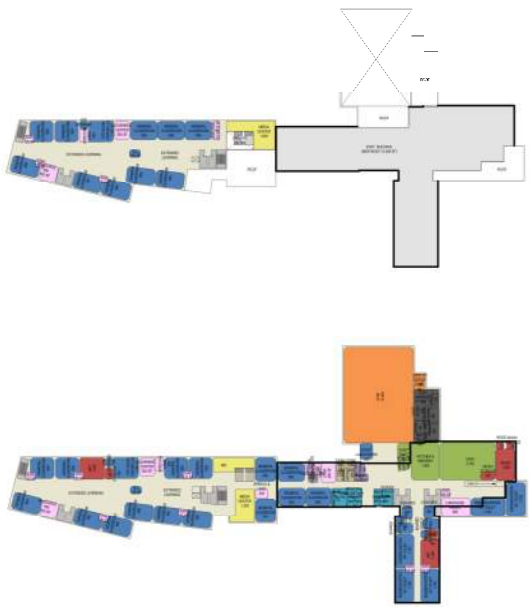

## 7 All New @ Hanlon



## 8 All New @ Hanlon





# Hanlon Deerfield – 560 Students

# Hanlon Sheehan 685 Students

## 9 All New @ Hanlon

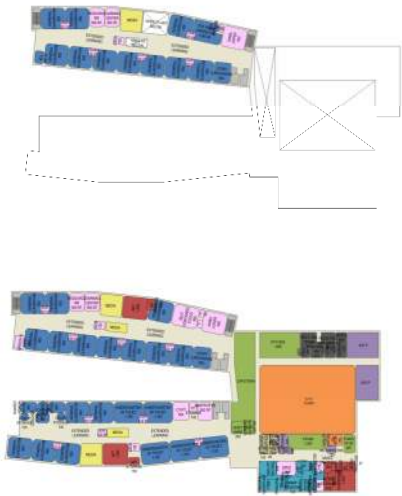

## 10 All New @ Hanlon



## 4 Add/Reno @ Hanlon

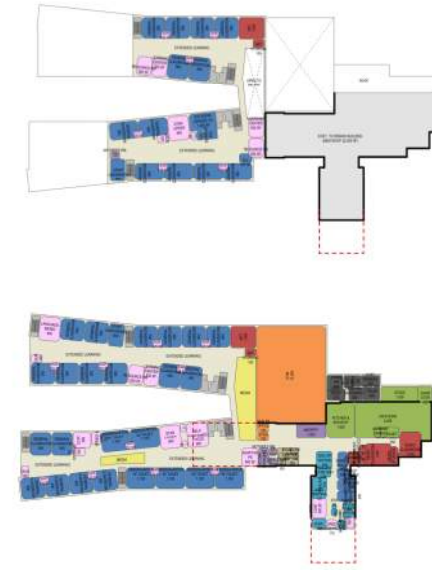



# Hanlon Sheehan - 685 Students

**5** Add/Reno @ Sheehan



**11** All New @ Hanlon

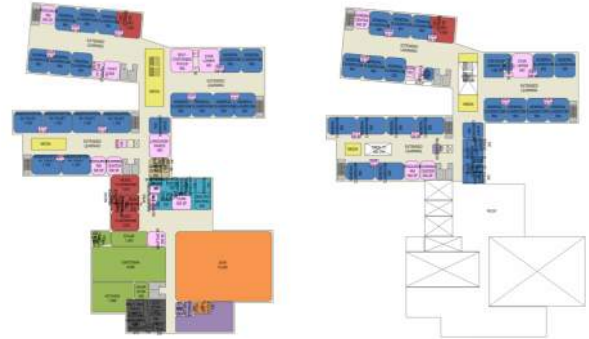

**12** All New @ Hanlon

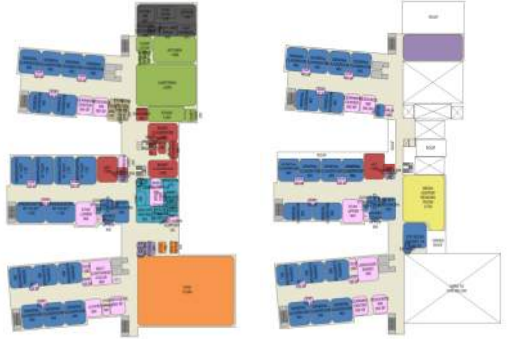



# Hanlon Sheehan - 685 Students

**13** All New @ Sheehan

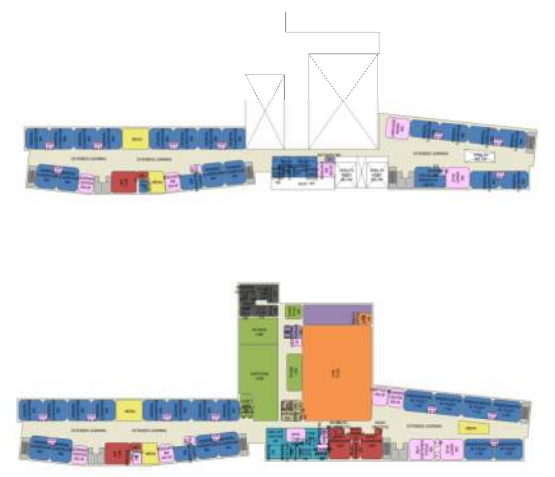

**14** All New @ Sheehan



**15** All New @ Sheehan

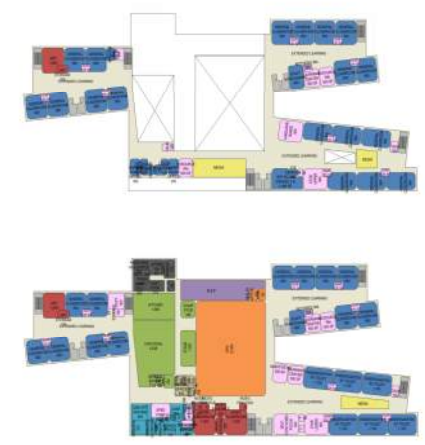



# Evaluation Process

# Scenarios

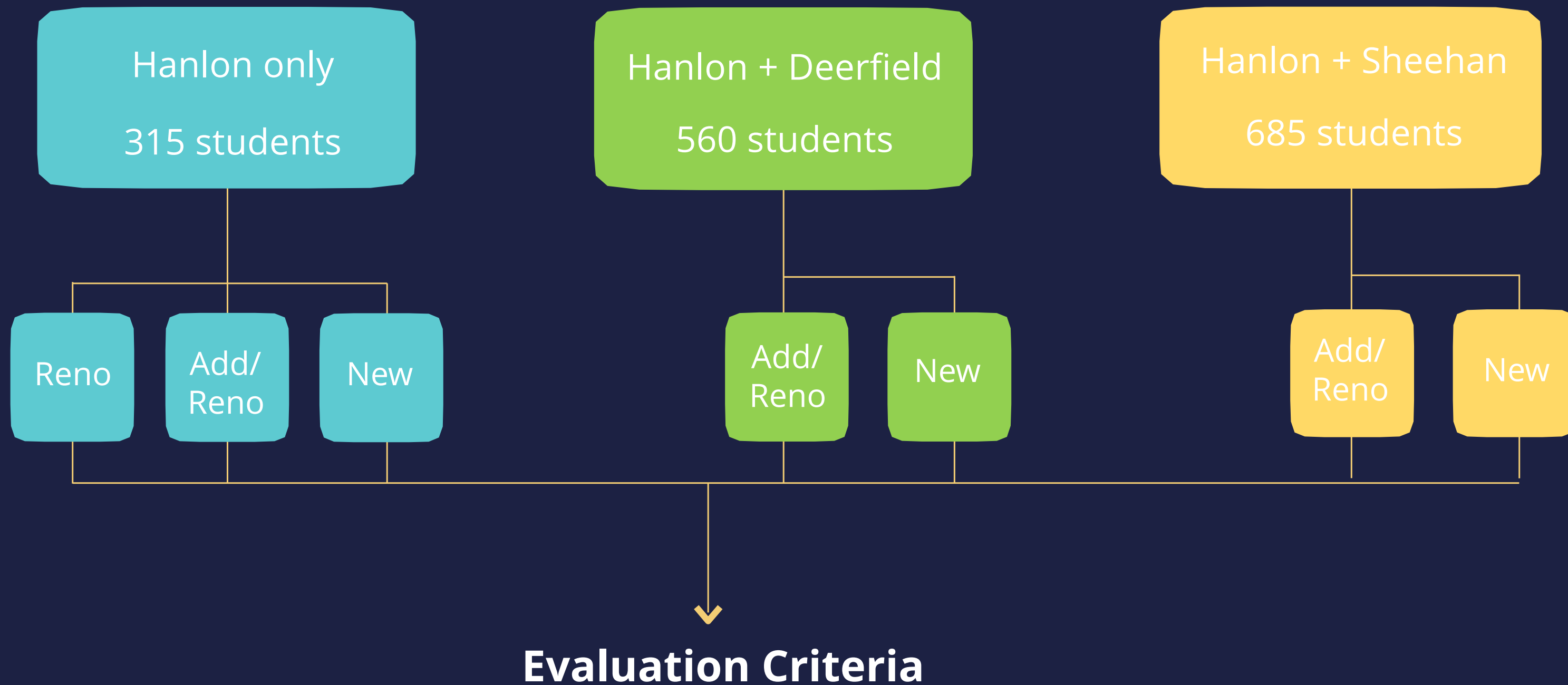



# Evaluation Criteria

## Categories

- **Education**
  - **Site Traffic**
  - **Community**
  - **Sustainability**
  - **Logistics / Construction Impact**
- 
- **Costs**

# Evaluation Criteria

## Developing the criteria

**Education:** How well does the option:

- meet the educational goals of Westwood?

**Community:** To what extent does the option:

- provide benefits to the community, such as sports fields, community space, and gym space?

**Site:** How well does the option:

- maximize on-site parking,
- allow for efficient drop off circulation
- provide access to parking for sports fields?

**Sustainability:** How well does the option:

- align with the sustainability goals of the town?

**Traffic:** What is the impact of:

- the project to the traffic in the neighborhood and the town?

**Logistics/Construction**

**Impact:** What is the impact to:

- the students on the project site during construction?  
How difficult is the phasing/site logistics?

**Cost:** How do costs compare:

- in relation to cost per student?

### Westwood Hanlon Elementary School Evaluation Criteria

2/10/2020

1 2 3 4 5 6 7 8 9 10 11 12 13 14 15

	RO-H.1	AR-HO-H.1	AR-HD-H.2	AR-HS-H.3	AR-HS-S.1	NHO-H.1	NHD-H.1	NHD-H.2	NHD-H.3	NHD-H.4	NHS-H.1	NHS-H.2	NHS-S.1	NHS-S.2	NHS-S.3
type	Reno	Add-Reno	Add-Reno	Add-Reno	Add-Reno	New	New	New	New	New	New	New	New	New	New
size	Hanlon Only 315	Hanlon Only 315	Hanlon-Deerfield 560	Hanlon Sheehan 685	Hanlon Sheehan 685	Hanlon Only 315	Hanlon Deerfield 560	Hanlon Deerfield 560	Hanlon Deerfield 560	Hanlon Deerfield 560	Hanlon Sheehan 685	Hanlon Sheehan 685	Hanlon Sheehan 685	Hanlon Sheehan 685	Hanlon Sheehan 685
location	Hanlon	Hanlon	Hanlon	Hanlon	Sheehan	Hanlon	Hanlon	Hanlon	Hanlon	Hanlon	Hanlon	Hanlon	Sheehan	Sheehan	Sheehan
A Education	1	2	2	4	4	4	5	4	4	5	5	5	4	4	5
B Site	1	4	4	4	2	5	5	5	5	5	5	5	2	3	3
C Traffic	2	4	4	2	1	5	4	4	4	4	2	2	1	1	1
D Community	1	3	3	4	2	5	5	5	5	5	5	5	2	2	2
E Sustainability	1	3	3	4	4	5	5	5	5	5	5	5	5	5	5
F Logistics / Construction Impact	1	1	2	2	1	4	4	4	4	4	4	4	2	2	2



5

4

3

2

1



Best	Better	Good	Fair	Poor
------	--------	------	------	------

**Westwood Hanlon Elementary School Evaluation Criteria**

2/10/2020		1	2	3	4	5	6	7	8	9	10	11	12	13	14	15
	RO-H.1	AR-HO-H.1	AR-HD-H.2	AR-HS-H.3	AR-HS-S.1	NHO-H.1	NHD-H.1	NHD-H.2	NHD-H.3	NHD-H.4	NHS-H.1	NHS-H.2	NHS-S.1	NHS-S.2	NHS-S.3	
type	Reno	Add-Reno	Add-Reno	Add-Reno	Add-Reno	New	New	New	New	New	New	New	New	New	New	
size	Hanlon Only 315	Hanlon Only 315	Hanlon-Deerfield 560	Hanlon Sheehan 685	Hanlon Sheehan 685	Hanlon Only 315	Hanlon Deerfield 560	Hanlon Deerfield 560	Hanlon Deerfield 560	Hanlon Deerfield 560	Hanlon Sheehan 685	Hanlon Sheehan 685	Hanlon Sheehan 685	Hanlon Sheehan 685	Hanlon Sheehan 685	
location	Hanlon	Hanlon	Hanlon	Hanlon	Sheehan	Hanlon	Hanlon	Hanlon	Hanlon	Hanlon	Hanlon	Hanlon	Sheehan	Sheehan	Sheehan	
<b>A</b>	<b>Education</b>	1	2	2	4	4	4	5	4	4	5	5	4	4	5	
B	Site	1	4	4	4	2	5	5	5	5	5	5	2	3	3	
C	Traffic	2	4	4	2	1	5	4	4	4	2	2	1	1	1	
D	Community	1	3	3	4	2	5	5	5	5	5	5	2	2	2	
E	Sustainability	1	3	3	4	4	5	5	5	5	5	5	5	5	5	
F	Logistics / Construction Impact	1	1	2	2	1	4	4	4	4	4	4	2	2	2	

# Westwood Hanlon Elementary School Evaluation Criteria

Best	Better	Good	Fair	Poor
------	--------	------	------	------

	2/10/2020	1	2	3	4	5	6	7	8	9	10	11	12	13	14	15
	RO-H.1	AR-HO-H.1	AR-HD-H.2	AR-HS-H.3	AR-HS-S.1	NHO-H.1	NHD-H.1	NHD-H.2	NHD-H.3	NHD-H.4	NHS-H.1	NHS-H.2	NHS-S.1	NHS-S.2	NHS-S.3	
type	Reno	Add-Reno	Add-Reno	Add-Reno	Add-Reno	New	New	New	New	New	New	New	New	New	New	
size	Hanlon Only 315	Hanlon Only 315	Hanlon-Deerfield	Hanlon Sheehan 685	Hanlon Sheehan 685	Hanlon Only 315	Hanlon Deerfield	Hanlon Deerfield	Hanlon Deerfield 560	Hanlon Deerfield 560	Hanlon Sheehan 685	Hanlon Sheehan 685	Hanlon Sheehan 685	Hanlon Sheehan 685	Hanlon Sheehan 685	
location	Hanlon	Hanlon	Hanlon	Hanlon	Sheehan	Hanlon	Hanlon	Hanlon	Hanlon	Hanlon	Hanlon	Hanlon	Sheehan	Sheehan	Sheehan	
<b>A</b>	<b>Education</b>	1	2	2	4	4	4	5	4	4	5	5	5	4	4	5
<b>B</b>	Site	1	4	4	4	2	5	5	5	5	5	5	2	3	3	3
<b>C</b>	Traffic	2	4	4	2	1	5	4	4	4	4	2	2	1	1	1
<b>D</b>	Community	1	3	3	4	2	5	5	5	5	5	5	2	2	2	2
<b>E</b>	Sustainability	1	3	3	4	4	5	5	5	5	5	5	5	5	5	5
<b>F</b>	Logistics / Construction Impact	1	1	2	2	1	4	4	4	4	4	4	4	2	2	2

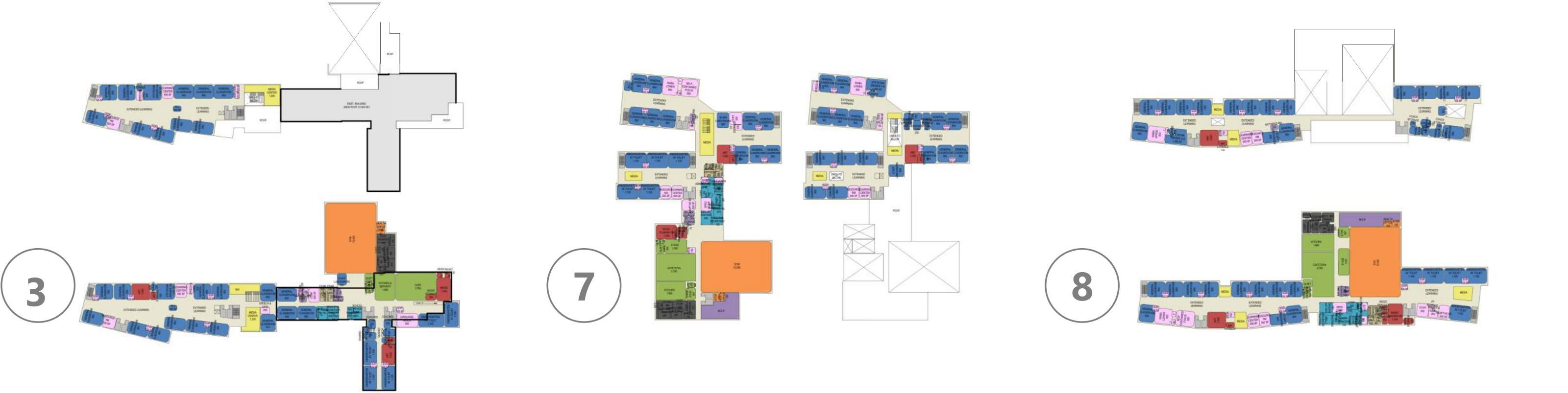



Best	Better	Good	Fair	Poor
------	--------	------	------	------

**Westwood Hanlon Elementary School Evaluation Criteria**

	2/10/2020	1	2	3	4	5	6	7	8	9	10	11	12	13	14	15
	RO-H.1	AR-HO-H.1	AR-HD-H.2	AR-HS-H.3	AR-HS-S.1	NHO-H.1	NHD-H.1	NHD-H.2	NHD-H.3	NHD-H.4	NHS-H.1	NHS-H.2	NHS-S.1	NHS-S.2	NHS-S.3	
type	Reno	Add-Reno	Add-Reno	Add-Reno	Add-Reno	New	New	New	New	New	New	New	New	New	New	
size	Hanlon Only 315	Hanlon Only 315	Hanlon-Deerfield 560	Hanlon Sheehan 685	Hanlon Sheehan 685	Hanlon Only 315	Hanlon Deerfield 560	Hanlon Deerfield 560	Hanlon Deerfield 560	Hanlon Deerfield 560	Hanlon Sheehan 685	Hanlon Sheehan 685	Hanlon Sheehan 685	Hanlon Sheehan 685	Hanlon Sheehan 685	
location	Hanlon	Hanlon	Hanlon	Hanlon	Sheehan	Hanlon	Hanlon	Hanlon	Hanlon	Hanlon	Hanlon	Hanlon	Sheehan	Sheehan	Sheehan	
A	Education	1	2	2	4	4	4	5	4	4	5	5	5	4	4	5
B	Site	1	4	4	4	2	5	5	5	5	5	5	5	2	3	3
C	Traffic	2	4	4	2	1	5	4	4	4	4	2	2	1	1	1
D	Community	1	3	3	4	2	5	5	5	5	5	5	5	2	2	2
E	Sustainability	1	3	3	4	4	5	5	5	5	5	5	5	5	5	5
F	Logistics / Construction Impact	1	1	2	2	1	4	4	4	4	4	4	4	2	2	2

# Westwood Hanlon Elementary School Evaluation Criteria

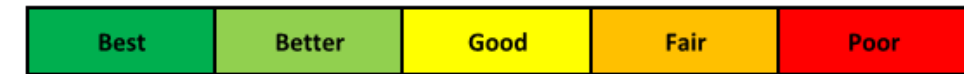

	2/10/2020	1	2	3	4	5	6	7	8	9	10	11	12	13	14	15
	RO-H.1	AR-HO-H.1	AR-HD-H.2	AR-HS-H.3	AR-HS-S.1	NHO-H.1	NHD-H.1	NHD-H.2	NHD-H.3	NHD-H.4	NHS-H.1	NHS-H.2	NHS-S.1	NHS-S.2	NHS-S.3	
type	Reno	Add-Reno	Add-Reno	Add-Reno	Add-Reno	New	New	New	New	New	New	New	New	New	New	
size	Hanlon Only 315	Hanlon Only 315	Hanlon-Deerfield 560	Hanlon Sheehan 685	Hanlon Sheehan 685	Hanlon Only 315	Hanlon Deerfield 560	Hanlon Deerfield 560	Hanlon Deerfield 560	Hanlon Deerfield 560	Hanlon Sheehan 685	Hanlon Sheehan 685	Hanlon Sheehan 685	Hanlon Sheehan 685	Hanlon Sheehan 685	
location	Hanlon	Hanlon	Hanlon	Hanlon	Sheehan	Hanlon	Hanlon	Hanlon	Hanlon	Hanlon	Hanlon	Hanlon	Sheehan	Sheehan	Sheehan	
A Education	1	2	2	4	4	4	5	4	4	5	5	5	4	4	5	
<b>B Site</b>	<b>1</b>	<b>4</b>	<b>4</b>	<b>4</b>	<b>2</b>	<b>5</b>	<b>5</b>	<b>5</b>	<b>5</b>	<b>5</b>	<b>5</b>	<b>5</b>	<b>2</b>	<b>3</b>	<b>3</b>	
C Traffic	2	4	4	2	1	5	4	4	4	4	2	2	1	1	1	
D Community	1	3	3	4	2	5	5	5	5	5	5	5	2	2	2	
E Sustainability	1	3	3	4	4	5	5	5	5	5	5	5	5	5	5	
F Logistics / Construction Impact	1	1	2	2	1	4	4	4	4	4	4	4	2	2	2	





Best	Better	Good	Fair	Poor
------	--------	------	------	------

**Westwood Hanlon Elementary School Evaluation Criteria**

	2/10/2020	1	2	3	4	5	6	7	8	9	10	11	12	13	14	15
	RO-H.1	AR-HO-H.1	AR-HD-H.2	AR-HS-H.3	AR-HS-S.1	NHO-H.1	NHD-H.1	NHD-H.2	NHD-H.3	NHD-H.4	NHS-H.1	NHS-H.2	NHS-S.1	NHS-S.2	NHS-S.3	
type	Reno	Add-Reno	Add-Reno	Add-Reno	Add-Reno	New	New	New	New	New	New	New	New	New	New	
size	Hanlon Only 315	Hanlon Only 315	Hanlon-Deerfield 560	Hanlon Sheehan 685	Hanlon Sheehan 685	Hanlon Only 315	Hanlon Deerfield 560	Hanlon Deerfield 560	Hanlon Deerfield 560	Hanlon Deerfield 560	Hanlon Sheehan 685	Hanlon Sheehan 685	Hanlon Sheehan 685	Hanlon Sheehan 685	Hanlon Sheehan 685	
location	Hanlon	Hanlon	Hanlon	Hanlon	Sheehan	Hanlon	Hanlon	Hanlon	Hanlon	Hanlon	Hanlon	Hanlon	Sheehan	Sheehan	Sheehan	
A	Education	1	2	2	4	4	4	5	4	4	5	5	5	4	4	5
B	Site	1	4	4	4	2	5	5	5	5	5	5	5	2	3	3
C	Traffic	2	4	4	2	1	5	4	4	4	4	2	2	1	1	1
D	Community	1	3	3	4	2	5	5	5	5	5	5	5	2	2	2
E	Sustainability	1	3	3	4	4	5	5	5	5	5	5	5	5	5	5
F	Logistics / Construction Impact	1	1	2	2	1	4	4	4	4	4	4	4	2	2	2

# Westwood Hanlon Elementary School Evaluation Criteria

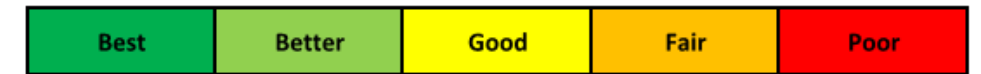

2/10/2020		1	2	3	4	5	6	7	8	9	10	11	12	13	14	15
	RO-H.1	AR-HO-H.1	AR-HD-H.2	AR-HS-H.3	AR-HS-S.1	NHO-H.1	NHD-H.1	NHD-H.2	NHD-H.3	NHD-H.4	NHS-H.1	NHS-H.2	NHS-S.1	NHS-S.2	NHS-S.3	
type	Reno	Add-Reno	Add-Reno	Add-Reno	Add-Reno	New	New	New	New	New	New	New	New	New	New	
size	Hanlon Only 315	Hanlon Only 315	Hanlon-Deerfield 560	Hanlon Sheehan 685	Hanlon Sheehan 685	Hanlon Only 315	Hanlon Deerfield 560	Hanlon Deerfield 560	Hanlon Deerfield 560	Hanlon Deerfield 560	Hanlon Sheehan 685	Hanlon Sheehan 685	Hanlon Sheehan 685	Hanlon Sheehan 685	Hanlon Sheehan 685	
location	Hanlon	Hanlon	Hanlon	Hanlon	Sheehan	Hanlon	Hanlon	Hanlon	Hanlon	Hanlon	Hanlon	Hanlon	Sheehan	Sheehan	Sheehan	
A	Education	1	2	2	4	4	4	5	4	4	5	5	4	4	5	
B	Site	1	4	4	4	2	5	5	5	5	5	5	2	3	5	
C	Traffic	2	4	4	2	1	5	4	4	4	4	2	2	1	1	1
D	Community	1	3	3	4	2	5	5	5	5	5	5	2	2	2	
E	Sustainability	1	3	3	4	4	5	5	5	5	5	5	5	5	5	
F	Logistics / Construction Impact	1	1	2	2	1	4	4	4	4	4	4	2	2	2	





Best	Better	Good	Fair	Poor
------	--------	------	------	------

**Westwood Hanlon Elementary School Evaluation Criteria**

	2/10/2020	1	2	3	4	5	6	7	8	9	10	11	12	13	14	15
	RO-H.1	AR-HO-H.1	AR-HD-H.2	AR-HS-H.3	AR-HS-S.1	NHO-H.1	NHD-H.1	NHD-H.2	NHD-H.3	NHD-H.4	NHS-H.1	NHS-H.2	NHS-S.1	NHS-S.2	NHS-S.3	
type	Reno	Add-Reno	Add-Reno	Add-Reno	Add-Reno	New	New	New	New	New	New	New	New	New	New	
size	Hanlon Only 315	Hanlon Only 315	Hanlon-Deerfield 560	Hanlon Sheehan 685	Hanlon Sheehan 685	Hanlon Only 315	Hanlon Deerfield 560	Hanlon Deerfield 560	Hanlon Deerfield 560	Hanlon Deerfield 560	Hanlon Sheehan 685	Hanlon Sheehan 685	Hanlon Sheehan 685	Hanlon Sheehan 685	Hanlon Sheehan 685	
location	Hanlon	Hanlon	Hanlon	Hanlon	Sheehan	Hanlon	Hanlon	Hanlon	Hanlon	Hanlon	Hanlon	Hanlon	Sheehan	Sheehan	Sheehan	
A	Education	1	2	2	4	4	4	5	4	4	5	5	5	4	4	5
B	Site	1	4	4	4	2	5	5	5	5	5	5	5	2	3	3
C	Traffic	2	4	4	2	1	5	4	4	4	4	2	2	1	1	1
D	<b>Community</b>	<b>1</b>	<b>3</b>	<b>3</b>	<b>4</b>	<b>2</b>	<b>5</b>	<b>5</b>	<b>5</b>	<b>5</b>	<b>5</b>	<b>5</b>	<b>5</b>	<b>2</b>	<b>2</b>	<b>2</b>
E	Sustainability	1	3	3	4	4	5	5	5	5	5	5	5	5	5	5
F	Logistics / Construction Impact	1	1	2	2	1	4	4	4	4	4	4	4	2	2	2

# Westwood Hanlon Elementary School Evaluation Criteria



	2/10/2020	1	2	3	4	5	6	7	8	9	10	11	12	13	14	15
	RO-H.1	AR-HO-H.1	AR-HD-H.2	AR-HS-H.3	AR-HS-S.1	NHO-H.1	NHD-H.1	NHD-H.2	NHD-H.3	NHD-H.4	NHS-H.1	NHS-H.2	NHS-S.1	NHS-S.2	NHS-S.3	
type	Reno	Add-Reno	Add-Reno	Add-Reno	Add-Reno	New	New	New	New	New	New	New	New	New	New	
size	Hanlon Only 315	Hanlon Only 315	Hanlon-Deerfield 560	Hanlon Sheehan 685	Hanlon Sheehan 685	Hanlon Only 315	Hanlon Deerfield 560	Hanlon Deerfield 560	Hanlon Deerfield 560	Hanlon Deerfield 560	Hanlon Sheehan 685	Hanlon Sheehan 685	Hanlon Sheehan 685	Hanlon Sheehan 685	Hanlon Sheehan 685	
location	Hanlon	Hanlon	Hanlon	Hanlon	Sheehan	Hanlon	Hanlon	Hanlon	Hanlon	Hanlon	Hanlon	Hanlon	Sheehan	Sheehan	Sheehan	
A Education	1	2	2	4	4	4	5	4	4	5	5	5	4	4	5	
B Site	1	4	4	4	2	5	5	5	5	5	5	5	2	3	3	
C Traffic	2	4	4	2	1	5	4	4	4	4	2	2	1	1	1	
D Community	1	3	3	4	2	5	5	5	5	5	5	5	2	2	2	
E Sustainability	1	3	2	4	4	5	5	5	5	5	5	5	5	5	5	
F Logistics / Construction Impact	1	1	2	2	1	4	4	4	4	4	4	4	2	2	2	





Best	Better	Good	Fair	Poor
------	--------	------	------	------

**Westwood Hanlon Elementary School Evaluation Criteria**

2/10/2020	1	2	3	4	5	6	7	8	9	10	11	12	13	14	15	
	RO-H.1	AR-HO-H.1	AR-HD-H.2	AR-HS-H.3	AR-HS-S.1	NHO-H.1	NHD-H.1	NHD-H.2	NHD-H.3	NHD-H.4	NHS-H.1	NHS-H.2	NHS-S.1	NHS-S.2	NHS-S.3	
type	Reno	Add-Reno	Add-Reno	Add-Reno	Add-Reno	New	New	New	New	New	New	New	New	New	New	
size	Hanlon Only 315	Hanlon Only 315	Hanlon-Deerfield 560	Hanlon Sheehan 685	Hanlon Sheehan 685	Hanlon Only 315	Hanlon Deerfield 560	Hanlon Deerfield 560	Hanlon Deerfield 560	Hanlon Deerfield 560	Hanlon Sheehan 685	Hanlon Sheehan 685	Hanlon Sheehan 685	Hanlon Sheehan 685	Hanlon Sheehan 685	
location	Hanlon	Hanlon	Hanlon	Hanlon	Sheehan	Hanlon	Hanlon	Hanlon	Hanlon	Hanlon	Hanlon	Hanlon	Sheehan	Sheehan	Sheehan	
A	Education	1	2	2	4	4	4	5	4	4	5	5	5	4	4	5
B	Site	1	4	4	4	2	5	5	5	5	5	5	5	2	3	3
C	Traffic	2	4	4	2	1	5	4	4	4	4	2	2	1	1	1
D	Community	1	3	3	4	2	5	5	5	5	5	5	5	2	2	2
E	<b>Sustainability</b>	<b>1</b>	<b>3</b>	<b>3</b>	<b>4</b>	<b>4</b>	<b>5</b>	<b>5</b>	<b>5</b>	<b>5</b>	<b>5</b>	<b>5</b>	<b>5</b>	<b>5</b>	<b>5</b>	<b>5</b>
F	Logistics / Construction Impact	1	1	2	2	1	4	4	4	4	4	4	4	2	2	2

Best	Better	Good	Fair	Poor
------	--------	------	------	------

**Westwood Hanlon Elementary School Evaluation Criteria**

	2/10/2020	1	2	3	4	5	6	7	8	9	10	11	12	13	14	15
	RO-H.1	AR-HO-H.1	AR-HD-H.2	AR-HS-H.3	AR-HS-S.1	NHO-H.1	NHD-H.1	NHD-H.2	NHD-H.3	NHD-H.4	NHS-H.1	NHS-H.2	NHS-S.1	NHS-S.2	NHS-S.3	
type	Reno	Add-Reno	Add-Reno	Add-Reno	Add-Reno	New	New	New	New	New	New	New	New	New	New	
size	Hanlon Only 315	Hanlon Only 315	Hanlon-Deerfield 560	Hanlon Sheehan 685	Hanlon Sheehan 685	Hanlon Only 315	Hanlon Deerfield 560	Hanlon Deerfield 560	Hanlon Deerfield 560	Hanlon Deerfield 560	Hanlon Sheehan 685	Hanlon Sheehan 685	Hanlon Sheehan 685	Hanlon Sheehan 685	Hanlon Sheehan 685	
location	Hanlon	Hanlon	Hanlon	Hanlon	Sheehan	Hanlon	Hanlon	Hanlon	Hanlon	Hanlon	Hanlon	Hanlon	Sheehan	Sheehan	Sheehan	
A	Education	1	2	2	4	4	4	5	4	4	5	5	5	4	4	5
B	Site	1	4	4	4	2	5	5	5	5	5	5	5	2	3	3
C	Traffic	2	4	4	2	1	5	4	4	4	4	2	2	1	1	1
D	Community	1	3	3	4	2	5	5	5	5	5	5	5	2	2	2
E	Sustainability	1	3	3	4	4	5	5	5	5	5	5	5	5	5	5
F	Logistics / Construction Impact	1	1	2	2	1	4	4	4	4	4	4	4	2	2	2



# Westwood Hanlon Elementary School Evaluation Criteria

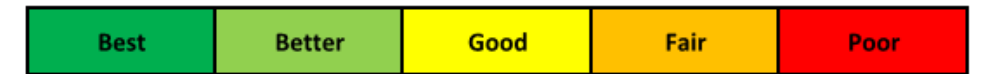

	2/10/2020	1	2	3	4	5	6	7	8	9	10	11	12	13	14	15
	RO-H.1	AR-HO-H.1	AR-HD-H.2	AR-HS-H.3	AR-HS-S.1	NHO-H.1	NHD-H.1	NHD-H.2	NHD-H.3	NHD-H.4	NHS-H.1	NHS-H.2	NHS-S.1	NHS-S.2	NHS-S.3	
type	Reno	Add-Reno	Add-Reno	Add-Reno	Add-Reno	New	New	New	New	New	New	New	New	New	New	
size	Hanlon Only 315	Hanlon Only 315	Hanlon-Deerfield 560	Hanlon Sheehan 685	Hanlon Sheehan 685	Hanlon Only 315	Hanlon Deerfield 560	Hanlon Deerfield 560	Hanlon Deerfield 560	Hanlon Deerfield 560	Hanlon Sheehan 685	Hanlon Sheehan 685	Hanlon Sheehan 685	Hanlon Sheehan 685	Hanlon Sheehan 685	
location	Hanlon	Hanlon	Hanlon	Hanlon	Sheehan	Hanlon	Hanlon	Hanlon	Hanlon	Hanlon	Hanlon	Hanlon	Sheehan	Sheehan	Sheehan	
A Education	1	2	2	4	4	4	5	4	4	5	5	5	4	4	5	
B Site	1	4	4	4	2	5	5	5	5	5	5	5	2	3	3	
C Traffic	2	4	4	2	1	5	4	4	4	4	2	2	1	1	1	
D Community	1	3	3	4	2	5	5	5	5	5	5	5	2	2	2	
E Sustainability	1	3	3	4	4	5	5	5	5	5	5	5	5	5	5	
F Logistics / Construction Impact	1	1	2	2	1	4	4	4	4	4	4	4	2	2	2	

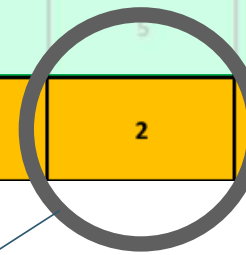
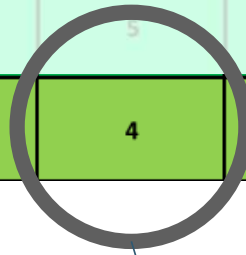
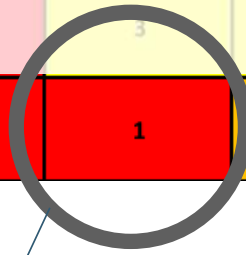

# Westwood Hanlon Elementary School Evaluation Criteria

2/10/2020

1 2 3 4 5 6 7 8 9 10 11 12 13 14 15

	RO-H.1	AR-HO-H.1	AR-HD-H.2	AR-HS-H.3	AR-HS-S.1	NHO-H.1	NHD-H.1	NHD-H.2	NHD-H.3	NHD-H.4	NHS-H.1	NHS-H.2	NHS-S.1	NHS-S.2	NHS-S.3
type	Reno	Add-Reno	Add-Reno	Add-Reno	Add-Reno	New	New	New	New	New	New	New	New	New	New
size	Hanlon Only 315	Hanlon Only 315	Hanlon-Deerfield 560	Hanlon Sheehan 685	Hanlon Sheehan 685	Hanlon Only 315	Hanlon Deerfield 560	Hanlon Deerfield 560	Hanlon Deerfield 560	Hanlon Deerfield 560	Hanlon Sheehan 685	Hanlon Sheehan 685	Hanlon Sheehan 685	Hanlon Sheehan 685	Hanlon Sheehan 685
location	Hanlon	Hanlon	Hanlon	Hanlon	Sheehan	Hanlon	Hanlon	Hanlon	Hanlon	Hanlon	Hanlon	Hanlon	Sheehan	Sheehan	Sheehan
A Education	1	2	2	4	4	4	5	4	4	5	5	5	4	4	5
B Site	1	4	4	4	2	5	5	5	5	5	5	5	2	3	3
C Traffic	2	4	4	2	1	5	4	4	4	4	2	2	1	1	1
D Community	1	3	3	4	2	5	5	5	5	5	5	5	2	2	2
E Sustainability	1	3	3	4	4	5	5	5	5	5	5	5	5	5	5
F Logistics / Construction Impact	1	1	2	2	1	4	4	4	4	4	4	4	2	2	2
G Cost Per SF	791	726	692	700	702	679	652	639	641	651	620	619	623	622	624
	7	17	18	20	14	28	28	27	27	28	26	26	16	17	18



Best	Better	Good	Fair	Poor
------	--------	------	------	------

5 4 3 2 1



Recommended short list



MSBA Requirement



# Cost Comparison, 315 students

■ Baseline Total Project Cost

■ Premium To Achieve NZE

← Reno OR Add/Reno →

← All New Construction →

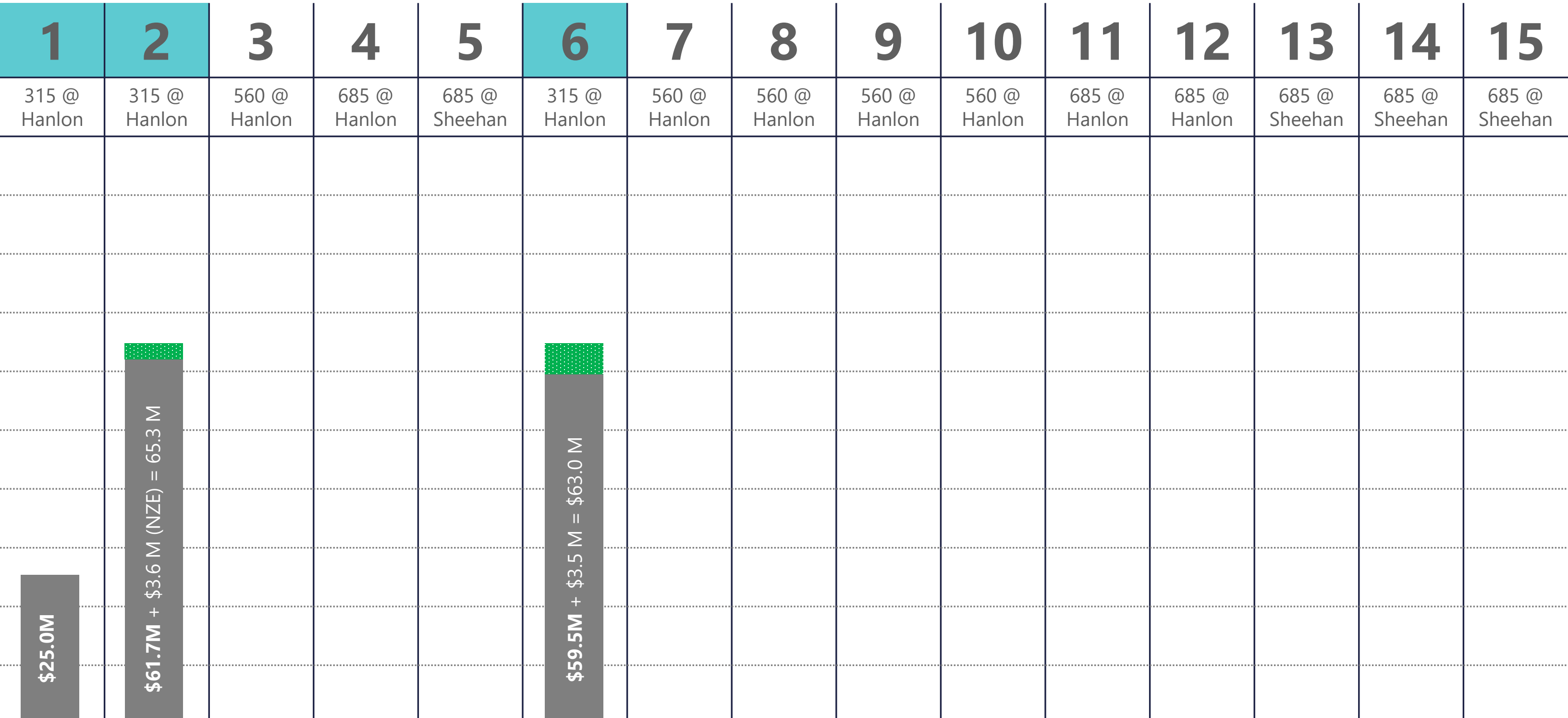

# Cost Comparison, 560 students

■ Baseline Total Project Cost

■ Premium To Achieve NZE

← Reno OR Add/Reno →

← All New Construction →





# Cost Comparison, 685 students

■ Baseline Total Project Cost

■ Premium To Achieve NZE

← Reno OR Add/Reno

All New Construction →

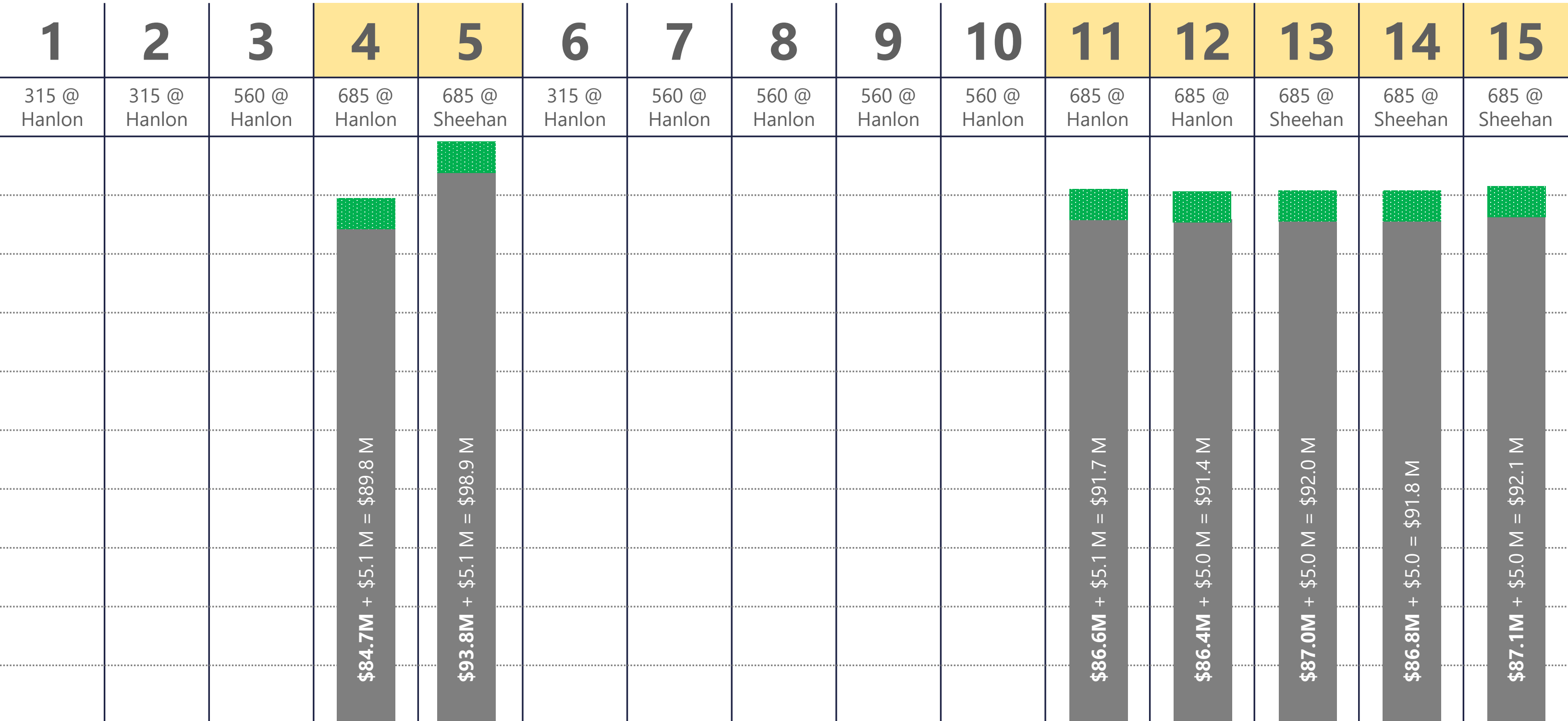

# Options Cost Comparison

■ Baseline Total Project Cost

■ Premium To Achieve NZE

← Reno OR Add/Reno →

← All New Construction →

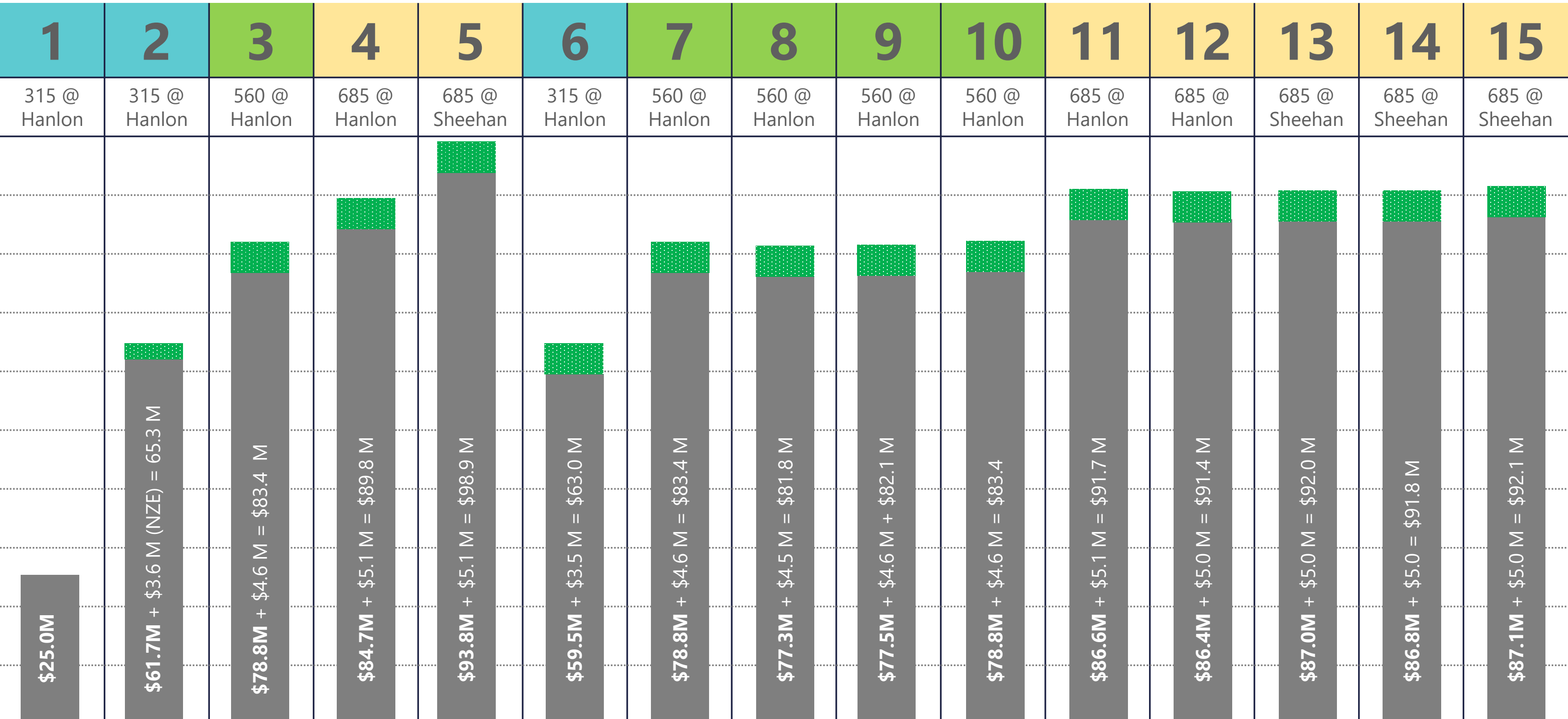



# Recommended Short-Listed Options\*

\* Includes Base Repair, Option #1 - \$25 M

3

All New  
@ Hanlon  
315 Students

\$59.5 M  
(NZE) + 3.5 M  
\$63.0 M



4

Add/Reno  
@ Hanlon  
685 Students

\$84.7 M  
(NZE) + 5.1 M  
\$89.8 M



7

All New  
@ Hanlon  
560 Students

\$78.8 M  
(NZE) + 4.6 M  
\$83.4 M



10

All New  
@ Hanlon  
560 Students

\$78.8 M  
(NZE) + 4.6 M  
\$83.4 M



11

All New  
@ Hanlon  
685 Students

\$86.6 M  
(NZE) + 5.1 M  
\$91.7 M



15

All New  
@ Sheehan  
685 Students

\$87.1 M  
(NZE) + 5.0 M  
\$92.1 M



# Questions & Comments



# Next Steps

- March 20<sup>th</sup>: SBC vote - Short List of Options and Submission to MSBA
- April- June: Prepare Preferred Schematic Report

Evaluate the Few and Identify the Preferred Option

Consider Redistricting Impact

Consider Nuanced Design Differences

Consider impact to building left out

Consider more nuanced cost estimates

# Next Steps

- March 20<sup>th</sup>: SBC vote - Short List of Options and Submission to MSBA
- April 7th: School Committee Mtg – Redistricting
- April 17th: School Building Committee – Review Selection Criteria
- April 30th: Community Presentation: Redistricting
- May 29th: School Building Committee – Review Recommended Option with Cost
- June 4th: Community Presentation: Preferred Option with Cost
- June 11th: School Committee: Enrollment/Redistricting Vote
- June 12: School Building Committee: Preferred Option Vote

Thank You

